

Eleventh Annual
Mississippi Child Welfare Institute Conference
February 13-15, 2013

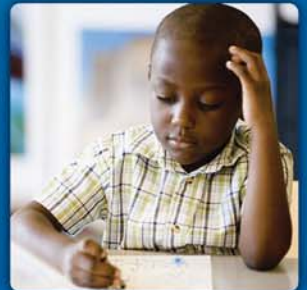
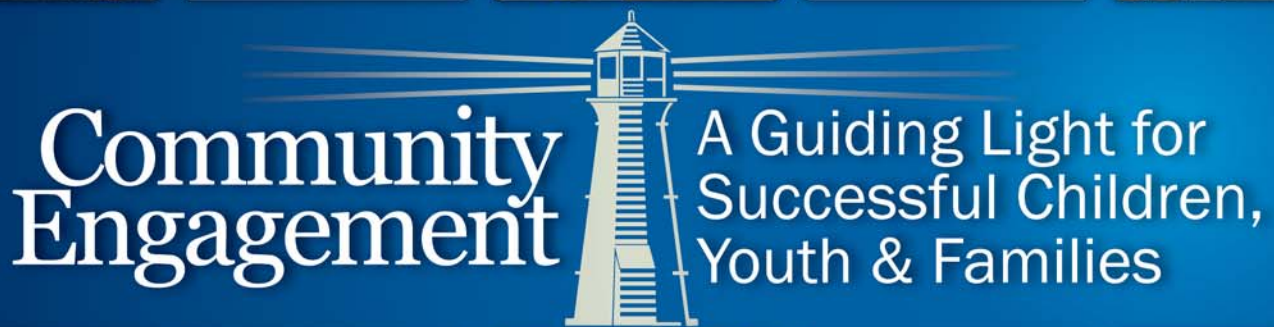

Jackson Marriott Hotel
200 East Amite Street
Jackson, Mississippi 39201

ELEVENTH ANNUAL
MISSISSIPPI CHILD WELFARE INSTITUTE CONFERENCE

*“Community Engagement: A Guiding Light for Successful Children,
Youth and Families”*

Sponsored by
School of Social Work
College of Public Service
Mississippi Child Welfare Institute

~~~~~  
**Co-Sponsors**

*Gold*  
**Mississippi Department of Human Services**  
**Children’s Trust Fund**

*Silver*  
**Mississippi Department of Human Services**  
*Division of Family and Children’s Services*

*Bronze*  
**Mississippi Department of Mental Health**  
*Division of Children and Youth Services*

*Copper*  
**Another Chance**  
**Catholic Charities**  
**Jackson Medical Mall Foundation**  
**Mississippi Counseling Center**  
**Mississippi State Department of Health**  
*Office of Child and Adolescent Health*  
**Mississippi State Department of Health**  
*Office of Preventive Health*

The 2013 Mississippi Child Welfare Institute Conference offers a maximum of 11  
Continuing Education Hours (CEHs).

**BENNIE G. THOMPSON**  
SECOND DISTRICT, MISSISSIPPI

COMMITTEE ON  
HOMELAND SECURITY  
RANKING MEMBER

WASHINGTON OFFICE:  
2466 RAYBURN HOUSE OFFICE BUILDING  
WASHINGTON, DC 20515-2402  
(202) 225-5876  
(202) 225-5898: FAX  
E-Mail: benniethompson@mail.house.gov  
Home Page: <http://www.benniethompson.house.gov>

**Congress of the United States**  
**House of Representatives**  
**Washington, DC 20515-2402**

CONGRESSIONAL BLACK CAUCUS  
CONGRESSIONAL GAMING CAUCUS  
CONGRESSIONAL PROGRESSIVE CAUCUS  
CONGRESSIONAL SPORTSMEN’S CAUCUS  
CONGRESSIONAL RURAL CAUCUS  
HOUSE EDUCATION CAUCUS

February 13, 2013

Jackson State University  
College of Public Service  
School of Social Work  
3825 Ridgewood Road, ILH-103  
Jackson, MS 39211

Dear Friends:

It gives me great pleasure to bring you greetings from Mississippi’s Second Congressional District during your Eleventh Annual Mississippi Child Welfare Institute Conference. I salute the School of Social Work for the work you are doing in raising awareness about child welfare issues.

I am honored to play a small part in this year’s conference as you encourage and advocate community engagement. This year’s theme, Community Engagement: a Guiding Light for Successful Children, Youth, and Families reflects the commitment that is necessary on the part of the entire community in order to build alliances and generate public policy that will benefit all of our children and families. It is clear that our mission must be one of advocacy, good public policy and community involvement to keep our families strong.

I applaud your dedication and commitment in keeping the welfare of children and families at the forefront of the public debate and setting sound public policy. Please know that you are making a difference in dispensing good information and creating necessary dialogue through your yearly conferences. I am confident that you will renew and rededicate yourself to this ongoing fight to keep our children, families and communities safe and healthy.

You have my best wishes for a successful and engaging conference this year. **Keep the Faith!**

Sincerely,

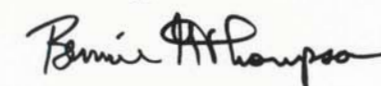

Bennie G. Thompson  
Member of Congress

|                                                                                                                                                         |                                                                                                              |                                                                                                               |                                                                                                                    |                                                                                                                           |                                                                                                                                                                 |
|---------------------------------------------------------------------------------------------------------------------------------------------------------|--------------------------------------------------------------------------------------------------------------|---------------------------------------------------------------------------------------------------------------|--------------------------------------------------------------------------------------------------------------------|---------------------------------------------------------------------------------------------------------------------------|-----------------------------------------------------------------------------------------------------------------------------------------------------------------|
| <input type="checkbox"/> 107 WEST MADISON STREET<br>P.O. Box 610<br>BOLTON, MS 39041<br>(601) 866-9003<br>(601) 866-9036: FAX<br>(800) 355-9003: IN ST. | <input type="checkbox"/> 509 HIGHWAY 82 WEST<br>GREENWOOD, MS 38930<br>(662) 455-9003<br>(662) 453-0118: FAX | <input type="checkbox"/> 910 COURTHOUSE LANE<br>GREENVILLE, MS 38701<br>(662) 335-9003<br>(662) 334-1304: FAX | <input type="checkbox"/> 3607 MEDGAR EVERS BOULEVARD<br>JACKSON, MS 39213<br>(601) 946-9003<br>(601) 982-5337: FAX | <input type="checkbox"/> 263 EAST MAIN STREET<br>P.O. Box 356<br>MARKS, MS 38646<br>(662) 326-9003<br>(662) 326-9003: FAX | <input type="checkbox"/> MOUND BAYOU CITY HALL<br>P.O. Box 679<br>106 GREEN AVENUE, SUITE 106<br>MOUND BAYOU, MS 38762<br>(662) 741-9003<br>(662) 741-9002: FAX |
|---------------------------------------------------------------------------------------------------------------------------------------------------------|--------------------------------------------------------------------------------------------------------------|---------------------------------------------------------------------------------------------------------------|--------------------------------------------------------------------------------------------------------------------|---------------------------------------------------------------------------------------------------------------------------|-----------------------------------------------------------------------------------------------------------------------------------------------------------------|





PHIL BRYANT  
GOVERNOR

February 5, 2013

Dear Friends:

As Governor of the State of Mississippi, I am pleased to welcome you to the Eleventh Annual Mississippi Child Welfare Institute Conference hosted by The School of Social Work – College of Public Service at Jackson State University.

The work done by this conference is very much appreciated. We especially recognize the theme for this year's event, "Community Engagement: A Guiding Light for Successful Children, Youth and Families." Mississippi is proud of leaders, like you, that are working to make a difference in the State of Mississippi and improve the quality of life for our children.

Many thanks are also due to the host and organizers. I applaud their efforts to put on this outstanding conference.

Again, welcome to the Mississippi Child Welfare Institute Conference and best wishes for many more to come.

Sincerely,

Phil Bryant  
Governor



Office of the Mayor  
Harvey Johnson Jr. Mayor

219 South President Street  
Post Office Box 17  
Jackson, Mississippi 39205-0017  
Telephone: 601-960-1084  
Facsimile: 601-960-2193

Greetings:

On behalf of the citizens of Jackson, I welcome you to the Jackson State University School of Social Work's 11<sup>th</sup> Annual Mississippi Child Welfare Institute Conference.

Strong families are the fabric of any city, and as Mayor, I am proud that this conference focuses on building community partnerships for safe and healthy children and families. I also commend the social work professionals who dedicate their lives to helping others. Without you, many children and families would not have the quality of life that they now enjoy.

I know that you will gain a lot of valuable information during this conference, and I trust that everyone will have a great time. For those of you visiting, I trust that you will find Jackson to be very hospitable and accommodating, and I encourage you to get out and take advantage of some of the fabulous shopping, dining and sightseeing opportunities available in our City.

Sincerely,

Harvey Johnson, Jr.





## JACKSON STATE UNIVERSITY

JACKSON, MISSISSIPPI 39217

OFFICE OF  
THE PRESIDENT

(601) 979-2323  
FAX NO. (601) 979-2948



February 15, 2013

Dear Conference Participants:

It gives me tremendous pleasure to welcome you to Jackson State University and its Eleventh Annual Mississippi Child Welfare Institute Conference sponsored by the School of Social Work, College of Public Service. The theme for this year, "*Community Engagement: A Guiding Light for Successful Children, Youth and Families*," is certainly appropriate as Jackson State University continues to expand and enhance its educational, research, and service initiatives with local and state community partners as well as other national and international collaborators.

The plenary speakers and other presenters will cover an array of theme-related topics that will provide you an opportunity to engage in meaningful discussion, share important knowledge and skills, and network to improve the lives of vulnerable children, youth, and families. I encourage you to participate fully in these activities.

I extend my gratitude to the conference committee members and volunteers who have expended much time and effort to ensure that you will have a rewarding learning experience. If we can assist you in any way during the conference, please do not hesitate to let us know.

Sincerely,

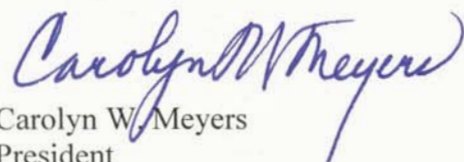
  
Carolyn W. Meyers  
President



February 13, 2013

Dear Conference Participants:

On behalf of the Division of Academic Affairs at Jackson State University, we are pleased that you have chosen to join our faculty, students, and community partners to pursue the all important agenda of improving the lives of vulnerable children and families in your local community, the state of Mississippi, our country, and the world.

The 11th Annual Mississippi Child Welfare Institute Conference marks the beginning of a second decade of faculty, student, and staff development focusing on research, practice, and policy initiatives. This year's theme, "*Community Engagement: A Guiding Light for Successful Children, Youth and Families*," underscores a collective commitment to support families and communities in their efforts to ensure a successful journey through childhood and adolescence for our youth.

The caliber of the plenary and workshop presenters for this year's conference is exceptional, and you will have an opportunity to be involved in discussions on a wide range of topics related to community engagement in advancing our work. As a fellow professional social worker, I greatly admire and deeply appreciate your dedication to provide quality services for vulnerable children, youth, and families. I encourage you to engage fully in the sessions and networking opportunities.

The conference committee chair, co-chairs, committee members, community and other partners, and the many volunteers who worked to ensure that the conference is successful are to be commended. They have done an excellent job in planning and organizing the conference. Please continue your work with us and in your respective neighborhoods to create communities of care and action toward improving the well-being of all children, youth, and families.

Sincerely,

  
James C. Renick, Ph.D.  
Interim Provost and Vice President



Dear Conference Participants:

On behalf of the faculty, staff, and students in the College of Public Service, I am pleased to welcome you to the Eleventh Annual Mississippi Child Welfare Institute Conference sponsored by the School of Social Work. The conference provides an opportunity for a cadre of local, state, and nationally recognized social workers, community partners, faculty, staff, and students to share their knowledge of practice, research, and policy initiatives on behalf of our families and the youth, especially in times of economic hardships as is the case now.

I wish to commend particularly Dr. Gwendolyn S. Prater, our Founding Dean Emerita, College of Public Service, for leading the conference over the many years now, and her Committee for its dedication and effort in organizing this momentous event for our State, the region, and the nation. I hope this gathering will allow each one of us to serve as a "guiding light" and engage in our professional activities in a manner that enhances the well-being of all children and families and thus make a difference in the communities where we live. Please enjoy your stay with us. We look forward to seeing you next year.

Sincerely,

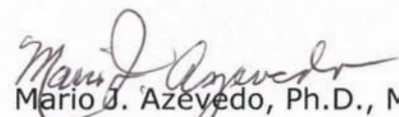

Mario J. Azevedo, Ph.D., M.P.H.  
Interim Dean



Dear Conference Participants:

On behalf of our faculty, staff and students, I welcome you to the Eleventh Annual Mississippi Child Welfare Institute Conference. The theme for this year's conference, "*Community Engagement: A Guiding Light for Successful Children, Youth and Families*," fully captures the importance of our collective focus on the welfare of children, youth and families.

The conference offers several theme-focused presentations in the areas of research, teaching, practice, policy and advocacy. I think you will find them quite informative and useful in your professional positions as you assist in *making a difference* in the lives of children, youth and families in Mississippi, the nation and the world.

I extend my appreciation to the members of Conference Planning Committee for working so diligently to ensure the success of the conference. I also thank the presenters who prepared papers and other presentations.

Please let us know if you desire our assistance during the conference.

Sincerely,

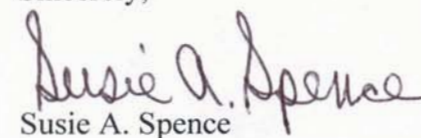

Susie A. Spence  
Interim Executive Director



# MISSISSIPPI CHILD WELFARE INSTITUTE

JACKSON STATE UNIVERSITY • COLLEGE OF PUBLIC SERVICE • SCHOOL OF SOCIAL WORK  
350 West Woodrow Wilson Drive, Suite 2900B • JACKSON, MISSISSIPPI 39213-7681  
Telephone (601) 979-1123 • Fax (601) 979-1161

February 13, 2013

Dear Conference Participants:

It is indeed my pleasure to welcome you to the Eleventh Annual Mississippi Child Welfare Institute Conference! As we embark upon our second decade of education and training, and learn more about translational research, we do so for the purposes of improving service delivery and advancing policy for children, youth, and families. The conference provides content from experts in the field and also engaging network opportunities for all participants. I invite you to continue the journey with us to make a positive difference in the lives of vulnerable children, youth and families in the State of Mississippi and across the United States and global community.

The Mississippi Child Welfare Institute Conference Planning Committee has diligently pursued and successfully selected invited plenary and juried workshop and paper presentations that are designed to ensure your involvement in best and promising practices. The activities of the Committee have guaranteed that you have the opportunity to use research and evidence-based practice to inform your work. The theme this year, *"Community Engagement: A Guiding Light for Successful Children, Youth and Families,"* sets the stage for our ongoing collaboration to promote the safety, health, well-being, and success of our children, youth, and families with the committed support of a caring community. I applaud you, the social workers and other professionals, who take the time and make the effort to expand your knowledge, advance your professional values and ethics, and enhance your skills to engage our community and best serve our children, youth, and families.

Sincerely,

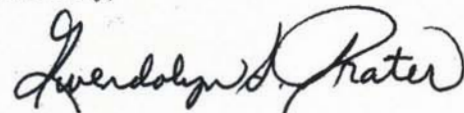

Gwendolyn Spencer Prater, Ph.D.  
Dean Emerita and Consultant



## MISSISSIPPI CHILD WELFARE INSTITUTE AND CONFERENCE HISTORY

The Mississippi Child Welfare Institute was established at Jackson State University in 2003 as a part of the School of Social Work. The impetus to begin the Institute emanated from a grant awarded by the Children's Bureau, U.S. Department of Health and Human Services during the 2000 to 2004 period. The proposal was developed by Gwendolyn Spencer Prater, PhD, MSW, who was then Dean of the School of Social Work. The Institute and conference began prior to the organization of the academic colleges at Jackson State University.

The proposal submitted to the Children's Bureau resulted in a funded grant which permitted 26 committee-selected and dedicated students to participate in the education project. All of the social work students were provided tuition, stipends, and special training and educational opportunities both in-state and across the country at national conferences with the goal of preparing them for careers in child welfare. The students graduated and many attained social work positions in the field of child welfare. Mrs. Wanda Gilliam, MSW, Deputy Director of Programs, Mississippi Department of Human Services, was the liaison with the School of Social Work during the grant period and actively and successfully facilitated productive experiential educational opportunities for students with the Division of Family and Children's Services.

During the 2002-2003 academic year, Jackson State University's School of Social Work, in partnership with other state institutions of higher learning, and the Mississippi State Department of Human Services, under the capable leadership of Mrs. Thelma Brittain, MSW, initiated the Title IV-E Program in Child Welfare. The program was readily supported by the Mississippi Legislature, with strong leadership from the late Representative Charlie Capp, Chair of the House Appropriations Committee. Jackson State University's administration also provided strong support for the Institute and the conference. The School of Social Work programmatic and administrative leadership team included Drs. Prater and Ruth M. Williams as the Principal Investigator and Co-Principal Investigator, respectively, and Ms. Velma Hankins, MSW, as the Program Administrator.

The program continued for approximately three and one-half years, with Jackson State University serving as the lead institution for the majority of that period, with the final program year being rotated to one of the other state institutions of higher education. Numerous students at the baccalaureate and master's levels were educated and provided training for child welfare practice with vulnerable populations. In addition, during that three-year period, training was also developed and provided for foster and adoptive parents and public child welfare staff. Since that time, there has not been a consortium of state schools and programs of social work jointly engaged in Title IV-E academic programming with the Mississippi Department of Human Services.

The Mississippi Child Welfare Institute at Jackson State University, however, continues to offer its annual conference for professional development of child welfare practitioners, supervisors, administrators, faculty, and students in Mississippi, other states in the Southeastern Region, and indeed across the United States of America. The Institute partners with public and private agencies and organizations as it works to improve services to children and families including but not limited to: the Mississippi State Departments of Human Services, Health, and Mental Health, the Children’s Defense Fund (Southern Regional Office), Mississippi Children’s Home Services and CARES Center, Catholic Charities, and the Casey Family Programs and Marguerite Casey Foundations.

Conferences (2003-2013):

*2003: Social Workers’ Challenge: Changing the Lives of Mississippi’s Children and Families\**

*2004: Mississippi’s Challenge: Rebuilding the Village*

*2005: Social Work: Empowering Mississippi's Children and Families through Public Service^*

*2006: Working Together for What Matters Most: Children and Families*

*2007: United Voices Committed to Helping Our Children*

*2008: The Many Faces of Child Welfare: A Rainbow of Diversity*

*2009: Child Poverty: Facing the Challenges, Creating Opportunities*

*2010: Child Welfare: Building Community Partnerships for Safe and Healthy Children and Families*

*2011: Building Community Partnerships for Safe and Healthy Children and Families*

*2012: Building Bridges for a New Decade of Transformational Services with Children and Families*

*2013: Community Engagement: A Guiding Light to Successful Children, Youth and Families.*

*Note: All conferences have been held in Downtown Jackson;  
\*Crowne Plaza Hotel (2003-2004)  
^Jackson Marriott Hotel (2005-2013)*

**OPENING PLENARY SPEAKER**



**Johnnetta McSwain-Clay**, MSW, is a doctoral candidate in the social work program in the Whitney M. Young, Jr. School of Social Work at Clark-Atlanta University in Atlanta, Georgia. Ms. McSwain-Clay is an EMMY Award Winning documentarian, author of *Rising Above the Scars*, a life development coach, and empowerment speaker. Johnnetta also founded Dreamwright Publications and Breaking the Cycle: Beating the Odds, an organization that helps women to become self-aware of their negative, self-destructive behavioral cycles.

Born to an alcoholic mother and an absent father, the odds were stacked against Ms. McSwain-Clay. By the age of five, she was viciously raped and incessantly battered by her three uncles. At age 12, Johnnetta began shoplifting which led to the beginning of criminal system troubles and bouts with drugs. After reflecting on her life, Johnnetta relocated to Georgia with a GED and a dream to be the first in her family to earn a terminal degree. Three years after beginning college at Kennesaw State University, she received her bachelor’s degree. Two years later she earned her master’s in social work at Clark Atlanta University.

**CLOSING LUNCHEON SPEAKER**



**Alberta Ellett**, PhD, is an associate professor at the University of Georgia, School of Social Work. Dr. Ellett is nationally known as a leader in several professional organizations through her contributions in promoting the continued professionalization of child welfare. Dr. Ellett has served as the principal investigator of several research/evaluation and instructional grants and contracts. Her research interests and specializations center on developing child welfare organizations and strengthening their holding power in ways that retain and promote the development of competent child welfare staff. Dr. Ellett’s scholarly child welfare publications include refereed journal articles, book chapters, book reviews, and several reports. She has presented numerous evaluation and research papers at national child welfare and social work conferences and professional meetings. Dr. Ellett was Co-Editor of the *Journal of Public Child Welfare* (2004-2010) and was selected Editor-in-Chief in 2011, a position she currently holds.

Dr. Ellett earned her PhD in Social Work with a minor in Industrial and Organizational Psychology from Louisiana State University. She has over 25 years of direct practice and administrative experience in child welfare in Georgia and Louisiana.



## PLENARY SPEAKERS



**William Buster** is the Director of Mississippi and New Orleans Programming at the W.K. Kellogg Foundation in Battle Creek, Michigan. He has over 12 years experience in philanthropy supporting and developing community advocacy, cross-community and cross-organization collaboration, and economic development efforts. He also has extensive experience in supporting organizational development for nonprofits. Prior to joining the foundation, Mr. Buster was a program officer at the Mary Reynolds Babcock Foundation of Winston-Salem, North Carolina. Mr. Buster has received several awards and recognitions for his work, including selection as a Hull Fellow by the Southeastern Council on Foundations of Atlanta, Georgia. He has the distinction of being a founding member of the Black Family Land Trust whose purpose is to help African-American families in the southeastern United States find creative ways to save family land in rural and urban settings.

Mr. Buster holds a baccalaureate degree in history from North Carolina Agricultural & Technical University, Greensboro. He is completing a master's degree in Development Policy and Practice from the University of New Hampshire. He also has completed the JFK School of Government's Executive Leadership Training Program at Harvard University.



**Dominic Carter** is the author of *No Momma's Boy*, an autobiography that depicts his triumph over insurmountable odds and rising to the top, and a political commentator at RNN-TV News in Rye Brook, New York. For over seven years, he served as a senior political anchor at New York 1 (NY1) News in New York, New York. During his tenure at NY1, he launched the highly acclaimed political show, "Inside City Hall" in 1992. Mr. Carter has interviewed the likes of former President Bill Clinton, Nelson Mandela, Donald Trump, and a number of other esteemed political individuals. As a victim of childhood sexual abuse, his life story has been told in Oprah Winfrey's magazine and on the Nancy Grace Show. His awards include the Samuel P. Peabody Award for his vision, innovation and dedication to children and families.

Mr. Carter earned his undergraduate degree in journalism at the State University of New York at Cortland in Cortland, New York and attended graduate school at Syracuse University, Syracuse, New York.

## PLENARY SPEAKERS



**Lisa McGill**, PhD, is the Site Liaison to Mississippi for the Jim Casey Youth Opportunities Initiative. She also serves as the Director of the Youth Transition Funders Group, a national network of funders dedicated to ensuring the successful transitions of young people between the ages of 14 and 24 to adulthood. She has contributed to several publications in the philanthropic sector and also author of *Constructing Black Selves: Caribbean American Narratives and the Second Generation* (New York University Press, 2005). Over the years, Dr. McGill has worked with several foundations and funders' networks to help them advance relationships and sustain impact in under-resourced communities. She has worked on projects for community foundations, as well as national foundations such as the W.K. Kellogg Foundation, Charles Stewart Mott Foundation, and Robert Wood Johnson Foundation. Dr. McGill has also provided consulting services to philanthropic affinity groups such as Grantmakers for Education, the Association of Black Foundation Executives, and CFLeads.

Before consulting, Dr. McGill worked as a program officer in a community foundation and as a coordinator of community outreach and events programming. She received her doctorate in American Studies at Yale University. Her undergraduate degree, in English modified with Latin American and Caribbean Studies, is from Dartmouth College.



**Virginia Pryor**, MSW, is the Director of Strategic Consulting with Casey Family Programs in Seattle, Washington. She has over 20 years of experience in child welfare and social policy. Ms. Pryor continues to advocate for and improve the child welfare system through her leadership and commitment to children and families in her work with Casey Family Programs. She was responsible for the implementation of Family Group Conferencing throughout the Casey Field Offices and served as a Chair of National Foster Care Month, an awareness campaign that highlights the needs of young people in foster care and encourages citizens to step forward to improve outcomes for youth in care.

Ms. Pryor is a member of Casey Family Programs "Casey Leadership Institute" a program sponsored and managed by Casey Family Programs' Executive Team that provides key leaders with an opportunity to challenge and strengthen leadership and helps prepare them for more advanced leadership roles at Casey. She also serves as a member of the Board of Trustees and served as past president of the Board of Black Administrators in Child Welfare.



FIELD EDUCATION SYMPOSIUM SPEAKERS



**Roktabija Abdul-Azeez** is the State Program Director for the Corporation for National and Community Service. In this position, he oversees the operation of Senior Corps, including the Foster Grandparent Program, the Retired and Senior Volunteer Program, and the Senior Companion Program and AmeriCorps Volunteers In Service To America (VISTA). Mr. Abdul-Azeez completed 38 years of federal service in June 2012 and continues to serve. After completing college at the University of Pittsburgh, he joined the Peace Corps where he served as a Peace Corps Volunteer in Costa Rica, Central America from 1975 - 1978.

---



**Dorothy McGill**, PhD, has over 25 years of upwardly mobile experience as a mental health practitioner and manager. Dr. McGill understands both the clinical side of mental health and the fiscal realities. She is a counselor and a business woman, a clinician and a CEO of Innovative Behavioral Services, Inc. Dr. McGill’s significant experience includes, but is not limited to, health education and management, fiscal and programmatic management and review of grants, curriculum planning and development, counseling and training, personnel management, alcohol and substance abuse prevention and treatment, budget preparation and monitoring, proposal writing and governmental agency program management, nonprofit management and fundraising.

Dr. McGill earned her PhD in Healthcare Administration from Kennedy Western University, an MBA from Jackson State University, and BS in Criminal Justice, with an emphasis in juvenile counseling, from the University of Southern Mississippi.

---



**Bernice McKenny**, LMSW, is the Director of Mississippi Counseling Center and an adjunct instructor in the School of Social Work at Jackson State University. She is also a member of Alpha Epsilon Lambda Graduate Honor Society and Alpha Kappa Chapter of Phi Alpha Social Work Honor Society. In 2007, she traveled to Nairobi, Kenya, where she completed an independent study and comparison of the Child Welfare Systems in Kenya, East Africa and the United States of America.

Mrs. McKenny is a proud and active member of Emmanuel Missionary Baptist Church. She is a member of the Sanctuary Choir, a teacher of Christian Education, a member of the Mother’s Ministry, and Director of Emmanuel Social Services.

FIELD EDUCATION SYMPOSIUM SPEAKERS



**Gwen Moore** is a community services supervisor for the City of Jackson’s Department of Human and Cultural Services. With more than 30 years of experience, she has worked to develop and implement services and programs that positively influence the lives of senior adults. Ms. Moore has worked at numerous social, educational, and public and private entities to help ensure the continuation of vital resources, services, and information that will enhance the lives of senior adults in the Jackson metropolitan area.

Ms. Moore received her Master’s in Guidance and Counseling at Jackson State University.

---

SPECIAL YOUTH EMPOWERMENT SESSION



**Willie McKennis** is an Accounting Auditor III with the Office of Insurance – Mississippi Department of Finance and Administration. He is also the author of the internationally published book *Valley Low/Mountain High and Can I Really be Stress Free?*

While growing up he led an appalling and horrific life that was plagued by gangs, drugs and violence. He finally decided to make a lifestyle change. Mr. McKennis received a certificate of completion from

Rhema Correspondence Bible School for Life in Prayer and is a graduate of the Word of Life Bible Training Center. He received his Associate Degree in Business/Microcomputer Technology at Hinds Community College and BS in Business Management from the University of Phoenix.

ELEVENTH ANNUAL  
MISSISSIPPI CHILD WELFARE INSTITUTE CONFERENCE

*“Community Engagement: A Guiding Light for Successful Children,  
Youth and Families”*

| Conference Overview          |                                   |
|------------------------------|-----------------------------------|
| Wednesday, February 13, 2013 |                                   |
| 5:30 p.m.–6:30 p.m.          | Special Youth Empowerment Session |
| Thursday, February 14, 2013  |                                   |
| 7:00 a.m.–8:30 a.m.          | Registration                      |
| 8:30 a.m.–9:45 a.m.          | Opening Plenary Session           |
| 9:45 a.m.–10:00 a.m.         | Break                             |
| 10:00 a.m.–11:30 a.m.        | Concurrent Sessions               |
| 11:30 a.m.–1:00 p.m.         | Lunch on Your Own                 |
| 1:00 p.m.–2:00 p.m.          | Concurrent Sessions               |
| 2:05 p.m.–3:05 p.m.          | Concurrent Sessions               |
| 3:05 p.m.–3:20 p.m.          | Break                             |
| 3:20 p.m.–4:20 p.m.          | Concurrent Sessions               |
| 4:30 p.m.–5:30 p.m.          | Plenary Session                   |
| Friday, February 15, 2013    |                                   |
| 8:20 a.m.–9:15 a.m.          | Plenary Session                   |
| 9:20 a.m.–10:20 a.m.         | Concurrent Sessions               |
| 10:25 a.m.–10:40 a.m.        | Break                             |
| 10:45 a.m.–12:00 noon        | Concurrent Workshops              |
| 12:15 p.m.–1:45 p.m.         | Closing Luncheon                  |

| ELEVENTH ANNUAL<br>MISSISSIPPI CHILD WELFARE INSTITUTE CONFERENCE                              |                                                                                                                                                                        |
|------------------------------------------------------------------------------------------------|------------------------------------------------------------------------------------------------------------------------------------------------------------------------|
| <i>“Community Engagement: A Guiding Light for Successful Children,<br/>Youth and Families”</i> |                                                                                                                                                                        |
| Wednesday, February 13, 2013                                                                   |                                                                                                                                                                        |
| SPECIAL YOUTH EMPOWERMENT SESSION                                                              |                                                                                                                                                                        |
| Location:                                                                                      | Windsor III, IV & V<br>5:30 p.m. - 6:30 p.m.                                                                                                                           |
| Presider                                                                                       | Mario Johnson, Director<br>Independent Living - Resource Unit<br>Division of Family and Children’s Services<br>Mississippi Department of Human Services<br>Jackson, MS |
| Welcome                                                                                        | Devon Wilson                                                                                                                                                           |
| Speaker                                                                                        | A Thrill of Hope<br><br>Willie McKennis<br>Accounting Auditor III<br>Office of Insurance<br>Mississippi Department of Finance and<br>Administration<br>Jackson, MS     |
| Closing Remarks                                                                                | Gwendolyn Spencer Prater, Ph.D.                                                                                                                                        |
|                                                                                                | Youth Reception<br>6:30 p.m. - 7:00 p.m.                                                                                                                               |



ELEVENTH ANNUAL  
MISSISSIPPI CHILD WELFARE INSTITUTE CONFERENCE

“Community Engagement: A Guiding Light for Successful Children,  
Youth and Families”

Thursday, February 14, 2013

Conference Registration  
7:00 a.m. - 5:30 p.m.

Exhibits  
8:00 a.m. - 5:30 p.m.

OPENING PLENARY SESSION  
Location: Windsor III, IV & V  
8:30 a.m. - 9:45 a.m.

|                               |                                                                                                                                                                                                                                                          |
|-------------------------------|----------------------------------------------------------------------------------------------------------------------------------------------------------------------------------------------------------------------------------------------------------|
| Presider                      | <b>Susie A. Spence</b> , PhD<br>Interim Executive Director and Professor<br>Director, Ph.D. Program<br>School of Social Work<br>College of Public Service<br>Jackson State University                                                                    |
| Greetings                     | <b>Dr. Carolyn W. Meyers</b><br>President<br>Jackson State University<br><br><b>Mario Azevedo</b> , PhD<br>Interim Dean<br>College of Public Service<br>Jackson State University<br><br><b>Honorable Harvey Johnson</b><br>Mayor<br>City of Jackson      |
| Introduction of Guest Speaker | Tasha Smith, MA<br>Division Director II – Prevention Unit<br>Division of Family and Children’s Services<br>Mississippi Department of Human Services<br>and Social Work Doctoral Student<br>Jackson State University<br><br><b>Rising Above the Scars</b> |
| Speaker                       | <b>Johnnetta McSwain-Clay</b> , MSW<br>Doctoral Candidate<br>Whitney M. Young Jr. School of Social Work<br>Clark-Atlanta University<br>Atlanta, GA                                                                                                       |

ELEVENTH ANNUAL  
MISSISSIPPI CHILD WELFARE INSTITUTE CONFERENCE

“Community Engagement: A Guiding Light for Successful Children,  
Youth and Families”

Thursday, February 14, 2013

OPENING PLENARY SESSION (Continued)

|                                |                                                                                                                                                                                                                                                                                                                                                                                                                                                                                                                                                                                                                                                                                                                                                                                                                                                                                                                                                                                                                                                                                |
|--------------------------------|--------------------------------------------------------------------------------------------------------------------------------------------------------------------------------------------------------------------------------------------------------------------------------------------------------------------------------------------------------------------------------------------------------------------------------------------------------------------------------------------------------------------------------------------------------------------------------------------------------------------------------------------------------------------------------------------------------------------------------------------------------------------------------------------------------------------------------------------------------------------------------------------------------------------------------------------------------------------------------------------------------------------------------------------------------------------------------|
| Remarks                        | <b>Susie A. Spence</b> , PhD                                                                                                                                                                                                                                                                                                                                                                                                                                                                                                                                                                                                                                                                                                                                                                                                                                                                                                                                                                                                                                                   |
| Presentation                   | <b>Gwendolyn Spencer Prater</b> , PhD                                                                                                                                                                                                                                                                                                                                                                                                                                                                                                                                                                                                                                                                                                                                                                                                                                                                                                                                                                                                                                          |
| <b>9:45 a.m. – 10:00 a.m.</b>  | <b>BREAK</b>                                                                                                                                                                                                                                                                                                                                                                                                                                                                                                                                                                                                                                                                                                                                                                                                                                                                                                                                                                                                                                                                   |
| <b>10:00 a.m. – 11:30 a.m.</b> | <b>CONCURRENT SESSIONS</b>                                                                                                                                                                                                                                                                                                                                                                                                                                                                                                                                                                                                                                                                                                                                                                                                                                                                                                                                                                                                                                                     |
| Session I                      | <b>Technology and Families: Protecting Youth in the Digital Age</b><br><br><b>Room: Surrey Ballroom</b><br>Technology when used appropriately has many benefits to society as a whole. The presenters will discuss negative and positive influences of technology on children, youth and families. Prevention and intervention strategies will also be shared to protect this vulnerable population.<br><br><i>Presenters:</i> <i>Ronica Arnold Branson, PhD, LPC</i><br>Associate Professor<br>School, Community and Rehabilitation Counseling<br>College of Education and Human Development<br>Jackson State University<br><br><i>Ayanna Gill-McGee, PhD, NCC, NCSC</i><br>Assistant Professor<br>Coordinator School Counseling Program<br>Alcorn State University<br><br><i>Lakitta Johnson, PhD, LPC, NCC, ACS</i><br>Assistant Professor<br>School, Community and Rehabilitation Counseling<br>College of Education and Human Development<br>Jackson State University<br><br><i>Moderator:</i> <i>Eva Bowie Ellis, MSW, LCSW</i><br>Social Work Consultant<br>Jackson, MS |

ELEVENTH ANNUAL  
MISSISSIPPI CHILD WELFARE INSTITUTE CONFERENCE

“Community Engagement: A Guiding Light for Successful Children,  
Youth and Families”

Thursday, February 14, 2013

10:00 a.m. – 11:30 a.m.

CONCURRENT SESSIONS

Session II  
Ethics  
Diversity

**Culturally Sensitive Practice in Child Welfare: Fulfilling Ethical Obligations to our Workers and their Clients**

**Room: Winston Ballroom**

Many children of color are aging out of the child welfare system prior to finding permanency with a caring family. The presenters explore possible methods for infusing cultural awareness in child welfare agencies as well as integrating key concepts within training courses.

*Presenters:*     *Raymond Adams, MSW*  
                          *Social Work Doctoral Student*  
                          *School of Social Work*  
                          *College of Human Environmental Sciences*  
                          *University of Missouri – Columbia*  
                          *Columbia, MO*

*Kiana Webb-Robinson, LMSW*  
*Social Work Doctoral Student*  
*University of Missouri – Columbia*

Diversity

**H.E.L.P.! A Humanistic Efficacy-Based Learning Paradigm Designed to Cultivate Potential in Marginalized African American Women with Health and Socio-Economic Challenges**

The presenter incorporates an overview of issues that affect women and families, in particular, African American women and discusses an empowering tool for reducing the impact of disparities that impede their health and well-being. Implications for supporting cultural diversity and how it is critical to the development of individual and collective experiences will also be discussed.

*Presenter:*     *Shellye Sledge, LCSW*  
                          *Social Work Doctoral Student*  
                          *Ethelyn R. Strong School of Social Work*  
                          *Norfolk State University*  
                          *Norfolk, VA*

*Moderator:*    *Tamara Pace*  
                          *Social Work Doctoral Student*  
                          *Jackson State University*

ELEVENTH ANNUAL  
MISSISSIPPI CHILD WELFARE INSTITUTE CONFERENCE

“Community Engagement: A Guiding Light for Successful Children,  
Youth and Families”

Thursday, February 14, 2013

10:00 a.m. – 11:30 a.m.

CONCURRENT SESSIONS

Session III

**Child Maltreatment as an Outcome of Parental Mental Illness and Substance Use/Abuse**

**Room: Churchill I**

The presentation will include a review of the literature regarding child maltreatment, mental illness, and substance use/abuse. The presenters will also share their practice experiences and interconnected variables which may affect children and families.

*Presenters:*     *Mildred Delozia, PhD, LMSW*  
                          *Assistant Professor*  
                          *School of Social Work*  
                          *College of Professional Studies*  
                          *Grambling State University*  
                          *Grambling, LA*

*Carolyn Hester, PhD, LMSW*  
*Acting Dean, School of Social Work*  
*Assistant Professor of Social Work*  
*Grambling State University*

*Clarence Williams, LAC*  
*Assistant Professor of Social Work*  
*Grambling State University*

*Moderator:*    *Jessie Wright Chiplin, LPC*  
                          *Private Practitioner*  
                          *Jackson, MS*



**ELEVENTH ANNUAL  
MISSISSIPPI CHILD WELFARE INSTITUTE CONFERENCE**

***“Community Engagement: A Guiding Light for Successful Children,  
Youth and Families”***

**Thursday, February 14, 2013**

**10:00 a.m. – 11:30 a.m.** **CONCURRENT SESSIONS**

## Session IV      **The Effects of Loss, Grief, and Violence on Children and Their Families**

Room: Newbury

The presenters discuss a comprehensive range of services and treatment modalities that can be implemented when treating children who are the victims of violence, survivors or homicide victims, or witnesses to the act.

*Presenters: Edward Brown, LCSW, MSW  
Instructor  
Social Work Program  
Social Sciences Department  
Alcorn State University  
Alcorn, MS*

*Dorothy Idleburg, PhD  
Professor and Director  
Department of Social Work  
Alcorn State University*

Antrina Bell, MSW  
Instructor  
Department of Social Work  
Alcorn State University

*Moderator: Terria Brooks-Green  
Master of Social Work Student  
Jackson State University*

**11:30 a.m. – 1:00 p.m. LUNCH (on your own)**

**ELEVENTH ANNUAL  
MISSISSIPPI CHILD WELFARE INSTITUTE CONFERENCE**

***“Community Engagement: A Guiding Light for Successful Children,  
Youth and Families”***

**Thursday, February 14, 2013**

**1:00 p.m. – 2:00 p.m.** **CONCURRENT SESSIONS**

Session V **Causes and Risks Associated with Bullying in Schools toward Sexual Minority Youth**

**Room: Winston Ballroom**

Gay, lesbian, bisexual, transgender, questioning, and intersex (GLBTQI) youth, and those perceived to be GLBTQI, face extensive verbal and physical bullying in school. This presentation will provide approaches to accomplish goals to help build safe schools and discuss risk factors associated with the victimization of sexual minority youth.

*Presenter: Keba Richmond-Green, LACP  
Founder  
DreamGirlz Unlimited, LLC  
Atlanta, GA*

*Moderator: Tracye Ballard  
Social Work Doctoral Student  
Jackson State University*

Session VI      **The Challenges of Spirituality and Religion in Child Welfare Service Delivery**

**Room: Surrey Ballroom**

This presentation will address challenges associated with investigating child abuse and neglect in environments where the abusers exploit their religious beliefs and practices to perpetuate the abuse. Participants will be able to identify practices that are questionable in reference to ensuring the safety and well-being of children.

*Presenters: Valtreasa Tolliver-Cook, EdD, MSW, LSW  
Assistant Professor  
Social Work Department  
Alcorn State University  
Lorman, MS*

*Sandra Davis, MSW, ACSW  
Coordinator of Field Education/Instructor  
Social Work Department  
Alcorn State University*

*Moderator: Candace Carter  
Social Work Doctoral Student  
Jackson State University*

ELEVENTH ANNUAL  
MISSISSIPPI CHILD WELFARE INSTITUTE CONFERENCE

“Community Engagement: A Guiding Light for Successful Children,  
Youth and Families”

Thursday, February 14, 2013

1:00 p.m. – 2:00 p.m.

CONCURRENT SESSIONS

Session VII      **Health Literacy for Children: A Community Responsibility**

**Room: Churchill I**

In an ever increasingly complex technological world, literacy has become an important determinant of youth’s success. Specific techniques to engage the community in health literacy initiatives related to health promotion and disease prevention are discussed.

*Presenters:*      *David Brown, EdD, MA, MCHES*  
                         *Assistant Professor*  
                         *Department of Behavioral and Environmental Health*  
                         *School of Health Sciences*  
                         *College of Public Service*  
                         *Jackson State University*

*Steve Brown, PhD, JD*  
                         *Professor*  
                         *Couple and Family Therapy (CFT) Program*  
                         *System Wide Coordinator of CFT Educational Outcomes*  
                         *School of Professional Psychology*  
                         *Alliant International University*  
                         *Irvine, CA*

*Moderator:*      *Velma Hankins*  
                         *Social Work Consultant*  
                         *Jackson, MS*

ELEVENTH ANNUAL  
MISSISSIPPI CHILD WELFARE INSTITUTE CONFERENCE

“Community Engagement: A Guiding Light for Successful Children,  
Youth and Families”

Thursday, February 14, 2013

1:00 p.m. – 2:00 p.m.

CONCURRENT SESSIONS

Session VIII      **Teens Need Love Too**

**Room: Churchill II**

The presentation will provide information on the identification of important elements in working with teens in need of a family. It will also include a discussion of steps to effectively recruit families to make a lifelong commitment to teenagers and ways to support adoptive families to ensure bonding and avoid disruptions.

*Presenter:*      *Lynda Robinson, MPPA*  
                         *Wendy's Wonderful Kids Adoption Recruiter*  
                         *Southern Christian Services for Children and Youth, Inc.*  
                         *Harden House Adoption Program*  
                         *Jackson, MS*

*Moderator:*      *RoShanda Jackson*  
                         *Master of Social Work Student*  
                         *Jackson State University*

Session IX      **State of Emergency: Striving to Obtain Success for African American Males through the Theory of Social Change**

**Room: Newbury**

African American males face unique barriers and require gender and culturally responsive strategies to increase their levels of success. The presenter will explore factors that contribute to their success.

*Presenter:*      *Cassio Batteast*  
                         *Executive Director, KINGS Leadership and Development Institute*  
                         *Graduate Student, Department of Urban and Regional Planning*  
                         *School of Policy and Planning*  
                         *Jackson State University*

*Moderator:*      *Lawanda Gibbs*  
                         *Bachelor of Social Work Student*  
                         *Jackson State University*



ELEVENTH ANNUAL  
MISSISSIPPI CHILD WELFARE INSTITUTE CONFERENCE

“Community Engagement: A Guiding Light for Successful Children,  
Youth and Families”

Thursday, February 14, 2013

2:05 p.m. – 3:05 p.m.

CONCURRENT SESSIONS

Session X      **Incorporating Spirituality and Emerging Adulthood in Practice and Program Development  
for the Aging-Out Population**

**Room: Churchill I**

As the interplay between research and policy gives shape to practice it is important that social workers fulfill their professional obligation regarding youth aging out of the system. Little attention is paid to the spiritual domain of human experience. The presentation will explore how to incorporate these concepts into practice while upholding the values and mission of the profession.

*Presenter:*      Brandy Mohn  
Master of Social Work Student  
Bridgewater State University  
Bridgewater, MA

*Moderator:*    Daisy Jones  
Bachelor of Social Work Student  
Jackson State University

Session XI      **And Justice for All: Saving Children by Reforming the Criminal Justice System**

**Room: Surrey Ballroom**

The presenter will highlight the impact of incarceration of a parent on their child(ren), and raise awareness to how policy changes and advocacy can help reform the criminal justice system and the fate of the children of incarcerated parents.

*Presenter:*      Bryan Warde, PhD, LCSW  
Assistant Professor  
Social Work Department  
Lehman College/City University of New York  
Bronx, NY

*Moderator:*    Jaworski Davenport, LMSW  
Social Work Doctoral Student  
Jackson State University

ELEVENTH ANNUAL  
MISSISSIPPI CHILD WELFARE INSTITUTE CONFERENCE

“Community Engagement: A Guiding Light for Successful Children,  
Youth and Families”

Thursday, February 14, 2013

2:05 p.m. – 3:05 p.m.

CONCURRENT SESSIONS

Session XII      **Promoting Social and Emotional Well-Being in Children, Families, and Communities**

**Room: Churchill II**

The presenter will discuss challenges children and families face after being maltreated and while receiving child welfare services, review the structure of current services and practices that are being delivered, and share strategies to improve evidence-based interventions.

*Presenter:*      Sharon McKinley, MSW  
Program Manager  
Prevention and Child Protection  
Child Welfare Information Gateway  
Fairfax, VA

*Moderator:*    Deanna Parker  
Bachelor of Social Work Student  
Jackson State University

Session XIII      **Establishing Classroom Contacts and Interactions: White Educators’ Attitudes about Early  
Diversity Adolescent Black Males**

**Room: Winston Ballroom**

The presenter discusses an exploratory research paper that questions whether the white educators’ attitudes about adolescent black males and the influence of familial, societal and professional contacts that eventually become engrained in their beliefs toward this population.

*Presenter:*      Stefan Battle, EdD, MSW  
Assistant Professor  
School of Social Work  
College of Health and Human Services  
Salem State University  
Salem, MA

*Moderator:*    Harry Julian  
Master of Social Work Student  
Jackson State University

| ELEVENTH ANNUAL<br>MISSISSIPPI CHILD WELFARE INSTITUTE CONFERENCE                      |                                                                                                                                                                                                                                                                                                                                                                                                                                                                                                                                                                                                                                                                              |
|----------------------------------------------------------------------------------------|------------------------------------------------------------------------------------------------------------------------------------------------------------------------------------------------------------------------------------------------------------------------------------------------------------------------------------------------------------------------------------------------------------------------------------------------------------------------------------------------------------------------------------------------------------------------------------------------------------------------------------------------------------------------------|
| “Community Engagement: A Guiding Light for Successful Children,<br>Youth and Families” |                                                                                                                                                                                                                                                                                                                                                                                                                                                                                                                                                                                                                                                                              |
| 2:05 p.m. – 3:05 p.m.                                                                  | CONCURRENT SESSIONS                                                                                                                                                                                                                                                                                                                                                                                                                                                                                                                                                                                                                                                          |
| Session XIV                                                                            | <b>Human Trafficking: What Every Service and Care Provider Needs to Know</b><br><br><i>Room: Newbury</i><br>The presenter will discuss the definition of human trafficking, facts about it, recruiting mechanisms, and red flags. Participants will be familiarized with methods to interview possible victims and how to access services and make referrals.<br><br><i>Presenter: Heather Wagner, JD<br/>Special Assistant Attorney General<br/>Domestic Violence Division<br/>Mississippi Attorney General’s Office<br/>Jackson, MS</i><br><br><i>Moderator: Phyllis Hammond, PhD, LCSW<br/>Clinical Instructor<br/>School of Social Work<br/>Jackson State University</i> |
| 3:05 p.m. – 3:20 p.m.                                                                  | BREAK                                                                                                                                                                                                                                                                                                                                                                                                                                                                                                                                                                                                                                                                        |
| 3:20 p.m. – 4:20 p.m.                                                                  | CONCURRENT SESSIONS                                                                                                                                                                                                                                                                                                                                                                                                                                                                                                                                                                                                                                                          |
| Session XV                                                                             | <b>Breaking the Cycle, Beating the Odds, 12 Steps to Self-Awareness</b><br><br><i>Room: Newbury</i><br>The presenter will share experiences encountered and strategies for overcoming obstacles in spite of the odds.<br><br><i>Presenter: Johnnetta Mc-Swain-Clay, MSW<br/>Doctoral Candidate<br/>Whitney M. Young Jr. School of Social Work<br/>Clark-Atlanta University<br/>Atlanta, GA</i><br><br><i>Moderator: Temcula Robinson<br/>Program Manager, Independent Living<br/>Division of Family and Children’s Services<br/>Mississippi Department of Human Services<br/>Jackson, MS</i>                                                                                 |

| ELEVENTH ANNUAL<br>MISSISSIPPI CHILD WELFARE INSTITUTE CONFERENCE                      |                                                                                                                                                                                                                                                                                                                                                                                                                                                                                                                                                                                                                  |
|----------------------------------------------------------------------------------------|------------------------------------------------------------------------------------------------------------------------------------------------------------------------------------------------------------------------------------------------------------------------------------------------------------------------------------------------------------------------------------------------------------------------------------------------------------------------------------------------------------------------------------------------------------------------------------------------------------------|
| “Community Engagement: A Guiding Light for Successful Children,<br>Youth and Families” |                                                                                                                                                                                                                                                                                                                                                                                                                                                                                                                                                                                                                  |
| 3:20 p.m. – 4:20 p.m.                                                                  | CONCURRENT SESSIONS                                                                                                                                                                                                                                                                                                                                                                                                                                                                                                                                                                                              |
| Session XVI                                                                            | <b>Zero Tolerance School Discipline Policies and the Cradle to Prison Pipeline</b><br><br><i>Room: Churchill II</i><br>The presenter discusses Zero Tolerance School Discipline policies, their impact on our most vulnerable children and how we can help reduce their harmful effects through education and advocacy.<br><br><i>Presenter: Layla Fitzgerald, MS<br/>Youth Organizing Manager<br/>Children’s Defense Fund – Southern Regional Office<br/>Jackson, MS</i><br><br><i>Moderator: Latasha Levy<br/>Bachelor of Social Work Student<br/>Jackson State University</i>                                 |
| Session XVII                                                                           | <b>Fetal Alcohol Syndrome Disorder (FASD): Empowering the Social Worker to Empower the Client</b><br><br><i>Room: Churchill I</i><br>Through discussion, participants will gain a greater understanding of FASD, be able to recognize some of the signs of the disorder exhibited by their clients, and develop treatment plans that will focus on their needs.<br><br><i>Presenter: Catherine Gayle, PhD, LCSW, MFLC<br/>Chair<br/>Department of Social Work<br/>Tuskegee University<br/>Tuskegee, AL</i><br><br><i>Moderator: Lisette Riley<br/>Master of Social Work Student<br/>Jackson State University</i> |



ELEVENTH ANNUAL  
MISSISSIPPI CHILD WELFARE INSTITUTE CONFERENCE

“Community Engagement: A Guiding Light for Successful Children,  
Youth and Families”

Thursday, February 14, 2013

3:20 p.m. – 4:20 p.m.

CONCURRENT SESSIONS

Session XVIII    **HIV Status Affecting African American Women and Families: Implications for Social  
Workers**

Diversity

**Room: Surrey Ballroom**

Social workers working with HIV women must evaluate the entire family and community in order to provide the most appropriate service. The presenter will address dilemmas that affect this population and how HIV positive women often put their loved ones at risk by not disclosing their health status.

*Presenters:*     *Marco Williams, LSW*  
                         *Master of Social Work Student – Jackson State University*  
                         *Social Worker*  
                         *Mississippi Department of Human Services*  
                         *Division of Family and Children Services*  
                         *Jackson, MS*

*Brian Anderson, PhD*  
*Associate Professor of Social Work*  
*Jackson State University*

*Shonda Lawrence, PhD*  
*Assistant Professor of Social Work*  
*Jackson State University*

*Moderator:*    *Roshelle Halcomb*  
                         *Social Worker*  
                         *Hudspeth Regional Center*  
                         *Whitfield, MS*

ELEVENTH ANNUAL  
MISSISSIPPI CHILD WELFARE INSTITUTE CONFERENCE

“Community Engagement: A Guiding Light for Successful Children,  
Youth and Families”

Thursday, February 14, 2013

3:20 p.m. – 4:20 p.m.

CONCURRENT SESSIONS

Session XVIII    **Fighting Childhood and Adult Obesity in Mississippi through Equitable Planning in the Built  
(Continued)    Environment**

**Room: Surrey Ballroom**

The presenter discusses a research study that was conducted to identify areas more plagued by obesity due to certain factors in the built environment. Identification and proximity to healthy and unhealthy food sources and access to physical activities and venues will also be discussed.

*Presenter:*     *Shayron Nichols*  
                         *Doctoral Student*  
                         *Department of Urban and Regional Planning*  
                         *School of Policy and Planning*  
                         *College of Public Service*  
                         *Jackson State University*

*Moderator:*    *Roshelle Halcomb*  
                         *Social Worker*  
                         *Hudspeth Regional Center*  
                         *Whitfield, MS*

4:30 p.m. – 5:30 p.m.

PLENARY SESSION

Location:        Windsor III, IV & V

| ELEVENTH ANNUAL<br>MISSISSIPPI CHILD WELFARE INSTITUTE CONFERENCE                      |                                                                                                                                                                                                                                                                                                                                                                                                                                                                                 |
|----------------------------------------------------------------------------------------|---------------------------------------------------------------------------------------------------------------------------------------------------------------------------------------------------------------------------------------------------------------------------------------------------------------------------------------------------------------------------------------------------------------------------------------------------------------------------------|
| “Community Engagement: A Guiding Light for Successful Children,<br>Youth and Families” |                                                                                                                                                                                                                                                                                                                                                                                                                                                                                 |
| Thursday, February 14, 2013                                                            |                                                                                                                                                                                                                                                                                                                                                                                                                                                                                 |
| PLENARY SESSION                                                                        |                                                                                                                                                                                                                                                                                                                                                                                                                                                                                 |
| 4:30 p.m. – 5:30 p.m.                                                                  |                                                                                                                                                                                                                                                                                                                                                                                                                                                                                 |
| Location: Windsor III, IV & V                                                          |                                                                                                                                                                                                                                                                                                                                                                                                                                                                                 |
| Presider                                                                               | Portia Ballard Espy, MBA<br>Chief Administrative Officer<br>Children’s Defense Fund – Southern Region<br>Jackson, MS                                                                                                                                                                                                                                                                                                                                                            |
| Introduction of Speakers                                                               | Portia Ballard Espy<br>Mario Johnson<br>Gwendolyn Spencer Prater                                                                                                                                                                                                                                                                                                                                                                                                                |
| Speakers                                                                               | National Foundations’ Community Engagement in<br>Mississippi: Toward Greater Success for Our<br>Children, Youth and Families<br><br>William Buster, BS<br>Director, New Orleans/Mississippi Programming<br>W.K. Kellogg Foundation<br>Battle Creek, MI<br><br>Lisa McGill, PhD<br>Site Liaison to Mississippi<br>Jim Casey Youth Opportunities Initiative<br>St. Louis, MO<br><br>Virginia Pryor, MSW<br>Director, Strategic Consulting<br>Casey Family Programs<br>Seattle, WA |
| Remarks                                                                                | Portia Ballard Espy                                                                                                                                                                                                                                                                                                                                                                                                                                                             |

| ELEVENTH ANNUAL<br>MISSISSIPPI CHILD WELFARE INSTITUTE CONFERENCE                                                                                                                                                                                                                                                                                                                                                                                                                                                                                             |                                                                                                                                                                                                                                                                                                                                                                                                                                                                |
|---------------------------------------------------------------------------------------------------------------------------------------------------------------------------------------------------------------------------------------------------------------------------------------------------------------------------------------------------------------------------------------------------------------------------------------------------------------------------------------------------------------------------------------------------------------|----------------------------------------------------------------------------------------------------------------------------------------------------------------------------------------------------------------------------------------------------------------------------------------------------------------------------------------------------------------------------------------------------------------------------------------------------------------|
| “Community Engagement: A Guiding Light for Successful Children,<br>Youth and Families”                                                                                                                                                                                                                                                                                                                                                                                                                                                                        |                                                                                                                                                                                                                                                                                                                                                                                                                                                                |
| Thursday, February 14, 2013                                                                                                                                                                                                                                                                                                                                                                                                                                                                                                                                   |                                                                                                                                                                                                                                                                                                                                                                                                                                                                |
| Field Education Symposium                                                                                                                                                                                                                                                                                                                                                                                                                                                                                                                                     |                                                                                                                                                                                                                                                                                                                                                                                                                                                                |
| 1:00 p.m. – 3:05 p.m.                                                                                                                                                                                                                                                                                                                                                                                                                                                                                                                                         | Partners in Growth: An Informational Forum on Intergenerational Concepts<br>and Engagements                                                                                                                                                                                                                                                                                                                                                                    |
| Room: Canterbury                                                                                                                                                                                                                                                                                                                                                                                                                                                                                                                                              |                                                                                                                                                                                                                                                                                                                                                                                                                                                                |
| As America’s population ages, many service providers and educators realize the potential and benefits in linking young and old people through intergenerational programs. New initiatives are emerging throughout the country that aim to bring young people and older people together in various settings to interact, engage, support, and ultimately provide care for one another. The focus of this symposium is to engage in discussions of intergenerational activities and studies in field placements and in other agencies throughout the community. |                                                                                                                                                                                                                                                                                                                                                                                                                                                                |
| Presenters:                                                                                                                                                                                                                                                                                                                                                                                                                                                                                                                                                   | Roktabija Abdul-Azeen<br>State Program Director<br>Corporation for National and Community Service<br>Jackson, MS<br><br>Dorothy McGill, PhD<br>Chief Executive Officer<br>Innovative Behavioral Services, Inc.<br>Jackson, MS<br><br>Bernice McKenny, LMSW<br>Director<br>Mississippi Counseling Center<br>Jackson, MS<br><br>Gwendolyn Moore, MS<br>Community Services Supervisor<br>City of Jackson Department of Human and Cultural Services<br>Jackson, MS |
| Moderator:                                                                                                                                                                                                                                                                                                                                                                                                                                                                                                                                                    | Theresia Johnson-Ratliff, PhD, LCSW<br>Director of Field Education and Assistant Clinical Professor<br>School of Social Work<br>Jackson State University                                                                                                                                                                                                                                                                                                       |
| 3:05 p.m. – 3:20 p.m.                                                                                                                                                                                                                                                                                                                                                                                                                                                                                                                                         | BREAK                                                                                                                                                                                                                                                                                                                                                                                                                                                          |



ELEVENTH ANNUAL  
MISSISSIPPI CHILD WELFARE INSTITUTE CONFERENCE

“Community Engagement: A Guiding Light for Successful Children,  
Youth and Families”

Thursday, February 14, 2013

Sponsor and Networking Reception

6:00 P.M. - 8:00 P.M.  
MARRIOTT HOTEL  
WINDSOR ROOMS

DR. ANNA MARSHALL, PRESIDING

GREETINGS

DR. ANNA MARSHALL

WELCOME

DR. SUSIE A. SPENCE

RECOGNITION OF SPECIAL GUESTS  
SPENCER PRATER

DR. GWENDOLYN

INVOCATION

MRS. TASHA SMITH

REMARKS

DR. MARIO AZEVEDO

REFRESHMENTS

ENTERTAINMENT  
ANDY HARDWICK & FRIENDS

ELEVENTH ANNUAL  
MISSISSIPPI CHILD WELFARE INSTITUTE CONFERENCE

“Community Engagement: A Guiding Light for Successful Children,  
Youth and Families”

Friday, February 15, 2013

PLENARY SESSION

8:20 a.m. – 9:15 a.m.  
Location: Windsor III, IV & V

Presider

Susie A. Spence, PhD  
Interim Executive Director and Professor  
Director, Ph.D. Program  
School of Social Work  
College of Public Service  
Jackson State University

Introduction of Guest Speaker

Gwendolyn Spencer Prater, PhD  
Dean Emerita and Consultant  
School of Social Work  
College of Public Service  
Jackson State University

Recovering from the Shame, Guilt, and  
Embarrassment: The Perspective from One  
Person’s Heart-wrenching Journey of Physical and  
Sexual Abuse

Speaker

Dominic Carter  
Author  
Political Commentator  
RNN-TV News  
Rye Brook, NY

Presentation

Susie A. Spence, PhD

ELEVENTH ANNUAL  
MISSISSIPPI CHILD WELFARE INSTITUTE CONFERENCE

“Community Engagement: A Guiding Light for Successful Children,  
Youth and Families”

Friday, February 15, 2013

9:20 a.m. – 10:20 a.m.

CONCURRENT SESSIONS

Session XIX     **Affirming Diversity: An Introductory Guide to Embracing Diversity in Your Organization**  
**Diversity**

**Room: Surrey Ballroom**  
Since the issuance of Workforce Diversity 2000, efforts toward diversity have been of importance to leaders and others in the workforce. The presentation will include discussions of the dimensions of diversity; policy, political and legal environments; and differences in diversity management and cultural competency.

*Presenters:*     *Curtina Moreland-Young, PhD*  
                         *Pathfinders and Associates*  
                         *Jackson, MS*

*Royal Walker, JD*  
*Executive Director*  
*Institute for Disability Studies*  
*University of Southern Mississippi*

*Moderator:*     *Anna Marshall, PhD*  
                         *Assistant Professor of Social Work*  
                         *Jackson State University*

Session XX     **The Role of Human Resources in the Recruitment and Retention of Child Welfare Workers:**  
**Implications for Supervisors and Managers**

**Room: Canterbury**  
The presenter will discuss ways to establish strategic partnerships to promote the recruitment and retention of a qualified child welfare workforce. Possible challenges and ways to expand the pool of quality candidates will also be addressed.

*Presenter:*     *Ester Stokes, PhD*  
                         *Visiting Assistant Professor*  
                         *Department of Public Policy and Administration*  
                         *School of Policy and Planning*  
                         *College of Public Service*  
                         *Jackson State University*

*Moderator:*     *Lisa Johnson*  
                         *Student Development Coordinator*  
                         *Department of Urban and Regional Planning*  
                         *School of Policy and Planning*  
                         *College of Public Service*  
                         *Jackson State University*

ELEVENTH ANNUAL  
MISSISSIPPI CHILD WELFARE INSTITUTE CONFERENCE

“Community Engagement: A Guiding Light for Successful Children,  
Youth and Families”

Friday, February 15, 2013

9:20 a.m. – 10:20 a.m.

CONCURRENT SESSIONS

Session XXI     **Clinical Supervision in a Community Setting**  
**Supervision**

**Room: Churchill II**  
The presenter will distinguish between the terms clinical supervision and clinical social work practice. Participants will be able to identify their own supervisory style, expectations from supervisee and recognize ethical issues related to supervision and clinical practice.

*Presenter:*     *Kira Johnson, LCSW*  
                         *Private Practitioner*  
                         *Owner, Renew Counseling Services*  
                         *Jackson, MS*

*Moderator:*     *Regina Curry, LMSW*  
                         *Mitigation Specialist*  
                         *Mississippi Office of Capital Defense*  
                         *Jackson, MS*

Session XXII     **Textual Misconduct: Sexting and Cyberbullying**

**Room: Churchill I**  
The presenter will identify issues children face online, Internet predators, and privacy issues, discuss the consequences, and provide tools and resources to address each issue.

*Presenter:*     *Leah Kathryn Campbell, JD*  
                         *Internet Crimes Against Children Educational Specialist*  
                         *Mississippi Attorney General’s Office Cyber Crime Unit*  
                         *Jackson, MS*

*Moderator:*     *Kenyata Wells*  
                         *Bachelor of Social Work Student*  
                         *Jackson State University*



| ELEVENTH ANNUAL<br>MISSISSIPPI CHILD WELFARE INSTITUTE CONFERENCE                      |                                                                                                                                                                                                                                                                                                                                                                                                                                                                                                                                                                                                                                                                                                                                                                                                                                                                                                                                                                                                                                                                                                            |
|----------------------------------------------------------------------------------------|------------------------------------------------------------------------------------------------------------------------------------------------------------------------------------------------------------------------------------------------------------------------------------------------------------------------------------------------------------------------------------------------------------------------------------------------------------------------------------------------------------------------------------------------------------------------------------------------------------------------------------------------------------------------------------------------------------------------------------------------------------------------------------------------------------------------------------------------------------------------------------------------------------------------------------------------------------------------------------------------------------------------------------------------------------------------------------------------------------|
| “Community Engagement: A Guiding Light for Successful Children,<br>Youth and Families” |                                                                                                                                                                                                                                                                                                                                                                                                                                                                                                                                                                                                                                                                                                                                                                                                                                                                                                                                                                                                                                                                                                            |
| Friday, February 15, 2013                                                              |                                                                                                                                                                                                                                                                                                                                                                                                                                                                                                                                                                                                                                                                                                                                                                                                                                                                                                                                                                                                                                                                                                            |
| 9:20 a.m. – 10:20 a.m.                                                                 | CONCURRENT SESSIONS                                                                                                                                                                                                                                                                                                                                                                                                                                                                                                                                                                                                                                                                                                                                                                                                                                                                                                                                                                                                                                                                                        |
| Session XXIII<br>Diversity<br>Ethics                                                   | <b>I Don’t See Color: Countering Myths and Building Skills in Ethical Work with the Culturally Diverse</b><br><br><b>Room: Winston Ballroom</b><br>The presenters offer an interactive workshop that provides information and skill-building methods to overcome the myths associated with serving the culturally diverse. They review codes of ethics and identify and apply skills of ethical and effective work with culturally diverse children and families.<br><br><i>Presenters:</i> <i>Jennifer Savage, PhD, LCSW-PIP</i><br><i>Associate Professor</i><br><i>Department of Social Work and Sociology</i><br><i>College of Arts and Sciences</i><br><i>Jacksonville State University</i><br><i>Jacksonville, AL</i><br><br><i>Pamela Higgins Saulsberry, PhD, LCSW-BACS</i><br><i>Professor and Director</i><br><i>School of Social Sciences</i><br><i>University of Louisiana at Monroe</i><br><i>Monroe, LA</i><br><br><i>Moderator:</i> <i>Marty Fortenberry</i><br><i>Community Outreach Specialist</i><br><i>Jackson Heart Study</i><br><i>Jackson State University</i><br><i>Jackson, MS</i> |

| ELEVENTH ANNUAL<br>MISSISSIPPI CHILD WELFARE INSTITUTE CONFERENCE                      |                                                                                                                                                                                                                                                                                                                                                                                                                                                                                                                                                                                                                                                                                                                                                                                                                                                                                                                       |
|----------------------------------------------------------------------------------------|-----------------------------------------------------------------------------------------------------------------------------------------------------------------------------------------------------------------------------------------------------------------------------------------------------------------------------------------------------------------------------------------------------------------------------------------------------------------------------------------------------------------------------------------------------------------------------------------------------------------------------------------------------------------------------------------------------------------------------------------------------------------------------------------------------------------------------------------------------------------------------------------------------------------------|
| “Community Engagement: A Guiding Light for Successful Children,<br>Youth and Families” |                                                                                                                                                                                                                                                                                                                                                                                                                                                                                                                                                                                                                                                                                                                                                                                                                                                                                                                       |
| Friday, February 15, 2013                                                              |                                                                                                                                                                                                                                                                                                                                                                                                                                                                                                                                                                                                                                                                                                                                                                                                                                                                                                                       |
| 9:20 a.m. – 10:20 a.m.                                                                 | CONCURRENT SESSIONS                                                                                                                                                                                                                                                                                                                                                                                                                                                                                                                                                                                                                                                                                                                                                                                                                                                                                                   |
| Session XXIV<br>Diversity                                                              | <b>Mentoring At-Risk Youth in a Rural Community</b><br><br><b>Room: Newbury</b><br>The presenters will discuss barriers encountered by the culture of poverty and how social work students addressed issues of diversity in race, ethnicity, gender, and socioeconomic status and bridged the differences to form lasting bonds.<br><br><i>Presenters:</i> <i>Mary Fran Davis, LCSW</i><br><i>Chair</i><br><i>Department of Social Work</i><br><i>College of Behavioral and Health Sciences</i><br><i>Austin Peay State University</i><br><i>Clarksville, TN</i><br><br><i>Leslie Swanson</i><br><i>Bachelor of Social Work Student</i><br><i>Austin Peay State University</i><br><br><i>Wanda Brewer</i><br><i>Bachelor of Social Work Student</i><br><i>Austin Peay State University</i><br><br><i>Moderator:</i> <i>Bianca Shelly</i><br><i>Bachelor of Social Work Student</i><br><i>Jackson State University</i> |
| 10:25 a.m. – 10:40 a.m.                                                                | BREAK                                                                                                                                                                                                                                                                                                                                                                                                                                                                                                                                                                                                                                                                                                                                                                                                                                                                                                                 |
| 10:45 a.m. – 12:00 noon                                                                | CONCURRENT SESSIONS                                                                                                                                                                                                                                                                                                                                                                                                                                                                                                                                                                                                                                                                                                                                                                                                                                                                                                   |

ELEVENTH ANNUAL  
MISSISSIPPI CHILD WELFARE INSTITUTE CONFERENCE

“Community Engagement: A Guiding Light for Successful Children,  
Youth and Families”

Friday, February 15, 2013

10:45 a.m. – 12:00 noon

CONCURRENT SESSIONS

Session XXV    **Reactive Attachment Disorder (RAD) in Maltreated Children: Recognizing Symptoms and Providing Effective Interventions**

**Room: Surrey Ballroom**

The presenters will review literature regarding risk factors of reactive attachment disorders, symptoms, assessment, and possible intervention strategies will also be discussed. Participants will also be presented information to distinguish between the two sub-types of RAD.

*Presenters:*     *Laura Sanders Brown, JD*  
                         *Master of Social Work Student*  
                         *Jackson State University*

*Brian Anderson, PhD*  
                         *Associate Professor of Social Work*  
                         *Jackson State University*

*Shonda Lawrence, PhD*  
                         *Assistant Professor of Social Work*  
                         *Jackson State University*

*Moderator:*    *Trenia Allen, LCSW*  
                         *Visiting Instructor*  
                         *School of Social Work*  
                         *Jackson State University*

ELEVENTH ANNUAL  
MISSISSIPPI CHILD WELFARE INSTITUTE CONFERENCE

“Community Engagement: A Guiding Light for Successful Children,  
Youth and Families”

Friday, February 15, 2013

10:45 a.m. – 12:00 noon

CONCURRENT SESSIONS

Session XXV    **Death and Dying: Hospice at End-of-Life and Implications for Children and Families**  
(Continued)

**Room: Surrey Ballroom**

Denial is a common reaction by patients and family members as they receive and come to grips that end of life is imminent. Participants will have an understanding of the various cultural differences and views concerning death and have a better understanding of practicing the art of empathetic listening.

*Presenters:*     *Mark Roth*  
                         *Staff Chaplain*  
                         *Mississippi Baptist Health Systems*  
                         *Master of Social Work Student*  
                         *Jackson State University*

*Brian Anderson, PhD*  
                         *Associate Professor of Social Work*  
                         *Jackson State University*

*Shonda Lawrence, PhD*  
                         *Assistant Professor of Social Work*  
                         *Jackson State University*

*Moderator:*    *Trenia Allen, LCSW*  
                         *Visiting Instructor*  
                         *School of Social Work*  
                         *Jackson State University*



ELEVENTH ANNUAL  
MISSISSIPPI CHILD WELFARE INSTITUTE CONFERENCE

“Community Engagement: A Guiding Light for Successful Children,  
Youth and Families”

Friday, February 15, 2013

10:45 a.m. – 12:00 noon CONCURRENT SESSIONS

Session XXVI Engaging Families and Systems through Children: Childhood Obesity in Jefferson County  
MS

Room: Churchill II

The presenters discuss a collaborative partnership in which children and adults were screened for obesity and encouraged to join a local organization’s free fat-to-fit family program. The results were disseminated to the community through a variety of media outlets.

Presenters: Olúgbémiga Ekúndayò, MD, MPH, DrPH  
Associate Professor  
School of Health Sciences  
College of Public Service  
Jackson State University

Gerri Cannon-Smith, MD  
Assistant Professor  
School of Health Sciences  
Jackson State University  
Certified Pediatrician

Anthony Edwards  
Chairman of Board, Fayette Community Service Organization  
Fayette, MS

Janelle Edwards  
Executive Director, Fayette Community Service Organization

Tracey Cook  
Superintendent  
Jefferson County School District  
Fayette, MS

Sade Kosoko-Lasaki, MD, MSPH, MBA, FAASS  
Associate Vice President for Health Sciences  
Creighton University  
Omaha, NE

Moderator: Velma Hankins  
Social Work Consultant  
Jackson, MS

ELEVENTH ANNUAL  
MISSISSIPPI CHILD WELFARE INSTITUTE CONFERENCE

“Community Engagement: A Guiding Light for Successful Children,  
Youth and Families”

Friday, February 15, 2013

10:45 a.m. – 12:00 noon CONCURRENT SESSIONS

Session XXVII Are We Social Workers or Child Welfare Workers: Ethical Issues Related to Role Confusion  
Ethics

Room: Winston Ballroom

A critical issue that has confronted social workers has been the loss of professional identity related to work with children and families. The presenter will challenge participants to examine how social work’s influence in child welfare must hinge upon the incorporation of the profession’s values and ethics in child protective services.

Presenter: Vincent Venturini, PhD, LCSW  
Interim Associate Provost  
Mississippi Valley State University  
Itta Bena, MS

Moderator: April Douglas  
Master of Social Work Student  
Jackson State University

Session XXVIII School Safety: 500,000 Reasons Why!

Room: Newbury

The presenter will provide an overview of school safety requirements in Mississippi public schools and discuss current school safety initiatives the state has in place.

Presenter: Shane McNeill  
Director, Office of Safe and Orderly Schools  
Mississippi Department of Education  
Jackson, MS

Moderator: Lynice Higgins  
Bachelor of Social Work Student  
Jackson State University

ELEVENTH ANNUAL  
MISSISSIPPI CHILD WELFARE INSTITUTE CONFERENCE  
“Community Engagement: A Guiding Light for Successful Children,  
Youth and Families”

Friday, February 15, 2013

CLOSING LUNCHEON

Location: Windsor I & II

12:15 p.m. – 1:45 p.m.

|                         |                                                                                                                                                                               |
|-------------------------|-------------------------------------------------------------------------------------------------------------------------------------------------------------------------------|
| Presider                | <b>Dr. Susie A. Spence</b><br>Interim Executive Director and<br>Ph.D. Program Director<br>School of Social Work<br>College of Public Service<br>Jackson State University      |
| Greetings               | <b>Dr. James Renick</b><br>Interim Provost and Vice President<br>for Academic Affairs<br>Jackson State University                                                             |
| Invocation              | <b>Dr. Kelvin Langston</b><br>Pastor<br>True Vine Baptist Church<br>Brandon, MS                                                                                               |
| Introduction of Speaker | <b>Gwendolyn Spencer Prater, PhD</b><br><br><b>Out of the Shadows into the Light: Engaging<br/>Communities to Improve Safety, Permanence, Child<br/>and Family Well-Being</b> |
| Speaker                 | <b>Alberta Ellett, PhD</b><br>Associate Professor<br>School of Social Work<br>University of Georgia<br>Atlanta, GA                                                            |
| Presentation of Awards  | <b>Susie A. Spence, PhD</b><br><br><b>Anna Marshall, PhD</b><br>Assistant Professor of Social Work<br>Jackson State University                                                |
| Closing Remarks         | <b>Gwendolyn Spencer Prater, PhD</b>                                                                                                                                          |

ELEVENTH ANNUAL  
MISSISSIPPI CHILD WELFARE INSTITUTE CONFERENCE  
“Community Engagement: A Guiding Light for Successful Children,  
Youth and Families”

Exhibitors

Brentwood Behavioral Healthcare of Mississippi

Catholic Charities

**Child Welfare Information Gateway**  
*A Service of the U.S. Children’s Bureau*  
*Administration on Children and Families (ACF)*  
*Department of Health and Human Services (HHS)*

**Children’s Trust Fund**  
**Mississippi Department of Human Services**

**Jackson Medical Mall Foundation**

**Jackson State University – College of Public Service**  
*School of Social Work*

**Mississippi Department of Mental Health**  
*Division of Children and Youth Services*

**Mississippi State Department of Health**  
*Child and Adolescent Health*

**Mississippi State Department of Health**  
*Office of Preventive Health*

**Mississippi Department of Human Services**  
*Division of Family and Children’s Services*

**Mississippi Families for Kids**

**Southern Christian Services for Children and Youth**

**Youth Villages**



**ELEVENTH ANNUAL  
MISSISSIPPI CHILD WELFARE INSTITUTE CONFERENCE**

*“Community Engagement: A Guiding Light for Successful Children, Youth and Families”*

**Program Planning Committee**

Dr. Gwendolyn Spencer Prater, Chair – Dean Emerita  
Dr. Susie A. Spence, Ex-Officio – Jackson State University  
Mrs. Shirley Banks – Jackson State University  
Ms. Eugenia Cook – Jackson State University  
Ms. Jean Cook – Jackson State University  
Ms. Eva Bowie Ellis – Social Work Consultant  
Mrs. Portia Ballard Espy – Children’s Defense Fund  
Dr. Phyllis Hammond – Jackson State University  
Ms. Velma Hankins – Social Work Consultant  
Ms. Eunetta Hart – Jackson State University  
Ms. Cherish Johnson - Mississippi Department of Employment Security  
Mr. Mario Johnson – Mississippi Department of Human Services  
*Division of Family and Children’s Services*  
Dr. Anna Marshall – Jackson State University  
Ms. Temcula Robinson – Mississippi Department of Human Services  
*Division of Family and Children’s Services*  
Dr. Theresia Ratliff – Jackson State University  
Ms. Betty Reed – Jackson State University  
Mrs. Tasha Smith – Mississippi Department of Human Services  
*Division of Family and Children’s Services*  
Ms. Gwendolyn Winters – Mississippi State Department of Health  
*Office of Child and Adolescent*  
Mrs. Jessie Chiplin Wright – Private Practitioner

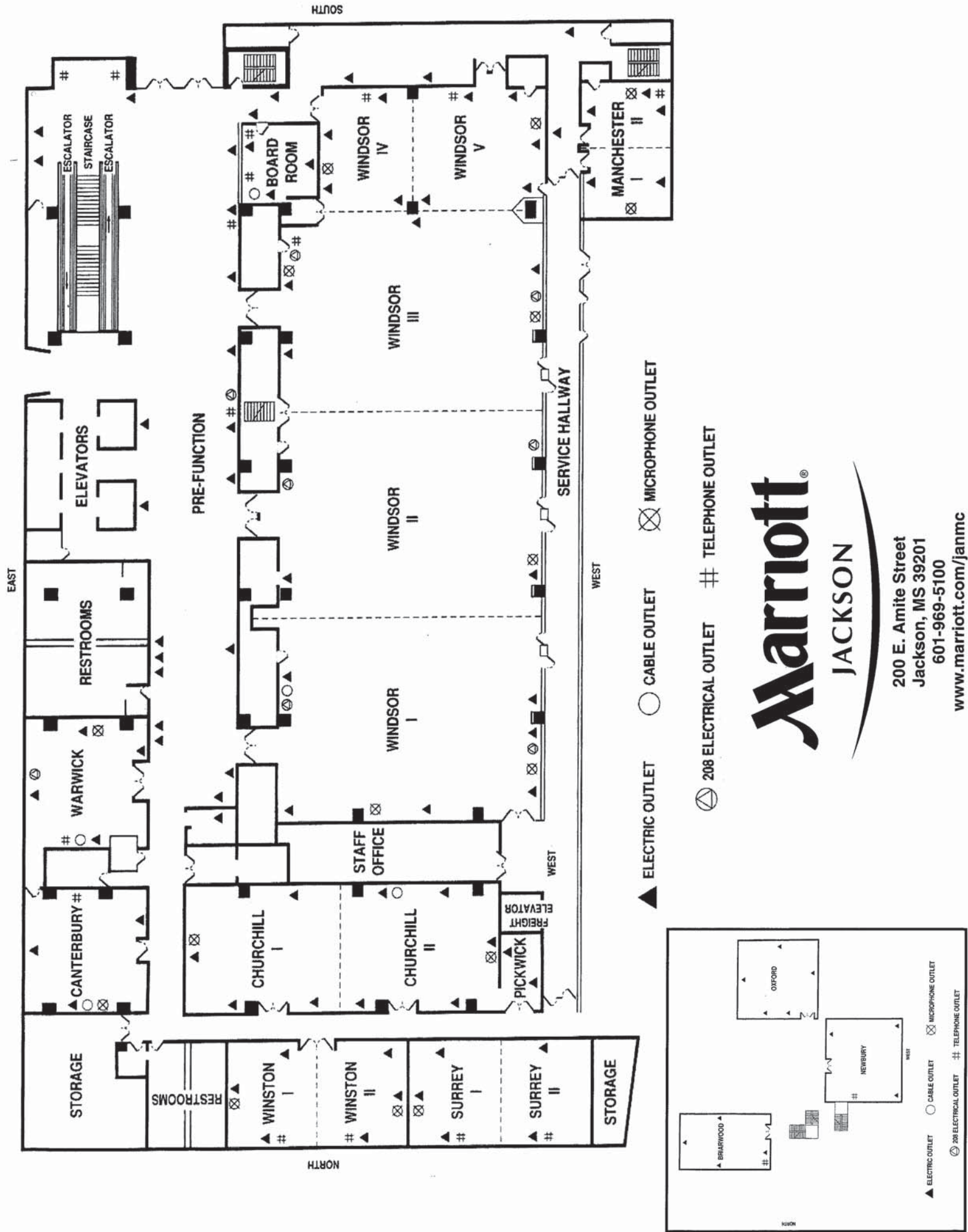

**Congratulations**  
**to the**  
**Mississippi Child Welfare Institute - School of Social Work**  
**on its**

**ELEVENTH ANNUAL CONFERENCE**  
*““Community Engagement: A Guiding Light for Successful Children, Youth and Families”*

**College of Public Service**  
(601) 979.8836  
[www.cps.jsums.edu](http://www.cps.jsums.edu)  
**Dr. Mario J. Azevedo, Interim Dean**  
  
**Mississippi Child Welfare Institute**  
(601) 979.1123  
[www.jsums.edu/mcwi](http://www.jsums.edu/mcwi)

**School of Health Sciences**  
(601) 979.8806  
[www.cps.jsums.edu](http://www.cps.jsums.edu)  
Communicative Disorders (601) 432.6717 – B.S. and M.S. Degrees  
Epidemiology and Biostatistics (601) 979.8789 – M.P.H. & Dr.P.H. Degrees  
Health Policy and Management (601) 979.8826 – M.P.H. & Dr.P.H. Degrees  
and Health Care Administration – B.S. Degree  
Behavioral and Environmental Health (601) 979.1143 – M.P.H. & Dr.P.H. Degrees

**School of Policy and Planning**  
(601) 432.6865  
[www.cps.jsums.edu](http://www.cps.jsums.edu)  
Urban and Regional Planning (601) 432.6865 – M.A. & Ph.D. Degrees  
Urban Studies (601) 432.6865 – B.A. Degree  
Public Policy & Administration (601) 432.6368 – M.P.P.A. & Ph.D. Degrees

**School of Social Work**  
(601) 432.6828  
[www.cps.jsums.edu](http://www.cps.jsums.edu)  
Social Work (601) 432.6811 – Ph.D. Degree  
Social Work (601) 432.6819 – M.S.W. Degree  
Social Work (601) 979.2631 – B.S.W. Degree

**MARK YOUR CALENDAR**



**Mississippi Child Welfare Institute  
Conference**

**February 19-21, 2014**

**MARRIOTT HOTEL  
JACKSON, MS**