

JACKSON STATE UNIVERSITY COLLEGE OF PUBLIC SERVICE

# SCHOOL OF SOCIAL WORK

**Child Welfare: Building Community  
Partnerships for Safe and Healthy  
Children and Families**

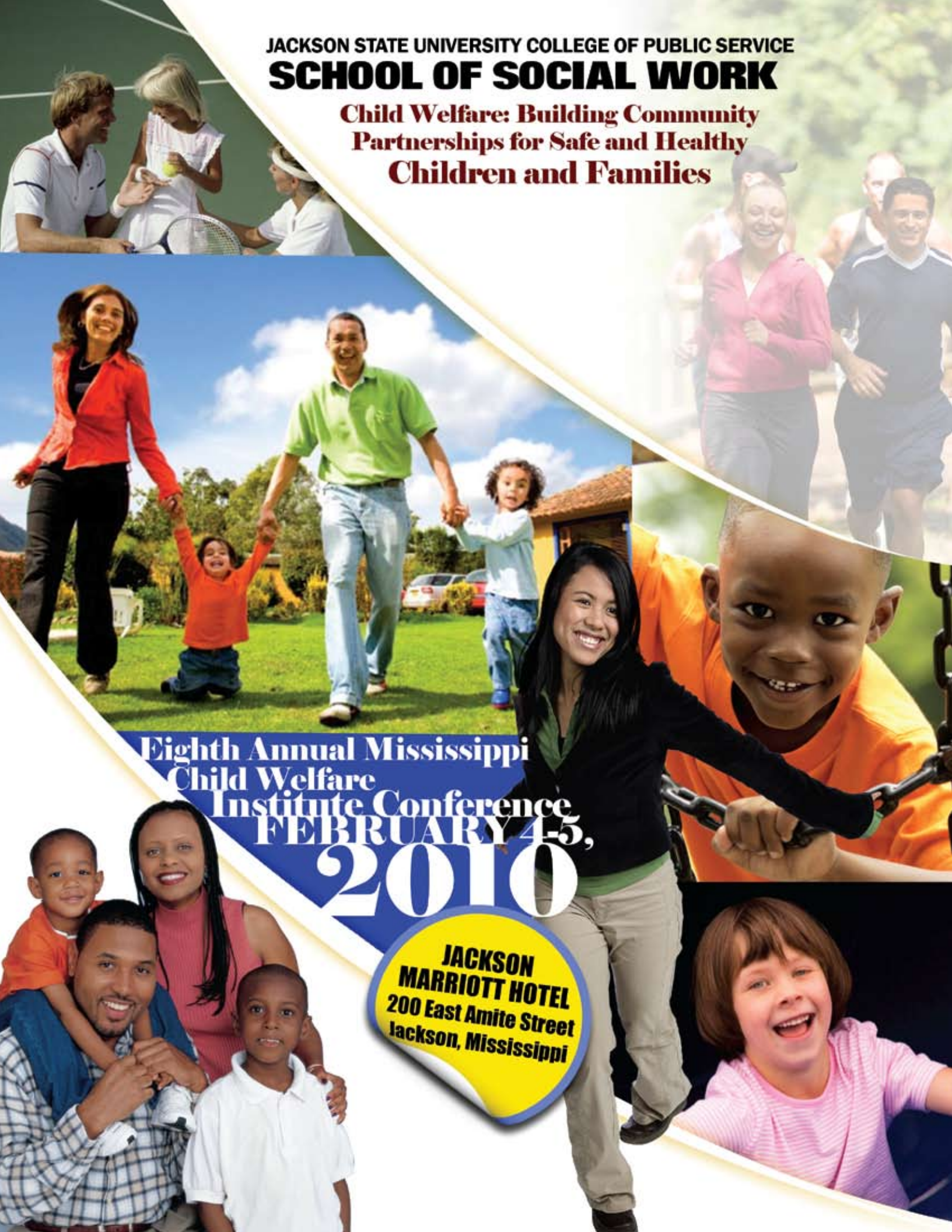

Eighth Annual Mississippi  
Child Welfare  
Institute Conference  
**FEBRUARY 4-5,  
2010**

**JACKSON  
MARRIOTT HOTEL  
200 East Amite Street  
Jackson, Mississippi**

**EIGHTH ANNUAL  
MISSISSIPPI CHILD WELFARE INSTITUTE CONFERENCE**

***“Child Welfare: Building Community Partnerships for Safe  
and Healthy Children and Families”***

**Sponsored by  
College of Public Service  
School of Social Work**



**Co-Sponsors**

*Silver*  
**Social Work prn**

*Bronze*  
**Children’s Defense Fund  
Mississippi Department of Mental Health-Bureau of Alcohol  
and Drug Abuse**

*Copper*  
**Another Chance Enterprise  
Jackson Medical Mall Foundation  
Mississippi Department of Health, Office of  
Child/Adolescent Health  
Patient's Choice Medical Center**

**BENNIE G. THOMPSON**  
SECOND DISTRICT, MISSISSIPPI

COMMITTEE ON  
HOMELAND SECURITY  
CHAIRMAN

WASHINGTON OFFICE:  
2432 RAYBURN HOUSE OFFICE BUILDING  
WASHINGTON, DC 20515-2402  
(202) 225-5876  
(202) 225-5898: FAX  
E-Mail: [benniethompson@mail.house.gov](mailto:benniethompson@mail.house.gov)  
Home Page: <http://www.house.gov/thompson>

THE COMMISSION ON  
CONGRESSIONAL MAILING  
STANDARDS

CONGRESSIONAL BLACK CAUCUS  
CONGRESSIONAL GAMING CAUCUS  
CONGRESSIONAL PROGRESSIVE CAUCUS  
CONGRESSIONAL SPORTSMEN'S CAUCUS  
CONGRESSIONAL RURAL CAUCUS  
HOUSE EDUCATION CAUCUS

**Congress of the United States**  
**House of Representatives**  
**Washington, DC 20515-2402**

February 4, 2010

Jackson State University  
College of Public Service  
School of Social Work  
3825 Ridgewood Road, ILH-103  
Jackson, MS 39211

Dear Friends:

It gives me great pleasure to bring you greetings from Mississippi's Second Congressional District during your Eighth Annual Mississippi Child Welfare Institute Conference. I salute the School of Social Work for the work you are doing in raising awareness about child welfare issues.

I am honored to play a small part in this year's conference as you highlight the need to build community partnerships to advocate for our children and families. This year's theme, Child Welfare: Building Community Partnerships for Safe and Healthy Children and Families reflects the commitment that is necessary to pursue an agenda of clarity and purpose in the protection of our children and families. It is clear that our mission must be one of advocacy, good public policy and community involvement to keep our families strong.

I applaud your dedication and commitment in keeping the welfare of children and families at the forefront of the public debate and setting sound public policy. Please know that you are making a difference in dispensing good information and creating necessary dialogue through your yearly conferences. I am confident that you will renew and rededicate yourself to this ongoing fight to keep our children, families and communities safe and healthy.

You have my best wishes for a successful and engaging conference this year. **Keep the Faith!**

Sincerely,



Bennie G. Thompson  
Member of Congress

<input type="checkbox"/> 107 WEST MADISON STREET P.O. Box 610 BOLTON, MS 39041 (601) 866-9003 (601) 866-9036: FAX (800) 355-9003: IN ST.	<input type="checkbox"/> 509 HIGHWAY 82 WEST GREENWOOD, MS 38930 (662) 455-9003 (662) 453-0118: FAX	<input type="checkbox"/> 910 COURTHOUSE LANE GREENVILLE, MS 38701 (662) 335-9003 (662) 334-1304: FAX	<input type="checkbox"/> 3607 MEDGAR EVERS BOULEVARD JACKSON, MS 39213 (601) 946-9003 (601) 982-5337: FAX	<input type="checkbox"/> 263 EAST MAIN STREET P.O. Box 356 MARKS, MS 38646 (662) 326-9003 (662) 326-9003: FAX	<input type="checkbox"/> MOUND BAYOU CITY HALL P.O. Box 679 106 GREEN AVENUE, SUITE 106 MOUND BAYOU, MS 38762 (662) 741-9003 (662) 741-9002: FAX
---------------------------------------------------------------------------------------------------------------------------------------------------------	--------------------------------------------------------------------------------------------------------------	---------------------------------------------------------------------------------------------------------------	--------------------------------------------------------------------------------------------------------------------	---------------------------------------------------------------------------------------------------------------------------	-----------------------------------------------------------------------------------------------------------------------------------------------------------------



STATE OF MISSISSIPPI  
OFFICE OF THE GOVERNOR

---

HALEY BARBOUR  
GOVERNOR

February 4, 2010

Dear Friends:

As Governor of the State of Mississippi, it is my pleasure to welcome you all to the Jackson State University Eighth Annual Mississippi Child Welfare Institute Conference. As in year's past, JSU Annual Mississippi Child Welfare Institute Conference is sure to be a wonderful opportunity to discuss current issues and strategies and to fellowship with old friends and acquaintances.

During this year's conference, I urge you to reflect on the theme: "*Child Welfare: Building Community Partnerships for Safe and Healthy Children and Families*" and consider the good work that the Mississippi Child Welfare Institute does for the community. I commend you for advocating on behalf of one our greatest assets, our children. Mississippi is proud of leaders, like you, who are working to make a difference in the State of Mississippi.

Many thanks are also due to the host and organizers. I applaud their efforts to put on this outstanding event.

Again, thank you for all that you do. Welcome to Mississippi and have a wonderful time!

Sincerely,

A handwritten signature in black ink that reads "Haley Barbour". The signature is fluid and cursive, with a long horizontal stroke at the end.

Haley Barbour

Office of the Mayor  
Harvey Johnson, Jr., Mayor



219 South President Street  
Post Office Box 17  
Jackson, Mississippi 39205-0017  
Telephone: 601-960-1084  
Facsimile: 601-960-2193

Greetings:

On behalf of the citizens of Jackson, I welcome you to the Jackson State University School of Social Work's 8<sup>th</sup> Annual Mississippi Child Welfare Institute Conference.

Strong families are the fabric of any city, and as Mayor, I am proud that this conference focuses on building community partnerships for safe and healthy children and families. I also commend the social work professionals who dedicate their lives to helping others. Without you, many children and families would not have the quality of life that they now enjoy.

Have a great conference, and please know that through your hard work, commitment and dedication, you are making a difference in society.

Sincerely,

A handwritten signature in black ink, appearing to read "H. Johnson", is written over the printed name.

Harvey Johnson, Jr.





**JACKSON STATE UNIVERSITY**  
JACKSON, MISSISSIPPI 39217

OFFICE OF  
THE PRESIDENT

(601) 979-2323  
FAX NO. (601) 979-2948

February 4, 2010

Greetings:

I am pleased to extend a warm Jackson State University welcome to each of you attending the *Eighth Annual Mississippi Child Welfare Institute Conference* sponsored by the University's School of Social Work, College of Public Service. Please know that we appreciate your commitment to enhancing the lives of vulnerable children and families.

The plenary speakers and other presenters are extraordinary for this year's Conference, and you will have an opportunity to engage in a wide range of discussions related to the theme, "*Child Welfare: Building Community Partnerships for Safe and Healthy Children and Families.*" I encourage you to take advantage of the sessions and networking opportunities that will be offered.

I also wish to thank you for choosing Jackson State, and I extend my gratitude to the committee members and volunteers who have expended much time and effort to ensure that the Conference will be a rewarding learning experience for you. If we can assist you in any way during your stay, please do not hesitate to call on us.

Best regards.

Sincerely,

Ronald Mason, Jr.  
President



## JACKSON STATE UNIVERSITY

1400 J.,R. LYNCH STREET, JSU Box 17057, JACKSON, MISSISSIPPI  
39217-0157

THE OFFICE OF PROVOST

PHONE: (601) 979-2931  
FAX: (601) 979-3664

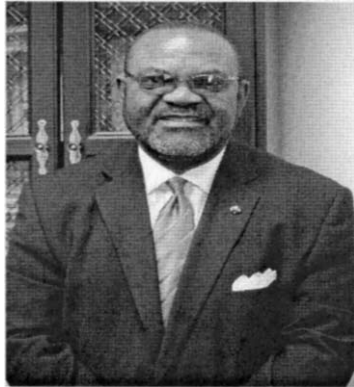

February 4, 2010

Dear Conference Participants:

It gives me great pleasure to welcome each of you to the Eighth Annual Mississippi Child Welfare Institute Conference sponsored by the School of Social Work, College of Public Service. The Conference provides an opportunity for dialogue on current child welfare issues in order to partner and build healthy and safe children and families.

I hope that your participation will be an opportunity for enlightenment and engagement and that you will be well informed at the conclusion of the Conference. The sessions will surely provide you with useful information to assist you in your efforts to make a difference in the lives of the people you serve.

We are glad that you chose to be here and Jackson State University is very pleased to be a part of this notable effort to improve our service to children and families.

Sincerely,

*Felix A. Okojie*

Felix A. Okojie, Ed.D., MPH, CRA  
Provost



# JACKSON STATE UNIVERSITY

## COLLEGE OF PUBLIC SERVICE

### *Office of the Dean*

350 W. Woodrow Wilson Drive • Suite 301 • Jackson, Mississippi 39213-7681  
Telephone: 601-979-8836 • Fax: 601-979-8837 • E-mail: [mario.j.azevedo@jsums.edu](mailto:mario.j.azevedo@jsums.edu)

---



Dear Conference Participants:

It is a great honor for me to welcome you to this conference sponsored by the Mississippi Child Welfare Institute, School of Social Work, in the College of Public Service at Jackson State University. The objective of this conference is for us to focus specifically on the welfare of the children of the State, the nation, and the world. The natural disasters we have witnessed more recently and the almost unprecedented economic crisis we are facing at home and abroad have affected children the hardest in terms of educational opportunities, health, nourishment, personal development, and hope for the future. Most of us at the conference are fortunate and, therefore, can no longer remain indifferent to the considerable odds children face, especially those from underserved minorities in our State.

As Interim Dean of the College of Public Service, I commend Dr. Gwendolyn S. Prater, the College Founding Dean, and her staff, for organizing the conference. I hope this gathering will result in action and contribute to the well-being of the children of our nation directly and the world indirectly. Please enjoy your stay with us and return home better informed and ready to take action. Thank you and best wishes from the faculty, administrators, staff, and students of the College of Public Service.

Sincerely,

*Mario Azevedo*

Mario J. Azevedo, Ph.D., M.P.H.  
College of Public Service

*"Empowering People Through Public Service"*





# Jackson State University

College of Public Service

School of Social Work

*Office of the Associate Dean*

3825 Ridgewood Road, IHL – 102 ♦ Jackson, Mississippi 39211-6497  
Telephone: 601-432-6828 ♦ Fax: 601-432-6812 ♦ E-Mail: [schoolofsw@jsums.edu](mailto:schoolofsw@jsums.edu)

---

February 4, 2010

Dear Conference Participants,

Welcome to the Eighth Annual Mississippi Child Welfare Institute Conference sponsored by the School of Social Work. On behalf of the School, the College of Public Service, its students, staff and administrators, I want to express our deep appreciation for your participation in this event. This annual meeting provides an opportunity for us to exchange ideas and research with colleagues from across the country who are committed to improving the lives of children and families. We meet at a time when our state and the nation face profound economic challenges. These challenges can have important consequences for children and families. We must try even harder to assist families and children through these difficult times.

I want to express my deep appreciation to the conference planning committee for its hard work in preparing this outstanding conference. I extend a special thanks to each conference participant for your support of this annual meeting of child welfare professionals. Enjoy your time with us. May your commitment to serving children and families be strengthened by the knowledge and experience you gain here.

Sincerely,

*Leon W. Chestang*

Leon W. Chestang, PhD  
Interim Associate Dean

# ***MISSISSIPPI CHILD WELFARE INSTITUTE***

JACKSON STATE UNIVERSITY • COLLEGE OF PUBLIC SERVICE • SCHOOL OF SOCIAL WORK  
350 West Woodrow Wilson Drive, Suite 2900B • JACKSON, MISSISSIPPI 39213-7681  
Telephone (601) 979-1123 • Fax (601) 979-1161

---



Dear Conference Participants:

Thank you for joining the Mississippi Child Welfare Institute staff and its partners at our Eighth Annual Conference, which has been planned for you to learn effective strategies and discuss findings designed to improve the lives of children and families in our own State of Mississippi, the nation, and the world. This partnership to improve the life chances for our children and youth comes at an opportune time when unusual, and yes, even unprecedented hardships are confronted with hope and faith by many both here at home and abroad. This speaks to the wonderful resilient human spirit. Thus, our invited plenary speakers, workshop leaders, and research presenters are here to share their knowledge and skills and dialogue with you on the best and promising practices that will enhance the lives of our most precious resource—our children.

Should you need assistance during the Conference, please call on our staff, faculty, and students and we will certainly respond. Again, thank you for your active participation as we continue to expand our knowledge, further crystallize our professional values and ethics, and demonstrate our skills while working together in child welfare to build community partnerships for safe and healthy children and families.

Sincerely,

A handwritten signature in black ink that reads "Gwendolyn S. Prater". The signature is fluid and cursive, with the first letters of the first and last names being capitalized and prominent.

Gwendolyn S. Prater, Director  
and Professor, Social Work and Public Health



JACKSON  
MISSISSIPPI  
Convention & Visitors Bureau

Greetings:

On behalf of the Jackson Convention & Visitors Bureau, it is a pleasure to welcome the *Mississippi Child Welfare Institute Conference* to Jackson, Mississippi.

Jackson promises so much for our visitors and friends. Your members who have not visited in a while will be amazed at the direction that the city has taken in the development arena. Over the past few years, the face of downtown has evolved and is returning to the splendor of yester-year, where the combination mixes of new businesses and residential are abundance once again.

We want to share the Best of the New South and the City with Soul with you while you are here. Please secure time within your schedule to explore your capital city. Enjoy food selections from Southern style to authentic Italian cuisine from over 200 fine restaurants waiting to serve you. Our wonderful attractions coupled with shopping will provide you with hours of enjoyment, entertainment, and education.

Beautiful and gracious, rich in history and culture, Jackson offers hospitality like no other place. You will find in Jackson that our goal is to provide services that will exceed your expectations. We thank you for choosing Jackson to host this year's *Mississippi Child Welfare Institute Conference*.

Sincerely,

Wanda Collier-Wilson  
President CHiI& CEO  
Jackson Convention & Visitors Bureau

## OPENING PLENARY SESSION SPEAKER



**Beverly Black**, PhD, MSSW, is a Professor at the School of Social Work, University of Texas at Arlington. Dr. Black joined the faculty in 2008 to serve as the Director of the MSSW Program. She previously served as the interim associate dean at Wayne State University where she had been a faculty member since 1995. She was also on the social work faculty at Texas Christian University and Florida International University.

Dr. Black conducts research and publishes on issues related to domestic violence, sexual assault, adolescent dating violence, and prevention programming. For several years, she received funding from the State of Michigan to coordinate and evaluate dating violence and sexual assault prevention programs for middle school students in Detroit. She also received funding from the National Institute of Justice to develop programming to prevent dating violence and sexual assault on the campus of Wayne State University. Dr. Black frequently serves as a reviewer for the Centers for Disease Control on violence prevention grant proposals. She has numerous publications on issues related to violence including a book with Dr. Arlene Weisz titled *Programs to Reduce Teen Dating Violence & Sexual Assault: Perspectives on What Work*.

---

## PLENARY SPEAKER



**Dr. Stacy L. Spencer** serves as the Senior Pastor of New Direction Christian Church in Memphis, Tennessee. He is also the Chairman of the Board of Directors for the Power Center CDC, an organization designed to launch a charter school and business/career center, develop youth programming, and teach entrepreneurial basics. During his junior year in college, Dr. Spencer acknowledged his call to ministry and accepted a full-time position as the Youth Minister at St. Stephen Baptist Church in Louisville, Kentucky. He was ordained in 1992 and earned his Master of Divinity degree from the Southern Baptist Theological Seminary in 1993. He created programs, including Rites of Passage, Teen Summit, and an active

Sunday School for St. Stephen Baptist Church. Dr. Spencer is the author of a recently published book on healthy Christian marriage.

Dr. Spencer received his Doctorate of Ministry from Drew University in Madison, New Jersey. He is married to Rhonda Spencer and they are the proud parents of 4 sons: Calvin, Omari, Jordan and Jaden Lynn.

## PLENARY SPEAKERS



**Sixx Nine**, a recording artist, draws inspiration from his childhood through his music. He seeks to positively influence the younger generation by using his life as an example through hip hop. Sixx Nine is the founder and President of Street Reporter, Inc., an organization that he utilizes to promote his musical ambitions to educate child and family welfare advocates and to mentor college students and other at-risk youth.

His entertainment credits include numerous engagements in a variety of venues all over the nation and across all genres and levels in the music industry. Some of his most recent endeavors have focused on empowering the youth and include performances, workshops and seminars at Savannah State University, the Chatham County Department of Family and Children Services, and the Clark-Atlanta University School of Social Work.

Sixx Nine earned a B.S. degree in biology at Georgia College (now Georgia College and State University).

---



**Irma Gibson**, PhD is an Assistant Professor in the Department of Social Work at The Savannah State University. She teaches across the curriculum including a variety of courses on the topics of child and family welfare, social welfare policy, direct practice, social administration, crisis intervention and substance abuse. Dr. Gibson entered the academy after 21 years of direct and indirect social work practice experience with the federal government which primarily included clinical experience. She has also served as a social work administrator assisting the homeless, with mental health issues, addiction, and members of the armed services. Dr. Gibson has presented papers regionally and nationally on service learning and child and family welfare.

Dr. Gibson earned the Bachelor of Science in Sociology from Paine College. She holds an MSW degree from the University of Georgia and earned the PhD in Social Work from Clark-Atlanta University.



## CLOSING LUNCHEON SPEAKER



**Melissa Coleman, LPC**, is the Program Director of an Intensive Outpatient Program for Geriatrics. In 1988, Ms. Coleman was placed in the custody of Mississippi Department of Human Services. She has been in a number of facilities for troubled youth. After graduating from Tougaloo College, Ms. Coleman's personal commitment was to touch every child's life in a positive way, while attempting to erase the hurt of abandonment and rejection. She has worked in a number of facilities that serve youth and families. While in graduate school at Jackson State University she served as a Research Assistant with the Community Health Program. She continued her research activities at the University working with HIV positive population, at risk youth, women in

treatment for drug abuse, and with men that have sex with men. Ms. Coleman has several publications from these studies.

Melissa Coleman is a Licensed Professional Counselor for the State of Mississippi. She received her BA degree in psychology from Tougaloo College and MS in Counseling from Jackson State University.

---

## FIELD EDUCATION SYMPOSIUM SPEAKER

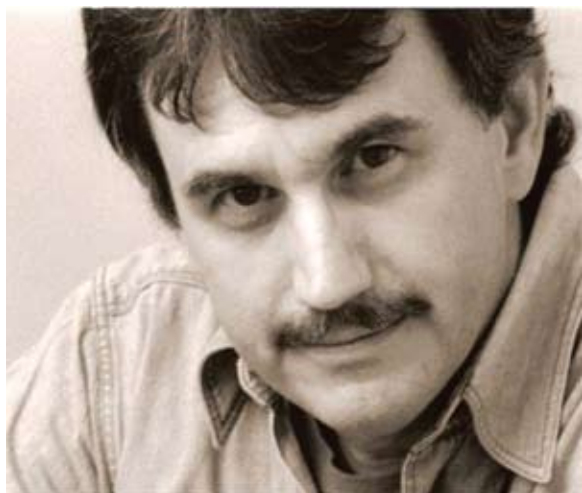

**James Dickerson** is the Director of "You've Got a Friend," a socialization program at Hudspeth Regional Center, funded by a grant from the Mississippi Council on Developmental Disabilities. He also serves as a case manager serving persons with severe disabilities at the facility. Mr. Dickerson is the co-author of two books on adoption: *Basics of Adoption* and *Adoptive and Foster Parent Screening*, and the co-author of a forthcoming textbook *How to Screen Adoptive and Foster Parents*. He has also authored or co-authored 27 books.

Mr. Dickerson has also written social issue editorials for the Clarion-Ledger/Jackson Daily News and The Commercial Appeal in Memphis. He has been featured in numerous magazines and on major radio and television shows--among them, *People*, *The Washington Post*, *The New York Times*, *Los Angeles Times*, *The Boston Globe*, *The Toronto Star*, *Detroit Free-Press*, *New York Post*, CNN, NBC Radio, and Fox & Friends.



## FIELD EDUCATION SYMPOSIUM SPEAKERS



**Taylor R. McGlawn**, MSW, is the President/CEO of MGS, LTD a real estate development, transportation and events coordination firm. He served almost 40 years in social work practice and was the Director of Field Education for 20 years. Mr. McGlawn also taught a variety of courses in policy and planning, gerontology and macro practice. Mr. McGlawn most recently worked with The Every Child Matters Education Fund, Washington, D.C. to establish its first Field Office in Mississippi. He also spearheaded two major statewide initiatives: Step Up for Kids, a children's issue rally at the Mississippi State Capitol and the Mississippi Kids and Youth Convention. Mr. McGlawn has served as President of the Association of Gerontology in Human Development in Historically

Black College and Universities, adjunct professor teaching social welfare policy, federally grants reviewer, and in 2007, became the first male President of the Mississippi Chapter of the National Association of Social Workers.

Mr. McGlawn earned his Bachelor's Degree in Elementary Education, the Social Work Sequence at the University of Mississippi, and the MSW degree in policy and planning at Tulane University, New Orleans, LA.



**Jeanne Wagner**, MSW, LCSW, is a Clinical Assistant Professor and the Director of Field Education Programs at the Helen Bader School of Social Welfare at UWM-Milwaukee. She is a Licensed Clinical Social Worker with extensive clinical, management and administrative experience. Ms. Wagner currently teaches courses in child welfare and develops and presents continuing education programs covering social work ethics and boundaries, management and supervision, and safety in the field. She has worked in a variety of social service settings: child welfare, adoption, mental health, developmental disabilities, geriatrics, AODA, and private practice. In her management role, she has addressed numerous issues related to professional liability and conflicts within programs including staff complaints and a variety of legal matters. Ms. Wagner also has 10

years of experience in Quality Assurance.

**EIGHTH ANNUAL  
MISSISSIPPI CHILD WELFARE INSTITUTE CONFERENCE**

***“Child Welfare: Building Community Partnerships for Safe  
and Healthy Children and Families”***

**Conference Overview**

**Thursday, February 4, 2010**

7:00 a.m. – 8:30 a.m. ....	<b>Registration</b>
8:30 a.m. – 9:45 a.m. ....	<b>Opening Plenary Session</b>
9:45 a.m. – 10:00 a.m. ....	<b>Break</b>
10:00 a.m. – 11:30 a.m. ....	<b>Concurrent Sessions</b>
11:30 a.m. – 1:00 p.m. ....	<b>Lunch on Your Own</b>
1:00 p.m. – 2:15 p.m. ....	<b>Concurrent Sessions</b>
2:15 p.m. – 2:30 p.m. ....	<b>Break</b>
2:30 p.m. – 3:45 p.m. ....	<b>Concurrent Sessions</b>
3:45 p.m. – 4:00 p.m. ....	<b>Break</b>
4:00 p.m. – 5:30 p.m. ....	<b>Plenary</b>
5:30 p.m. – 6:30 p.m. ....	<b>Special Youth Empowerment Session</b>

**Friday, February 5, 2010**

8:30 a.m. – 9:15 a.m. ....	<b>Plenary</b>
9:15 p.m. – 10:15 a.m. ....	<b>Concurrent Sessions</b>
10:15 a.m. – 10:30 a.m. ....	<b>Break</b>
10:30 a.m. – 11:45 a.m. ....	<b>Concurrent Workshops</b>
12:00 p.m. – 1:30 p.m. ....	<b>Closing Luncheon</b>

**EIGHTH ANNUAL  
MISSISSIPPI CHILD WELFARE INSTITUTE CONFERENCE**

***“Child Welfare: Building Community Partnerships for Safe  
and Healthy Children and Families”***

**Sponsored by  
Jackson State University  
College of Public Service, School of Social Work**

**February 4-5, 2010  
Jackson Marriott Hotel  
Jackson, Mississippi**

**Thursday, February 4, 2010  
8:15 a.m. – 5:30 p.m.  
5:30 p.m.-6:30 p.m. Special Youth Empowerment Session**

**Conference Registration  
7:00 a.m. - 5:30 p.m.**

**Exhibits  
8:00 a.m. - 5:30 p.m.**

**OPENING PLENARY SESSION  
Location: Windsor III, IV & V  
8:30 a.m. - 9:45 a.m.**

Presider

**Leon Chestang, PhD**  
Interim Associate Dean  
School of Social Work  
Jackson State University

Greetings

**James Maddirala, PhD**  
Associate Vice President  
Academic Affairs and Student Life  
Jackson State University

**Mario Azevedo, PhD**  
Interim Dean  
College of Public Service  
Jackson State University

**Harvey Johnson**  
Mayor  
City of Jackson

**EIGHTH ANNUAL  
MISSISSIPPI CHILD WELFARE INSTITUTE CONFERENCE**

***“Child Welfare: Building Community Partnerships for Safe  
and Healthy Children and Families”***

**Thursday, February 4, 2010**

**8:30 a.m. – 9:45 a.m.**

**OPENING PLENARY SESSION**

Greetings

**Don Thompson**, Executive Director  
Mississippi Department of Human Services  
Jackson, MS

Introduction of Guest Speaker

**Leon Chestang**, PhD

**Working with Parents and Helping Professionals to  
Respond to Adolescent Dating Violence**

Speaker

**Beverly Black**, PhD  
Professor and Director  
Master of Social Work Program  
University of Texas-Arlington

Remarks

**Gwendolyn Spencer Prater**  
Director, Mississippi Child Welfare Institute  
Professor, Social Work and Public Health  
Schools of Social Work and Health Sciences  
Jackson State University

**9:45 a.m. – 10:00 a.m.**

**BREAK**

**10:00 a.m. – 11:30 a.m.**

**CONCURRENT SESSIONS**

Session I

**Domestic Violence Laws and Resources in Mississippi**

***Room: Churchill I***

The presenter will provide information on state and federal laws applicable to domestic violence, discuss the available resources, and contact information for making appropriate referrals to enhance the delivery of services.

*Presenter: Heather Wagner, JD  
Special Assistant Attorney General  
Director, Domestic Violence Division  
Jackson, MS*

*Moderator: Trenia Allen, LCSW  
Visiting Assistant Professor  
School of Social Work  
Jackson State University*

**EIGHTH ANNUAL  
MISSISSIPPI CHILD WELFARE INSTITUTE CONFERENCE**

***“Child Welfare: Building Community Partnerships for Safe  
and Healthy Children and Families”***

**Thursday, February 4, 2010**

**10:00 a.m. – 11:30 a.m.      CONCURRENT SESSIONS**

**Session II      Shaken Baby Syndrome/Abusive Head Trauma: Response to a Growing Problem**

***Room: Surrey Ballroom***

This presentation provides a dynamic and effective model for community education and abuse prevention. It includes valuable information for caregivers to deal with the frustration of incessant crying.

*Presenter:      Mary Fran Davis, LCSW  
Instructor  
Social Work Department  
Austin Peay University  
Clarksville, TN*

**Child and Adolescent Sibling Abuse: Implications for Child Welfare**

The presenter discusses the results of a study that explored childhood and adolescent abuse on adult survivors' relational experience and self-perception. It highlights the importance of child welfare workers identifying family conditions which may foster sibling abuse.

*Presenter:      Amy Meyers, LCSW  
Doctoral Student  
Hunter College School of Social Work  
City University of New York Graduate Center  
New York, NY*

*Moderator:      Elleeana Perry  
Bachelor of Social Work Student  
Jackson State University*

**EIGHTH ANNUAL  
MISSISSIPPI CHILD WELFARE INSTITUTE CONFERENCE**

***“Child Welfare: Building Community Partnerships for Safe  
and Healthy Children and Families”***

**Thursday, February 4, 2010**

**10:00 a.m. – 11:30 a.m.      CONCURRENT SESSIONS**

Session III      **Mentoring for Success: A Service Learning Partnership with Independent Living Foster Care Youth in Southwest Florida and Undergraduate Social Work Students at Florida Gulf Coast University.**

***Room: Canterbury***

The presenters discuss a collaborative mentoring partnership between the university students and teens in foster care at the Florida Department of Children’s Services.

*Presenter:      Belinda Bruster, PhD, LCSW, ACSW  
Assistant Professor  
Division of Social Work  
Florida Gulf Coast University  
Fort Myers, FL*

*Patricia Coccoma, EdD, LCSW  
Assistant Professor  
Florida Gulf Coast University*

*Moderator:      Jasmine Wilson  
Bachelor of Social Work Student  
Jackson State University*

Session IV      **The Infant Mental Health Assessment: A Review of the American Academy of Child & Adolescent Psychiatry (AACAP) Practice Parameters with Implications for Clinical Social Work Practice in Child Welfare and Maternal Health**

***Room: Winston Ballroom***

This presentation will focus on an analysis of AACAP practice constraints and implications for the mental health assessment of infants and toddlers (0-36 months).

*Presenter:      Halle Ricketts, MSW, LCSW  
Social Services Regional Director/PHRM/ISS Coordinator  
Mississippi State Department of Health  
NW Public Health District 1  
Batesville, MS*

*Moderator:      Sharita Kincaid  
Bachelor of Social Work Student  
Jackson State University*



**EIGHTH ANNUAL  
MISSISSIPPI CHILD WELFARE INSTITUTE CONFERENCE**

***“Child Welfare: Building Community Partnerships for Safe  
and Healthy Children and Families”***

**Thursday, February 4, 2010**

**10:00 a.m. – 11:30 a.m.      CONCURRENT SESSIONS**

**Session V      Building Community Partnerships to Benefit Children: A Student Service Project**

***Room: Churchill II***

Institutions of higher learning have a responsibility to prepare and encourage students to partner with community providers and become service-oriented individuals. An instructor and student discuss a service learning project which was designed to increase students' school attendance.

*Presenter:      Anna Marshall, PhD, LCSW  
Assistant Professor  
School of Social Work  
Jackson State University  
Jackson, MS*

*Samantha James  
Bachelor of Social Work Student  
Jackson State University*

**Mental Health Issues among Children and Youth in Rural Mississippi**

The presenter discusses the findings of a study that explored the effects of bullying on the mental health status of children and youth in rural towns.

*Presenter:      Mohammad Hoque, PhD  
Associate Professor  
Department of Social Work  
Mississippi Valley State University  
Itta Bena, MS*

*Moderator:      Eva Ellis  
Social Work Consultant  
Jackson, MS*

**11:30 a.m. – 1:00 p.m.      LUNCH (on your own)**

**EIGHTH ANNUAL  
MISSISSIPPI CHILD WELFARE INSTITUTE CONFERENCE**

***“Child Welfare: Building Community Partnerships for Safe  
and Healthy Children and Families”***

**Thursday, February 4, 2010**

**11:30 a.m. – 1:00 p.m.      LUNCH (on your own)**

**1:00 p.m. – 2:15 p.m.      CONCURRENT SESSIONS**

**Session VI      Youth Suicide in Mississippi**

***Room: Churchill I***

Youth suicide statistics are alarming for most states. The presentation will address risk and protective factors, signs and symptoms, and current suicide prevention activities.

*Presenter:      Albertstein Johnson-Pickett  
Division Director II, Children and Youth Services  
Mississippi Department of Mental Health  
Jackson, MS*

*Moderator:      Yasma Clark  
Bachelor of Social Work Student  
Jackson State University*

**Session VII      Is the Foster Child Upside Down? Looking at Foster Care from a Constructivist Perspective**

***Room: Canterbury***

Social work has become colonized by evidence-based discourses. This interactive presentation includes pre-recorded personal stories from former foster children. Participants will acquire a greater understanding of personal narratives and use formal assessment instruments as tools to look at the child as a wonderful work of art.

*Presenter:      Vincent Venturini, PhD, LCSW  
Acting Dean  
College of Professional Studies  
Mississippi Valley State University  
Itta Bena, MS*

*Moderator:      Pamela Scott, LMSW  
Adoption Recruiter  
Wendy's Wonderful Kids  
Mississippi Families for Kids  
Jackson, MS*

**EIGHTH ANNUAL  
MISSISSIPPI CHILD WELFARE INSTITUTE CONFERENCE**

***“Child Welfare: Building Community Partnerships for Safe  
and Healthy Children and Families”***

**Thursday, February 4, 2010**

**1:00 p.m. – 2:15 p.m.            CONCURRENT SESSIONS**

**Session VIII    Child Welfare in a Small Village in Honduras: The La Cane Project**

***Room: Churchill II***

This presentation will include findings from a service learning project between a university and a Honduran village which illuminated a number of social issues experienced by the villagers, such as poverty, teen pregnancy, and child abuse.

*Presenter:        Margaret Fontanesi-Seime, PhD  
                         Professor and Field Education Director  
                         Department of Social Work  
                         Middle Tennessee State University  
                         Murfreesboro, TN*

**The Impact of Parental Incarceration on Children**

The number of children in the U.S. with an incarcerated parent has increased by 131%. The presenter provides strategies, interventions, and program models that practitioners can utilize when serving children and families impacted by incarceration.

*Presenter:        Belinda Bruster, PhD, LCSW  
                         Assistant Professor  
                         College of Professional Studies  
                         Division of Social Work  
                         Florida Gulf Coast University  
                         Fort Myers, FL*

*Moderator:      Larry McCook  
                         Bachelor of Social Work Student  
                         Jackson State University*

**EIGHTH ANNUAL  
MISSISSIPPI CHILD WELFARE INSTITUTE CONFERENCE**

***“Child Welfare: Building Community Partnerships for Safe  
and Healthy Children and Families”***

**Thursday, February 4, 2010**

**1:00 p.m. – 2:15 p.m.            CONCURRENT SESSIONS**

**Session IX            Mississippi Youth Programs Around the Clock (MYPAC)**

***Room: Surrey Ballroom***

The presenter provides information on alternate services to traditional psychiatric residential treatment for youth with serious emotional disturbances.

*Presenter:            Bonlitha Windham  
Division Director I, Special Mental Health Initiatives  
Division of Medicaid  
Jackson, MS*

*Moderator:            Lela Hubbard, LMSW  
Mitigation Specialist  
Mississippi Office of Capital Defense  
Jackson, MS*

**Session X            Critical Incident Stress for Child Welfare Workers: What Is It and What Can Be Done**

***Room: Winston Ballroom***

The presenter will report the findings of a research project with child protection workers in Illinois. The workshop will create an awareness of individual and group interventions and highlight steps to prevent critical incident stress.

*Presenter:            Michael Weuste, PhD, LCSW  
Assistant Professor  
Social Work Department  
University of Saint Francis  
Joliet, IL*

*Moderator:            Ashley Williams  
Bachelor of Social Work Student  
Jackson State University*

**EIGHTH ANNUAL  
MISSISSIPPI CHILD WELFARE INSTITUTE CONFERENCE**

***“Child Welfare: Building Community Partnerships for Safe  
and Healthy Children and Families”***

**Thursday, February 4, 2010**

**2:30 p.m. – 3:45 p.m.            CONCURRENT SESSIONS**

**Session XI            Identifying and Reporting Child Maltreatment: Physical and Behavioral Indicators,  
Perpetrator Characteristics, and the Reporting Process**

***Room: Winston Ballroom***

The presenter provides information on the various physical and behavioral indicators a maltreated child may exhibit, perpetrator characteristics, and the process to file a report.

*Presenter:            Shannon Cole Toth  
Family Protection Specialist  
Mississippi Department of Human Services  
Division of Family and Children's Services  
Jackson, MS*

*Moderator:            Kate McMillin  
Director, Prevention Unit  
Mississippi Department of Human Services  
Division of Family and Children's Services  
Jackson, MS*

**Session XII            Critical Issues Facing Grandparents Raising Their Grandchildren: Implications for Social  
Work Education, Practice and Research**

***Room: Churchill I***

The presenter will discuss issues facing grandparents who are raising their grandchildren as well as implications for social workers.

*Presenter:            Susie Spence, PhD  
Professor/Director  
Ph.D. Program  
School of Social Work  
Jackson State University*

*Moderator:            Laurie Lawson, PhD, LCSW  
Assistant Professor  
School of Social Work  
Jackson State University*

**EIGHTH ANNUAL  
MISSISSIPPI CHILD WELFARE INSTITUTE CONFERENCE**

***“Child Welfare: Building Community Partnerships for Safe  
and Healthy Children and Families”***

**Thursday, February 4, 2010**

**2:30 p.m. – 3:45 p.m.            CONCURRENT SESSIONS**

**Session XIII    Leadership and Advocacy: Building Community Partnerships for Healthy Children**

***Room: Surrey Ballroom***

There has been an emergence of community-based services for children due to budget cuts. The presenters highlight community efforts that social workers participating as volunteers and advocates for children can expand to bridge some of the gaps in healthcare and education.

*Presenters:*     *Claire Crawford*  
                      *Student*  
                      *Millsaps College*  
                      *Jackson, MS*

*Leigh Jensen, PhD, LCSW*  
                      *Director*  
                      *Assessment and Testing Services*  
                      *Mississippi State University*  
                      *Mississippi State, MS*

**Child Maltreatment Fatalities: Predictors of Rates and an Evaluation of Legislation Intended to Prevent Future Fatalities**

The rate of child maltreatment fatalities (CMFs) is higher in the U.S. than among other leading nations. This presentation discusses findings of a follow-up study which investigated a relationship among states with higher levels of CMFs media coverage and CMF prevention-oriented legislation.

*Presenter:*     *Emily Douglas, PhD*  
                      *Assistant Professor*  
                      *Department of Social Work*  
                      *Bridgewater State College*  
                      *Bridgewater, MA*

*Moderator:*    *Kira Johnson*  
                      *Social Work Doctoral Student*  
                      *Jackson State University*



**EIGHTH ANNUAL  
MISSISSIPPI CHILD WELFARE INSTITUTE CONFERENCE**

***“Child Welfare: Building Community Partnerships for Safe  
and Healthy Children and Families”***

**Thursday, February 4, 2010**

**2:30 p.m. – 3:45 p.m.            CONCURRENT SESSIONS**

Session XIV    **Increasing High School Retention: A Collaborative Effort between a University  
and a Local School District**

***Room: Churchill II***

The presenters discuss how a local school district instituted a social cognitive framework that provided training activities to equip parents to become effective partners in the education of their children.

*Presenter:            Catherine Singleton-Walker, PhD  
Assistant Professor  
Department of Social Work  
Mississippi Valley State University  
Itta Bena, MS*

*Mary Ross, LMSW  
MSW Field Coordinator  
Department of Social Work  
Mississippi Valley State University*

*Roy Curry  
Deputy Superintendent  
Leflore County Public School District  
Greenwood, MS*

*Moderator:        Elizabeth Taylor  
Bachelor of Social Work Student  
Jackson State University*

**EIGHTH ANNUAL  
MISSISSIPPI CHILD WELFARE INSTITUTE CONFERENCE**

***“Child Welfare: Building Community Partnerships for Safe  
and Healthy Children and Families”***

**Thursday, February 4, 2010**

**2:30 p.m. – 3:45 p.m.                      CONCURRENT SESSIONS**

**Session XV            Children’s Oral Health: An Overlooked Healthcare Dilemma**

***Room: Canterbury***

Tooth decay is the single most common chronic childhood disease. The presentation will describe how the Mississippi Oral Health Community Alliance is building a community partnership to improve oral health for children and families.

*Presenters:            Anna Marshall, PhD, LCSW  
Assistant Professor of Social Work  
Jackson State University  
Jackson, MS*

*Amber Simpson, RDH  
Regional Oral Health Consultant  
Mississippi State Department of Health  
West Central Public Health District V  
Jackson, MS*

*Moderator:           Angela Lambert  
Bachelor of Social Work Student  
Jackson State University*

**3:45 p.m. – 4:00 p.m.                      BREAK**

**4:00 p.m. - 5:30 p.m.                      PLENARY SESSION**

**EIGHTH ANNUAL  
MISSISSIPPI CHILD WELFARE INSTITUTE CONFERENCE**

***“Child Welfare: Building Community Partnerships for Safe  
and Healthy Children and Families”***

**Thursday, February 4, 2010**

**PLENARY SESSION**

Location: Windsor III, IV & V

**4:00 p.m. - 5:30 p.m.**

Presider

**Gwendolyn Winters, MHSA, LSW**  
Adolescent Health Coordinator  
Office of Child and Adolescent Health  
Mississippi State Department of Health  
Jackson, MS

Introduction of Speakers

**Gwendolyn Spencer Prater, PhD**  
Professor and Director  
Mississippi Child Welfare Institute

***A 21st Century Approach to Addressing Child and  
Family Welfare Issues: Thinking Outside the Box with  
Hip Hop Therapy***

Speakers

**Irma Gibson, PhD**  
Assistant Professor  
Department of Social Work  
Savannah State University  
Savannah, GA

***Up Close and Personal with Sixx Nine: Look At Me Now***

**Sixx Nine**  
Hip-Hop Healer  
Macon, GA

**5:30 p.m. – 6:30 p.m.**

**Special Youth Empowerment Session**

**EIGHTH ANNUAL  
MISSISSIPPI CHILD WELFARE INSTITUTE CONFERENCE**

***“Child Welfare: Building Community Partnerships for Safe  
and Healthy Children and Families”***

**Thursday, February 4, 2010**

**SPECIAL YOUTH EMPOWERMENT SESSION**

Location: Windsor III, IV & V

**5:30 p.m. - 6:30 p.m.**

Presider	<b>George Patterson</b> Coordinator of Community Outreach Tougaloo College Tougaloo, MS
Welcome	<b>Laura Lee Lewis</b> Miss Mississippi Outstanding Teen 2009 Student – Brookhaven High School Brookhaven, MS
Panel Discussion	<b>Let’s Really Keep It Real!</b>
Panelists	<b>Todd Williams</b> Hip Hop Recording Artist Rapper Sixx Nine  <b>Laura Lee Lewis</b>  <b>Jimmy Smith</b> Retired NFL Football Player Jacksonville Jaguars Jacksonville, FL  <b>Rapper SmackABatch</b> Hip Hop Mississippi Recording Artist Canton, MS  <b>Albert Sykes</b> Lead Organizer Young People’s Project Jackson, MS

**EIGHTH ANNUAL  
MISSISSIPPI CHILD WELFARE INSTITUTE CONFERENCE**

***“Child Welfare: Building Community Partnerships for Safe  
and Healthy Children and Families”***

**Thursday, February 4, 2010**

**Field Education Symposium**

**1:00 p.m. – 2:15 p.m.                      PANEL DISCUSSION**

**Survival in the Field: Safety in Social Work Practice**

***Room: Newbury***

The panelists will address three major areas of safety in professional social work practice: work environment, client treatment concerns, and personal awareness. Participants will obtain a better understanding of safety preparedness as they engage in daily social work practice.

*Panelists:            James Dickerson  
                         Director, You've Got a Friend  
                         Hudspeth Regional Center  
                         Pearl, MS*

*Taylor McGlawn, MSW  
President and CEO  
McGlawn Services, LTD  
Oxford, MS*

*Jeanne Wagner, MSW, LCSW  
Clinical Assistant Professor/Director of Field Education  
Helen Bader School of Social Welfare  
University of Wisconsin-Milwaukee  
Milwaukee, WI*

*Moderator:        Theresia Ratliff, PhD, LCSW  
                         Assistant Clinical Professor/Director of Field Education  
                         School of Social Work  
                         Jackson State University*

**2:15 p.m. – 2:30 p.m.                      Break**

**2:30 p.m. – 3:45 p.m.                      PANEL DISCUSSION CONTINUED                      (Newbury Room)**

**4:00 p.m. – 5:30 p.m.                      Plenary Session                                              (Windsor III, IV, V)**

**EIGHTH ANNUAL  
MISSISSIPPI CHILD WELFARE INSTITUTE CONFERENCE**

***“Child Welfare: Building Community Partnerships for Safe  
and Healthy Children and Families”***

**Friday, February 5, 2010**

**PLENARY SESSION**

**8:30 a.m. – 9:15 a.m.**

Location: Windsor I & II

Presider	<b>Gwendolyn Spencer Prater, PhD</b> Professor and Director Mississippi Child Welfare Institute Jackson State University
----------	-----------------------------------------------------------------------------------------------------------------------------------

Introduction of Speaker	<b>Portia Ballard Espy</b> Chief Administrative Officer Children’s Defense Fund Southern Regional Office Jackson, MS
-------------------------	----------------------------------------------------------------------------------------------------------------------------------

Speaker	<b>Making Our Children Our Priority---Not Our Prey</b>  <b>Dr. Stacy Spencer</b> Healthy Marriage Specialist Memphis, TN
---------	--------------------------------------------------------------------------------------------------------------------------------------

<b>9:15 a.m. – 10:15 a.m.</b>	<b>CONCURRENT SESSIONS</b>
-------------------------------	----------------------------

Session XVI    **Focus on Fatherhood**

***Room: Winston Ballroom***

This presentation will increase awareness of the nature of fatherlessness and provide information on curriculum-based programs to educate current and future fathers.

*Presenter:     Mark Williams*  
*Fatherhood Coordinator*  
*Mississippi Community Education Center*  
*Jackson, MS*

*Moderator:    Steve Pickering*  
*Program Coordinator*  
*Mississippi Community Education Center*  
*Jackson, MS*

**EIGHTH ANNUAL  
MISSISSIPPI CHILD WELFARE INSTITUTE CONFERENCE**

***“Child Welfare: Building Community Partnerships for Safe  
and Healthy Children and Families”***

**Friday, February 5, 2010**

**9:15 a.m. - 10:15 a.m.      CONCURRENT SESSIONS**

**Session XVII    Therapeutic Management Modalities for the Difficult Adolescent in Group Placement Facilities**

***Room: Churchill II***

The focus of this session is to provide information on how adolescents can control and express their feelings in healthy ways.

*Presenter:      Jessie Chiplin Wright, LPC  
State Opioid Treatment Authority and Private Practitioner  
Mississippi Department of Mental Health  
Bureau of Alcohol and Drug Abuse  
Jackson, MS*

*Moderator:     Regina Curry, LMSW  
Mitigation Specialist  
Mississippi Office of Capital Defense  
Jackson, MS*

**Session XVIII   Foster Care Globally: The Search for Best Practices**

***Room: Churchill I***

A key challenge for child welfare workers is developing guided practice materials that transcend cultural differences and promote best practices for the children served. The presenters will discuss the International Foster Care Organization and the Looking After Children methodology.

*Presenters:     Kathleen Kufeldt, PhD  
Adjunct Professor  
University of Brunswick  
New Brunswick, Canada*

*Myrna McNitt, ACSW  
Lecturer  
Graduate School of Social Work  
Dominican University  
River Forest, IL*

*Moderator:     Dornette Thompson  
Master of Social Work Student  
Jackson State University*

**EIGHTH ANNUAL  
MISSISSIPPI CHILD WELFARE INSTITUTE CONFERENCE**

***“Child Welfare: Building Community Partnerships for Safe  
and Healthy Children and Families”***

**Friday, February 5, 2010**

**9:15 a.m. – 10:15 a.m.      CONCURRENT SESSIONS**

**Session XIX      Citizen Review Panels: Little-known Leverage for System Improvement**

***Room: Newbury***

Citizen Review Panels have a prominent statutory role in overseeing the operation of public child welfare systems. The presentation reviews this role and considers the potential impact of recently proposed changes to Mississippi’s citizen review panels.

*Presenter:      Michael Forster, PhD  
Dean and Professor of Social Work  
College of Health  
University of Southern Mississippi  
Hattiesburg, MS*

*Moderator:      Velma Hankins  
Social Work Consultant  
Canton, MS*

**Session XX      Managing for Excellence: Supervisory Skills Development**

***Room: Surrey Ballroom***

Since supervision affects both job satisfaction and client progress, it is essential for social workers to hone their supervision skills. Employing an interactive approach, the presenter will share information, strategies, and address targeted areas for ongoing growth.

*Presenter:      Monique Busch, PhD, ACSW, LCSW  
Senior Director, Community Operations  
Lutheran Child and Family Services  
Indianapolis, IN*

*Moderator:      Brittney Johns, LMSW  
Adoption Director  
Mississippi Families for Kids  
Jackson, MS*



**EIGHTH ANNUAL  
MISSISSIPPI CHILD WELFARE INSTITUTE CONFERENCE**

***“Child Welfare: Building Community Partnerships for Safe  
and Healthy Children and Families”***

**Friday, February 5, 2010**

**9:15 a.m. – 10:15 a.m.      CONCURRENT SESSIONS**

**Session XXI      The Foster Care and Adoption Experience: Perspectives and Reflections**

***Room: Canterbury***

The session will include presentations by adult-adopted and foster children and an adoptive parent. Panelists will share reflections of their experiences in the formal system of care and other support systems. They will conclude with their own perspectives on best and promising practices in the field.

*Presenters:      Tameika Foreman  
MSW Consultant/Coach  
Middle Tennessee State University  
Murfreesboro, TN*

*Martha Gill  
Foster and Adoptive Parent  
Leader, Rankin County Foster and Adoptive Parent Support Group  
Brandon, MS*

*David Williams, MD  
Medical Care Associates, PA  
Jackson, MS*

*Moderator:      Gwendolyn Spencer Prater, PhD  
Director  
Mississippi Child Welfare Institute*

**10:15 a.m. – 10:30 a.m.      BREAK**

**EIGHTH ANNUAL  
MISSISSIPPI CHILD WELFARE INSTITUTE CONFERENCE**

***“Child Welfare: Building Community Partnerships for Safe  
and Healthy Children and Families”***

**Friday, February 5, 2010**

**10:30 a.m. - 11:45 a.m.      CONCURRENT SESSION**

**Session XXII    The Cultural Genogram: An Experiential Tool for Child Welfare Professionals**

**Room: Winston Ballroom**

This experiential workshop will demonstrate how the cultural genogram can be used by practitioners as a tool for promoting cultural awareness and sensitivity to meet the service needs of diverse ethnic and cultural individuals and families.

*Presenter:      Bryan Warde, PhD, LCSW  
Assistant Professor  
Social Work Department  
Lehman College/City University of New York  
Bronx, NY*

*Moderator:     Mackey Wright  
Master of Social Work Student  
Jackson State University*

**Session XXIII    The Impact of Trauma on Academic Attainment of University Students**

**Room: Canterbury**

Research indicates there is a link between children's trauma experience and school performance. The presenters discuss findings of a study that examined university students' attainment post-Hurricane Katrina.

*Presenters:     Carolyn Hester, PhD  
Assistant Professor/Director of Field Education  
School of Social Work  
Grambling State University  
Grambling, LA*

*Tom Osowski, PhD  
Assistant Professor  
School of Social Work  
University of Southern Mississippi-Gulf Coast  
Long Beach, MS*

*Moderator:     Delilah Spriggs  
Bachelor of Social Work Student  
Jackson State University*

**EIGHTH ANNUAL  
MISSISSIPPI CHILD WELFARE INSTITUTE CONFERENCE**

***“Child Welfare: Building Community Partnerships for Safe  
and Healthy Children and Families”***

**Friday, February 5, 2010**

**10:30 a.m. – 11:45 a.m.      CONCURRENT SESSIONS**

**Session XXIV    Grief and Foster Parents: An Issue Affecting Retention**

**Room: Surrey Ballroom**

The presenters discuss their findings of a study that examined the grief foster parents experience when a child is removed from their care.

*Presenters:      Corie Hebert, PhD, ACSW  
Assistant Professor  
Department of Counseling and Human Development  
Southeastern Louisiana University  
Hammond, LA*

*Heidi Kulkin, PhD, LCSW  
Associate Professor and Program Coordinator  
Department of Counseling and Human Development  
Southeastern Louisiana University*

*Moderator:      Cheronda Rutherford  
Bachelor of Social Work Student  
Jackson State University*

**Session XXV    Foster Care Globally: The Search for Best Practice**

**Room: Churchill I**

A key challenge for child welfare workers is developing guided practice materials that transcend cultural differences and promote best practice for the children served. The presenters discuss the International Foster Care Organization and the Looking After Children methodology.

*Presenters:      Kathleen Kufeldt, PhD  
Adjunct Professor  
University of Brunswick  
New Brunswick, Canada*

*Myrna McNitt, ACSW  
Lecturer, Graduate School of Social Work  
Dominican University  
River Forest, IL*

*Moderator:      Paula Pendleton  
Bachelor of Social Work Student  
Jackson State University*

**EIGHTH ANNUAL  
MISSISSIPPI CHILD WELFARE INSTITUTE CONFERENCE**

***“Child Welfare: Building Community Partnerships for Safe  
and Healthy Children and Families”***

**Friday, February 5, 2010**

**CLOSING LUNCHEON**

Location: Windsor I & II

**12:00 p.m. – 1:30 p.m.**

Presider	<b>Gwendolyn Spencer Prater, PhD</b> Director Mississippi Child Welfare Institute
Greetings	<b>Ronald Mason, Jr.</b> President Jackson State University
Entertainment	<b>Latonya Polk</b> Master of Social Work Student Jackson State University
Invocation	<b>Reverend Sue Cherney</b> Executive Director Southern Christian Services Jackson, MS
Introduction of Speaker	<b>Theresa Ratliff, PhD, LCSW</b> Assistant Clinical Professor/Director of Field Education School of Social Work Jackson State University
Speaker	<b>Melissa Coleman, LPC</b> Program Director Intensive Outpatient Program for Geriatrics Health Management Associates Jackson, MS
Entertainment	<b>Latonya Polk</b>
Presentation of Awards and Closing Remarks	<b>Gwendolyn Spencer Prater</b>

**EIGHTH ANNUAL  
MISSISSIPPI CHILD WELFARE INSTITUTE CONFERENCE**

***“Child Welfare: Building Community Partnerships for Safe  
and Healthy Children and Families”***

**Exhibitors**

**Baptist Children’s Village  
Children’s Defense Fund  
Jackson State University – College of Public Service  
School of Policy and Planning  
*Department of Urban and Regional Planning*  
School of Social Work  
Mississippi Attorney General’s Office  
*Crime Prevention and Victim Services*  
Mississippi Challenge Academy  
Mississippi State Department of Health  
*Office of Child/Adolescent Health*  
Mississippi State Department of Health  
*Oral Health Program*  
Mississippi State Department of Mental Health  
*Bureau of Alcohol and Drug Abuse*  
Mississippi Department of Human Services  
*Division of Family and Children’s Services*  
Mississippi Department of Human Services  
*Division of Family and Children’s Services (Marion County)*  
Mississippi Department of Human Services  
*Foundation for Families*  
Mississippi Families for Kids  
Parkwood Behavioral Health Systems  
Social Work p.r.n.  
Southern Christian Services for Children and Youth**

**EIGHTH ANNUAL  
MISSISSIPPI CHILD WELFARE INSTITUTE CONFERENCE**

***“Child Welfare: Building Community Partnerships for Safe  
and Healthy Children and Families”***

**Program Planning Committee**

Dr. Gwendolyn Spencer Prater, Chair – Jackson State University  
Dr. Leon W. Chestang, Ex-Officio – Jackson State University  
Mrs. Shirley Banks – Jackson State University  
Mrs. Jean Brooks – Jackson State University  
Dr. Ike Burson – Jackson State University  
Dr. Christopher Curtis – Jackson State University  
Mrs. Adriane Dorsey-Kidd – Jackson State University  
Ms. Eva Ellis – Social Work Consultant  
Mrs. Portia Ballard Espy – Children’s Defense Fund  
Mr. Marty Fortenberry, MSW Student- Jackson State University  
Mrs. Fannie Greer – Jackson State University  
Mrs. Phyllis Hammond – Jackson State University  
Ms. Velma Hankins – Social Work Consultant  
Ms. Eunice Harris, Co-Chair – Jackson State University  
Ms. Eunetta Hart – Jackson State University  
Mrs. Kira Johnson – Social Work Doctoral Student, Jackson State University  
Dr. Anna Marshall – Jackson State University  
Attorney Patty Marshall – Mississippi Attorney General’s Office  
Mrs. Carol Blackmon McInnis – Jackson Convention and Visitors Bureau  
Mrs. Kate McMillin – Mississippi Department of Human Services  
Dr. Theresia Ratliff, Co-Chair – Jackson State University  
Mrs. Betty Reed – Jackson State University  
Ms. Gwendolyn Winters – Mississippi Department of Health  
Mrs. Jessie Chiplin Wright – Mississippi Department of Mental Health  
Mr. Mackey Wright, MSW Student – Jackson State University

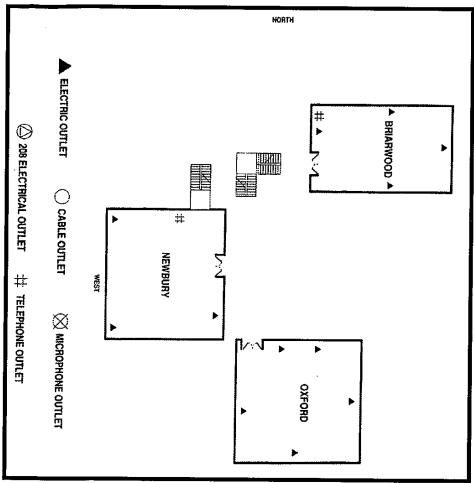
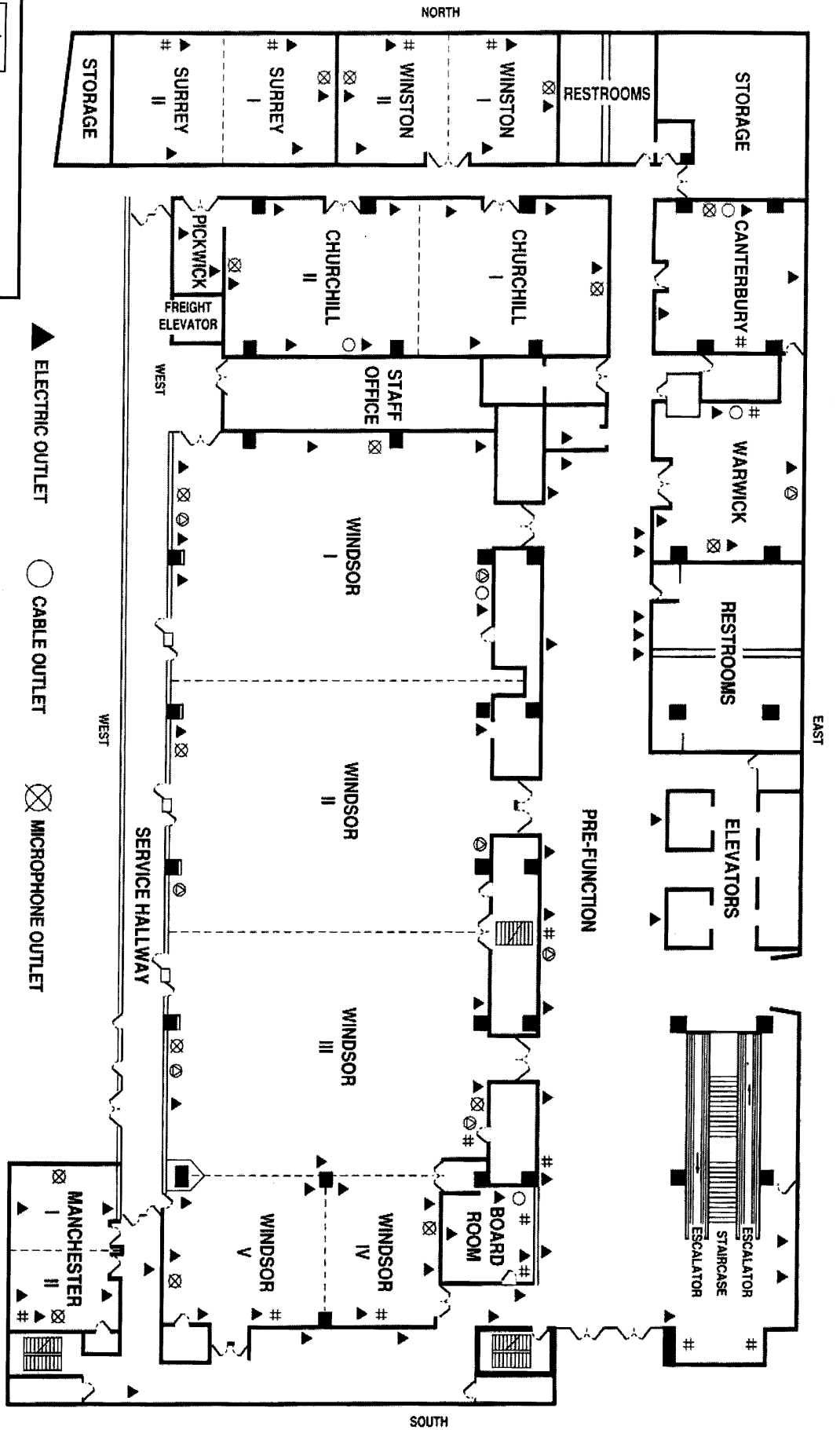

**Marriott**  
JACKSON

200 E. Amite Street  
Jackson, MS 39201  
601-969-5100  
[www.marriott.com/janmc](http://www.marriott.com/janmc)

## NOTES



**CONGRATULATIONS**  
**to the**  
**School of Social Work**  
**on its**  
**Eighth Annual**  
**Mississippi Child Welfare Institute Conference**  
**Jackson State University**



**College of Public Service**  
(601) 979.8836  
<http://www.cps.jsu.edu>  
**Dr. Mario J. Azevedo, Interim Dean**

**School of Policy and Planning**  
(601) 432.6865  
Website: <http://www.cps.jsu.edu>  
Urban and Regional Planning (601) 432.6865 – M.A. & Ph.D. Degrees  
Urban Studies (601) 432.6865 – B.A. Degree  
Public Policy & Administration (601) 432.6368 – M.P.P.A. & Ph.D. Degrees

**School of Health Sciences**  
(601) 979.8806  
Website: <http://www.cps.jsu.edu>  
Communicative Disorders (601) 432.6717 – B.S. and M.S. Degrees  
Epidemiology and Biostatistics (601) 979.8789 – M.P.H. & Dr.P.H. Degrees  
Health Policy and Management (601) 979.8826 – M.P.H. & Dr.P.H. Degrees  
and Health Care Administration – B.S. Degree  
Behavioral and Environmental Health (601) 979.1143 – M.P.H. & Dr.P.H. Degrees

**School of Social Work**  
(601) 432.6828  
Website: <http://www.cps.jsu.edu>  
Social Work (601) 432.6811 - Ph.D. Degree  
Social Work (601) 432.6819 – M.S.W. Degree  
Social Work (601) 979.2631 – B.S.W. Degree

**MARK YOUR CALENDAR  
FOR**

**JACKSON STATE UNIVERSITY**



**2011  
Mississippi Child  
Welfare Institute  
Conference**

**MARRIOTT HOTEL  
JACKSON, MS**

**FEBRUARY 17-18, 2011**