



Twelfth Annual

Mississippi Child Welfare Institute Conference

February 12-14, 2014

“Child Welfare: Building Multi-Generational Teams to Serve Families and Communities”



JSU | JACKSON STATE UNIVERSITY®
1877

College of Public Service
School of Social Work

JACKSON MARRIOTT HOTEL, 200 EAST AMITE STREET
JACKSON, MS 39201



**TWELFTH ANNUAL
MISSISSIPPI CHILD WELFARE INSTITUTE CONFERENCE**

***“Child Welfare: Building Multi-Generational Teams to Serve Families and
Communities”***

**Sponsored by
School of Social Work
College of Public Service
Mississippi Child Welfare Institute**

**Special Appreciation
Casey Family Programs
Seattle, WA**

Partners

Gold

**Mississippi Department of Human Services
Division of Family and Children’s Services
Mississippi Department of Human Services
*Children’s Trust Fund***

Silver
C-Spire

Bronze

**Mississippi State Department of Mental Health
Division of Children and Youth Services
Mississippi State Department of Mental Health
*Bureau of Alcohol and Drug Services***

Copper

**Another Chance Enterprise
Catholic Charities
Jackson Medical Mall Foundation
Mississippi State Department of Health
Office of Preventive Health
Mississippi State Department of Health
*Early Intervention Program***

The 2014 Mississippi Child Welfare Institute Conference offers a maximum of 11
Continuing Education Hours (CEHs).

BENNIE G. THOMPSON
SECOND DISTRICT, MISSISSIPPI

COMMITTEE ON
HOMELAND SECURITY
RANKING MEMBER

WASHINGTON OFFICE:
2466 RAYBURN HOUSE OFFICE BUILDING
WASHINGTON, DC 20515-2402
(202) 225-5876
(202) 225-5898: FAX

E-Mail: benniethompson@mail.house.gov
Home Page: <http://www.benniethompson.house.gov>

CONGRESSIONAL BLACK CAUCUS
CONGRESSIONAL GAMING CAUCUS
CONGRESSIONAL PROGRESSIVE CAUCUS
CONGRESSIONAL SPORTSMEN'S CAUCUS
CONGRESSIONAL RURAL CAUCUS
HOUSE EDUCATION CAUCUS

Congress of the United States
House of Representatives
Washington, DC 20515-2402

February 12, 2014

Jackson State University
College of Public Service
School of Social Work
3825 Ridgewood Road, ILH-103
Jackson, MS 39211

Dear Friends:

It gives me great pleasure to bring you greetings from Mississippi's Second Congressional District during the Twelfth Annual Mississippi Child Welfare Institute Conference. I salute the School of Social Work for the great work in raising awareness about child welfare issues.

I am honored to play a small part in this year's conference as you encourage and advocate community engagement. This year's theme, "Child Welfare: Building Multigenerational Teams to Serve Families and Communities", is indeed a relevant component in forging a role for each generation in order to build a sound foundation for the continued growth of the family unit. It is clear that in our mission must include multigenerational team building.

I applaud your dedication and commitment in keeping the welfare of children and families at the forefront of the public debate as we seek to create sound public policy. Please know that you are making a difference in dispensing good information and creating necessary dialogue through your yearly conferences. I am confident that you will renew and rededicate yourself to this ongoing fight to keep our children, families and communities safe and healthy.

You have my best wishes for a successful and engaging conference this year. **Keep the Faith!**

Sincerely,



Bennie G. Thompson
Member of Congress

107 WEST MADISON STREET
P.O. Box 610
BOLTON, MS 39041
(601) 866-9003
(601) 866-9036: FAX
(800) 355-9003: IN ST.

509 HIGHWAY 82 WEST
GREENWOOD, MS 38930
(662) 455-9003
(662) 453-0118: FAX

910 COURTHOUSE LANE
GREENVILLE, MS 38701
(662) 335-9003
(662) 334-1304: FAX

3607 MEDGAR EVERS BOULEVARD
JACKSON, MS 39213
(601) 946-9003
(601) 982-5337: FAX

263 EAST MAIN STREET
P.O. Box 356
MARKS, MS 38646
(662) 326-9003
(662) 326-9003: FAX

MOUND BAYOU CITY HALL
P.O. Box 679
106 GREEN AVENUE, SUITE 106
MOUND BAYOU, MS 38762
(662) 741-9003
(662) 741-9002: FAX



PHIL BRYANT
GOVERNOR

February 12, 2014

Dear Friends:

As Governor of the State of Mississippi, I am pleased to welcome you to the Jackson State University School of Social Work Twelfth Annual Mississippi Child Welfare Institute Conference. It is my pleasure to welcome our visitors to the beautiful City of Jackson, the capital of this great State of Mississippi.

As you reflect on this year's theme, "Child Welfare: Building Multigenerational Teams to Serve Families and Communities," I urge you to consider the work done by the Jackson State University School of Social Work and the Mississippi Child Welfare Institute. I commend your faithfulness and commitment to promoting the importance of awareness for the welfare of children, one of our greatest treasures. Mississippi is proud of leaders, like you, that are working to make a difference in the State of Mississippi and improve the quality of life for our citizens.

Many thanks are also due to the host and organizers. I applaud their efforts to put on this outstanding meeting.

Again, welcome to the Jackson State University School of Social Work Twelfth Annual Mississippi Child Welfare Institute Conference and best wishes for many more to come.

Sincerely,

A handwritten signature in black ink that reads "Phil Bryant".

Phil Bryant
GOVERNOR

STATE OF MISSISSIPPI • OFFICE OF THE GOVERNOR

POST OFFICE BOX 139 • JACKSON, MISSISSIPPI 39205 • TELEPHONE: (601) 359-3150 • FAX: (601) 359-3741 • www.governorbryant.com

Office of the Mayor
Chokwe Lumumba, Mayor



219 South President Street
Post Office Box 17
Jackson, Mississippi 39205-0017
Telephone: 601-960-1084
Facsimile: 601-960-2193

February 12, 2014

Greetings:

On behalf of the citizens of Jackson, I welcome you to Jackson State University School of Social Work's 12th Annual Mississippi Child Welfare Institute Conference.

Strong families are the foundation of a strong city. I am proud that this conference focuses on building community partnerships for safe and healthy children and families. I also commend the social work professionals who dedicate their lives to helping others. Without you, many children and families would not have the quality of life that they now enjoy. Please continue all of your phenomenal works.

I know that you will gain a lot of valuable information during this conference, and I trust that everyone will have a great time. For those of you visiting, I trust that you will find Jackson to be very hospitable and accommodating. I encourage you to get out and take advantage of some of the fabulous shopping, dining and sightseeing opportunities available in our City.

Sincerely,

A handwritten signature in cursive script, appearing to read "Chokwe Lumumba".

Chokwe Lumumba
Mayor



JACKSON STATE UNIVERSITY
JACKSON, MISSISSIPPI 39217

OFFICE OF
THE PRESIDENT

(601) 979-2323
FAX No. (601) 979-2948

February 12, 2014

Dear Conference Participants:

It is indeed my pleasure to welcome you to Jackson State University and its Twelfth Annual Mississippi Child Welfare Institute Conference sponsored by the School of Social Work, College of Public Service. The theme for this year, *"Child Welfare: Building Multi-Generational Teams to Serve Families and Communities,"* is an excellent choice as Jackson State University advances its educational, research, and service initiatives with local, state, national, and global partners. We are delighted that you are participating in our conference as we work together to improve the quality of life for our children, youth, and families.

The extraordinary plenary speakers and other presenters for this year's conference will address a number of topics, providing you with an opportunity for meaningful engagement to share knowledge and skills. I invite you to take advantage of the educational and network opportunities including the many meaningful discussions toward best and promising practices for use in your work with vulnerable children and families.

I also wish to thank you for selecting Jackson State, and I extend my gratitude to the committee members and volunteers who have expended much time and effort to ensure a successful conference and that you will have a rewarding learning experience. If we can assist you in any way during your stay, please do not hesitate to call on us.

Sincerely,

A handwritten signature in cursive script that reads "Carolyn W. Meyers".

Carolyn W. Meyers
President



February 12, 2014

Dear Conference Participants:

Greetings from the Division of Academic Affairs at Jackson State University. I am delighted that you have chosen to join our faculty, students, and community partners to pursue the all important goal of improving the lives of vulnerable children, youth and families in your local community, the State of Mississippi, our country, and the world. The 12th Annual Mississippi Child Welfare Institute Conference marks another beginning for faculty, students and staff development in research, practice initiatives and policy imperatives. This year's theme, "*Child Welfare: Building Multi-Generational Teams to Serve Families and Communities,*" is a testament of our commitment to support families and communities in their efforts to ensure our children's successful journey through childhood and adolescence.

The plenary and workshop presenters for this year's conference are exceptional, and you will have an opportunity to be involved in discussions on a wide range of topics in advancing our work. As a fellow professional social worker, I greatly admire and deeply appreciate your commitment to providing quality services in our society. I encourage you to take advantage of the research, practice, and policy sessions and the networking opportunities that will be offered.

The committee members and volunteers are appreciated for their time and effort to ensure that the conference is successful. Please continue your work with us and in your respective neighborhoods to create caring communities that are action oriented, with the ultimate goal of enhanced health, well-being, and safety for all of our children, youth and families.

Sincerely,

A handwritten signature in cursive script that reads "James C. Renick".

James C. Renick, Ph.D.
Provost



February 12, 2014

Dear Conference Participants:

It is my distinct pleasure to welcome you to the Twelfth Annual Mississippi Child Welfare Institute Conference sponsored by the School of Social Work in the College of Public Service at Jackson State University. As Dean of the College, I appreciate your commitment to serving vulnerable children and families in our communities. I encourage you to engage with the outstanding keynote speakers and other presenters at the conference to explore best practices and policies and their effective implementation. This year, we continue our faculty, student, and staff development activities in the forms of research, practice initiatives, and policy imperatives. Our conference theme, *“Child Welfare: Building Multi-*

Generational Teams to Serve Families and Communities,” illustrates our support of children in various types of family structures. As we are aware, it takes a village to raise a child and we are very pleased that you have joined with us to celebrate families’ strengths and resilience across generations.

The extraordinary plenary speakers and various workshop and paper presenters for this year’s conference provide you with a special opportunity to be involved in discussions covering a broad range of topics in child and family welfare. I encourage you to engage in the knowledge and skill-building presentations and networking opportunities for purposes of enhancing your work with vulnerable children and families.

I also wish to thank the conference chairs, committee members, and volunteers who have expended much time and effort to ensure that the conference is a rewarding learning experience for each of you. The College is pleased to be a part of this notable effort to enhance services to children and families, and we greatly appreciate your decision to join us.

Best regards,

A handwritten signature in black ink, appearing to read "Ricardo A. Brown". The signature is fluid and cursive.

Ricardo A. Brown, Ph.D.
Dean and Professor



School of Social Work
3825 Ridgewood Road | P.O. Box 17400
Jackson, MS 39211
601.432-6828 | 601.432-6827 fax
jsu.ms.edu

February 13, 2014

Dear Conference Participants,

Welcome to the Twelfth Annual Mississippi Child Welfare Institute Conference sponsored by the School of Social Work. On behalf of the School, the College of Public Service, its students, faculty, staff and administrators, I want to express our deep appreciation for your participation in this event. This annual meeting provides an opportunity for us to exchange ideas and research with colleagues from across the country who are committed to improving the lives of children and families.

I want to express my sincere gratitude to the conference planning committee for its hard work in preparing this outstanding conference. I extend a special thanks to each conference participant for your support of this annual meeting of child welfare professionals. Enjoy your time with us. May your commitment to serving children and families be strengthened by the knowledge and experience you gain here.

Sincerely,

Leon W. Chestang

Leon W. Chestang, Ph.D.
Executive Director



February 12, 2014

Dear Conference Participants:

It is indeed our pleasure to welcome you to the Twelfth Annual Mississippi Child Welfare Institute Conference! Each year, we select a cadre of the best local, state, and nationally recognized speakers to share their practice strategies, research findings, and policy imperatives to enhance our work with children and families. The theme this year, *“Child Welfare: Building Multi-Generational Teams to Serve Families and Communities,”* focuses on our recommitment to valuing diverse family types, the use of knowledge across disciplines and areas of practice, and the need to improve community-based service delivery across generations. You are invited to continue the journey with us to make a positive difference in the lives of vulnerable children, youth and families in communities across the state, country, and world.

The Mississippi Child Welfare Institute Conference Planning Committee has diligently pursued the goals of health and safety, well-being, and permanency for all children as the basis for conference presentations, discussions and deliberations. The activities of the Committee have guaranteed that you have the opportunity to use research and evidence-based practice to inform your work. We applaud you, the social workers and other professionals, who take the time and make the effort to expand your knowledge, advance your professional values and ethics, and enhance your skills to engage, across disciplines, to best serve our children, youth, families, and communities. We are delighted that you have chosen to participate with us as we work together to serve the rainbow of children and families in our communities.

Sincerely,

A handwritten signature in black ink that reads "Gwendolyn S. Prater". The signature is fluid and cursive.

Gwendolyn Spencer Prater, Ph.D.
Dean Emerita and Consultant

A handwritten signature in black ink that reads "Theresia J. Ratliff". The signature is fluid and cursive.

Theresia J. Ratliff, Ph.D.
Interim Director

MISSISSIPPI CHILD WELFARE INSTITUTE AND CONFERENCE HISTORY

The Mississippi Child Welfare Institute was established at Jackson State University in 2003 as a part of the School of Social Work. The impetus to begin the Institute emanated from a grant awarded by the Children's Bureau, U.S. Department of Health and Human Services during the 2000 to 2004 period. The proposal was developed by Gwendolyn Spencer Prater, PhD, MSW, who was then Dean of the School of Social Work. The Institute and conference began prior to the organization of the academic colleges at Jackson State University.

The proposal submitted to the Children's Bureau resulted in a funded grant which permitted 26 committee-selected and dedicated students to participate in the education project. All of the social work students were provided tuition, stipends, and special training and educational opportunities both in-state and across the country at national conferences with the goal of preparing them for careers in child welfare. The students graduated and many attained social work positions in the field of child welfare. Mrs. Wanda Gilliam, MSW, Deputy Director of Programs, Mississippi Department of Human Services, was the liaison with the School of Social Work during the grant period and actively and successfully facilitated productive experiential educational opportunities for students with the Division of Family and Children's Services.

During the 2002-2003 academic year, Jackson State University's School of Social Work, in partnership with other state institutions of higher learning, and the Mississippi State Department of Human Services, under the capable leadership of Mrs. Thelma Brittain, MSW, initiated the Title IV-E Program in Child Welfare. The program was readily supported by the Mississippi Legislature, with strong leadership from the late Representative Charlie Capp, Chair of the House Appropriations Committee. Jackson State University's administration also provided strong support for the Institute and the conference. The School of Social Work programmatic and administrative leadership team included Drs. Prater and Ruth M. Williams as the Principal Investigator and Co-Principal Investigator, respectively, and Ms. Velma Hankins, MSW, as the Program Administrator.

The program continued for approximately three and one-half years, with Jackson State University serving as the lead institution for the majority of that period, with the final program year being rotated to one of the other state institutions of higher education. Numerous students at the baccalaureate and master's levels were educated and provided training for child welfare practice with vulnerable populations. In addition, during that three-year period, training was also developed and provided for foster and adoptive parents and public child welfare staff. Since that time, there has not been a consortium of state schools and programs of social work jointly engaged in Title IV-E academic programming with the Mississippi Department of Human Services.

The Mississippi Child Welfare Institute at Jackson State University, however, continues to offer its annual conference for professional development of child welfare practitioners, supervisors, administrators, faculty, and students in Mississippi, other states in the Southeastern Region, and indeed across the United States of America. The Institute partners with public and private agencies and organizations as it works to improve services to children and families including but not limited to: the Mississippi State Departments of Human Services, Health, and Mental Health, the Children's Defense Fund (Southern Regional Office), Mississippi Children's Home Services and CARES Center, Catholic Charities, and the Casey Family Programs and Marguerite Casey Foundations.

Conferences (2003-2013):

*2003: Social Workers' Challenge: Changing the Lives of Mississippi's Children and Families**

2004: Mississippi's Challenge: Rebuilding the Village

2005: Social Work: Empowering Mississippi's Children and Families through Public Service^

2006: Working Together for What Matters Most: Children and Families

2007: United Voices Committed to Helping Our Children

2008: The Many Faces of Child Welfare: A Rainbow of Diversity

2009: Child Poverty: Facing the Challenges, Creating Opportunities

2010: Child Welfare: Building Community Partnerships for Safe and Healthy Children and Families

2011: Building Community Partnerships for Safe and Healthy Children and Families

2012: Building Bridges for a New Decade of Transformational Services with Children and Families

2013: Community Engagement: A Guiding Light to Successful Children, Youth and Families.

Note: All conferences have been held in Downtown Jackson;

**Crowne Plaza Hotel (2003-2004)*

^Jackson Marriott Hotel (2005-2013)

OPENING PLENARY SPEAKER



Crystal Collins-Camargo, M.S.W., Ph.D. is Associate Professor of Social Work, University of Louisville, Kent School of Social Work. She is currently Training Resource Center Associate Director for Research and Educational Programs and Director, National Quality Improvement Center on the Privatization of Child Welfare Services. She is the former Director of Programs and Prevention Services, Prevent Child Abuse Kentucky. Dr. Collins Camargo has also served as Child Protective Services Program Specialist and Family Services Office Supervisor.



Michael A. Lindsey, Ph.D., M.S.W., M.P.H., is an associate professor at the Silver School of Social Work, New York University. He has published extensively on help-seeking behaviors of urban youth and taught courses on evidence-based practices and innovations in school mental health and is a standing member of the NIMH SERV study section. Dr. Lindsay earned his M.S.W. degree at Howard University and the M.P.H. and Ph.D. at the University of Pittsburgh. He was a postdoctoral fellow at John Hopkins University's Bloomberg School of Public Health.



Paolo del Vecchio, M.S.W., is the Director of the Substance Abuse and Mental Health Services Administration's (SAMHSA) Center for Mental Health Services (CMHS). SAMHSA is the lead Federal agency designed to reduce the impact of substance abuse and mental illness on America's communities. Previously, he was the CMHS Associate Director for Consumer Affairs where he managed SAMHSA's precedent-setting activities in addressing consumer participation and education, issues of discrimination and stigma, consumer rights, wellness, recovery, trauma, and others. A self-identified mental health consumer, trauma survivor, and person in recovery from addictions, Mr. Vecchio has been involved for over 40 years in behavioral health as a consumer, family member, provider, advocate, and policy maker. He graduated summa cum laude with a master's degree in social work from Temple University, has published widely and is a highly sought after national and international speaker. He has been a leader in many Federal efforts including the Mental Health Statistics Improvement Project Ad-Hoc Advisory Committee, the Federal Advisory Planning Board for the Surgeon General's Report on Mental Health, the HHS Multiple Chronic Conditions and Community Living Initiatives, and numerous others.

PLENARY SPEAKER



Scarlett Lewis' son, Jesse, lost his life at Sandy Hook School on December 14, 2012. Inspired by the words Jesse had written on their kitchen chalkboard: Nurturing, Healing and Love, part of a definition of compassion across almost all cultures, Scarlett, founded the Jesse Lewis Choose Love Foundation. A principle tenet of the foundation is the belief that teaching children how to effectively deal with anger is crucial to a healthy society. Ms. Lewis graduated from Boston University with a B.S. in Communications in 1990. Ms. Lewis is author of the book, *Nurturing Healing Love, A Mother's Journey of Hope &*

Forgiveness.

CLOSING LUNCHEON SPEAKER



Sarah Culberson was born in Morgantown, West Virginia to an African father and a white mother. As an infant, she was placed in foster care and adopted by a loving white family in West Virginia. She grew up contemplating and dealing with questions about her identity and her biracial roots. She fell in love with theatre in early childhood and later won an acting scholarship to attend West Virginia University. She earned her MFA at The American Conservatory Theatre in San Francisco and joined the Los Angeles acting community. Sarah has been acting on stage as well as in films and TV. However, her biggest role so far came when she decided to locate her biological parents. She is the co-founder and president of Kposowa Foundation and Director of Service-Learning at Oakwood School in Los Angeles. Ms. Culberson's book, *A Princess Found*, is co-authored with T. Trivas.

FIELD EDUCATION SYMPOSIUM SPEAKER



Rita B. Range, MSW, LCSW is a Social Work Supervisor and Field Coordinator with the Veterans Administration Medical Center in Memphis Tennessee. She also manages Community Programs. Ms. Range received her Bachelor in Social Work from Talladega College, Master in Counseling from the University of Alabama at Birmingham, and Master of Social Work from the University of Alabama. She also received a Leadership Certification from Ohio Christian University.

SPECIAL YOUTH EMPOWERMENT SESSION SPEAKER



Fredrick Burns is an undergraduate computer engineering student at Jackson State University and the principal in The Fred Burns Quest Program. Mr. Burns has participated in the C-Spire Software Developer Internship Program and several leadership programs including the California Leadership Program. He was the recipient of the top leadership award with the J.C. and Frankie Watts Leadership Academy in Washington, DC. Mr. Burns is a former foster youth and a motivational speaker for youth in the system of care.

**TWELFTH ANNUAL
MISSISSIPPI CHILD WELFARE INSTITUTE CONFERENCE**

*“Child Welfare: Building Multi-Generational Teams to Serve Families and
Communities”*

Conference Overview

Wednesday, February 12, 2014

5:30 p.m.–6:30 p.m.

Special Youth Empowerment Session

Thursday, February 13, 2014

7:00 a.m.–8:30 a.m.

Registration

8:30 a.m.–9:45 a.m.

Opening Plenary Session

9:45 a.m.–10:00 a.m.

Break

10:00 a.m.–11:30 a.m.

Concurrent Sessions

11:30 a.m.–1:00 p.m.

Lunch on Your Own

1:00 p.m.–2:00 p.m.

Plenary Session

2:05 p.m.–3:05 p.m.

Concurrent Sessions

3:05 p.m.–3:20 p.m.

Break

3:20 p.m.–4:20 p.m.

Plenary Session

4:30 p.m.–5:30 p.m.

Concurrent Sessions

Friday, February 14, 2014

8:20 a.m.–9:15 a.m.

Plenary Session

9:20 a.m.–10:20 a.m.

Concurrent Sessions

10:25 a.m.–10:40 a.m.

Break

10:45 a.m.–12:00 noon

Concurrent Workshops

12:15 p.m.–1:45 p.m.

Closing Luncheon

**TWELFTH ANNUAL
MISSISSIPPI CHILD WELFARE INSTITUTE CONFERENCE**

***“Child Welfare: Building Multi-Generational Teams to Serve Families and
Communities”***

Wednesday, February 13, 2014

SPECIAL YOUTH EMPOWERMENT SESSION

**Location: Windsor II
5:30 p.m. - 6:30 p.m.**

Presider	Mario Johnson , Director Independent Living Division of Family and Children’s Services Mississippi Department of Human Services Jackson, MS
Welcome	Amber Blackshear Master of Social Work Student Jackson State University
	It’s All about Timing
Speaker	Frederick Burns Computer Engineering Student College of Science, Engineering and Technology Jackson State University
Entertainment	Jim Hill Concert Choir James Hawkins, Choir Director Jackson, MS
Closing Remarks	Gwendolyn Spencer Prater, PhD Dean Emerita and Consultant School of Social Work College of Public Service Jackson State University

**Youth Reception
6:30 p.m. - 7:00 p.m.**

**TWELFTH ANNUAL
MISSISSIPPI CHILD WELFARE INSTITUTE CONFERENCE**

***“Child Welfare: Building Multi-Generational Teams to Serve Families and
Communities”***

Thursday, February 13, 2014

Conference Registration

7:00 a.m. - 5:30 p.m.

Exhibits

8:00 a.m. - 5:30 p.m.

OPENING PLENARY SESSION

Location: Windsor III, IV, and V

8:30 a.m. - 9:45 a.m.

Presider

Leon W. Chestang, PhD

Executive Director and Professor
School of Social Work
College of Public Service
Jackson State University

Greetings

Carolyn W. Myers, PhD

President
Jackson State University

Ricardo A. Brown, PhD

Dean
College of Public Service
Jackson State University

Safiya Omari, PhD

Chief of Staff
Mayor’s Office - City of Jackson

Introduction of Guest Speaker

Kim Shackelford, PhD, MSW

Deputy Administrator
Family and Children’s Services
Mississippi Department of Human Services

**Evidence-Informed Practice in Child Welfare:
What does the Evidence Say about the Use of
Evidence?**

Speaker

Crystal Collins-Camargo, PhD, MSW

Associate Professor
Kent School of Social Work
University of Louisville
Louisville, KY

**TWELFTH ANNUAL
MISSISSIPPI CHILD WELFARE INSTITUTE CONFERENCE**

***“Child Welfare: Building Multi-Generational Teams to Serve Families and
Communities”***

Thursday, February 13, 2014

OPENING PLENARY SESSION (Continued)

Remarks **Leon W. Chestang, PhD**

Presentation **Theresia Johnson-Ratliff, PhD**
Interim Director
Mississippi Child Welfare Institute
School of Social Work
College of Public Service
Jackson State University

9:45 a.m. – 10:00 a.m. **BREAK**

10:00 a.m. – 11:30 a.m. **CONCURRENT SESSIONS**

Session I Frontline Supervisors and Managers as Facilitators of Evidence-Informed Practice:
Strategies and Tools

Room: Surrey

In this workshop, participants will explore the roles of managers and frontline supervisors in promoting evidence-informed practice. The presenter will describe organizational and supervisory strategies and tools to promote the use of data to improve practice and promote positive outcomes in child welfare.

*Presenter: Crystal Collins-Camargo, PhD, MSW
Associate Professor
University of Louisville
Louisville, KY*

*Moderator: Velma Hankins, MSW, LCSW
Social Work Consultant
Jackson, MS*

**TWELFTH ANNUAL
MISSISSIPPI CHILD WELFARE INSTITUTE CONFERENCE**

***“Child Welfare: Building Multi-Generational Teams to Serve Families and
Communities”***

Thursday, February 13, 2014

10:00 a.m. – 11:30 a.m.

CONCURRENT SESSIONS

Session II **Board of Examiners’ Update: News You Can Use!**

Room: Churchill II

Participants will become familiar with the tasks of board members, understand BOE rules, regulations, and current changes. In addition, presenters will discuss the need for regulatory measures, learn about the complaint process, and give ethics and moral case examples.

Presenters: Billy Dilworth, Executive Director

*Gloria Green, Special Assistant to Attorney General/Board Attorney
Mississippi Board of Examiners for Social Workers and Marriage and
Family Therapists
Jackson, MS*

*Moderator: Bernice McKenny, MSW, LMSW
Director, Mississippi Counseling Center
Jackson, MS*

Session III **An Intergenerational Perspective of the Challenges of Raising Relatives’ Children**

Room: Churchill I

The presenter will provide information on how an intergenerational team works with families who are raising their relative’s children with limited resources. A working definition of kinship care in Mississippi and identification of service gaps for this population of caregivers will also be discussed.

*Presenter: Linda West, MSW, LCSW
Executive Director
Mississippi Families for Kids
Jackson, MS*

*Moderator: Bridgette Harris
Social Work Doctoral Student
Jackson State University*

**TWELFTH ANNUAL
MISSISSIPPI CHILD WELFARE INSTITUTE CONFERENCE**

***“Child Welfare: Building Multi-Generational Teams to Serve Families and
Communities”***

Thursday, February 13, 2014

10:00 a.m. – 11:30 a.m.

CONCURRENT SESSIONS

Session IV **Healthcare Access for Children and Families in Mississippi: Where Does Social Work Fit?**

Room: Winston

The presenters will discuss a collaborative partnership planning grant that was awarded to address healthcare for children and families. Participants will be provided information on how to design similar programs to improve child well-being through increased access to medical and behavioral healthcare.

*Presenters: Alexandria Camp
Master of Social Work Student/Graduate Assistant
University of Southern Mississippi
Hattiesburg, MS*

*Brittany Bayless
Master of Social Work Student/Graduate Assistant
University of Southern Mississippi*

*Laura Richard, Ph.D.
Assistant Professor
School of Social Work
University of Southern Mississippi*

*Moderator: Temcula Robinson
Program Manager, Independent Living
Division of Family and Children’s Services
Mississippi Department of Human Services
Jackson, MS*

**TWELFTH ANNUAL
MISSISSIPPI CHILD WELFARE INSTITUTE CONFERENCE**

***“Child Welfare: Building Multi-Generational Teams to Serve Families and
Communities”***

Thursday, February 13, 2014

10:00 a.m. – 11:30 a.m.

CONCURRENT SESSIONS

Session IV (Continued) **What is the Effectiveness of Evidence-Based Obesity Prevention Programs Implemented in Schools with African American Children Compared to the General Population of Children? Findings from a Systematic Review of the Research Literature**

The presenter will identify numerous roles for the profession of social work in shaping obesity prevention programs (or interventions), examine current challenges in measuring effectiveness of school-based obesity prevention programs (or interventions), and assess cultural norms and values that must be considered when implementing effective obesity prevention programs (or interventions).

*Presenter: Tracey Barnett, MSW, LGSW
Doctoral Student and Council on Social Work Education Minority Fellow
School of Social Work
The University of Texas-Arlington*

*Moderator: Temcula Robinson, MSW
Program Manager, Independent Living
Division of Family and Children’s Services
Mississippi Department of Human Services
Jackson, MS*

Session V **Child Development in the Context of Immigration: New Directions to Child Welfare Issues**

Room: Canterbury

The presentation will include a review of the literature regarding child maltreatment, mental illness, and substance use/abuse. The presenters will also share their practice experiences and interconnected variables which may affect children and families.

*Presenters: Gauri Bhattacharya, DSW, LCSW, ACSW
Professor
School of Social Work
Jackson State University*

*Sara Kauffman, LMSW
Director
Houston Area for Refugee Services of Texas
Houston, TX*

*Moderator: Candace Carter
Social Work Doctoral Student
Jackson State University*

**TWELFTH ANNUAL
MISSISSIPPI CHILD WELFARE INSTITUTE CONFERENCE**

***“Child Welfare: Building Multi-Generational Teams to Serve Families and
Communities”***

Thursday, February 13, 2014

10:00 a.m. – 11:30 a.m.

CONCURRENT SESSIONS

Session V **Providing Mental Health Services to Children in Rural Areas**

Continued ***Room: Canterbury***

Recent studies suggest that children in rural areas have a higher incidence of mental health issues than those who reside in urban areas. This presentation will provide recent data on children living in rural areas and their mental health needs. The presenter will also facilitate a discussion on issues identified in the field.

*Presenter: Shonda Lawrence, PhD
Interim Program Director
Bachelor of Social Work Program
Jackson State University*

*Moderator: Candace Carter
Ph.D. Social Work Student
Jackson State University*

Session VI **Child Sexual Abuse: Did You Know...**

Room: Newbury

This presentation will highlight new legislation that was passed in Mississippi, “Erin’s Law,” which will require school districts to provide an age appropriate sexual abuse curriculum to K-5 students. The presenter will also discuss professional and political implications regarding child sexual abuse education.

*Presenter: Regina Lacking
Unit Director
Oak Circle Center
Mississippi State Hospital
Master of Social Work Student
Jackson State University*

*Moderator: Terria Brooks-Green
Master of Social Work Student
Jackson State University*

**TWELFTH ANNUAL
MISSISSIPPI CHILD WELFARE INSTITUTE CONFERENCE**

***“Child Welfare: Building Multi-Generational Teams to Serve Families and
Communities”***

Thursday, February 13, 2014

10:00 a.m. – 11:30 a.m.

CONCURRENT SESSIONS

Session VI **Grief and Loss: A Family Affair**
(Continued)

Room: Newbury

The journey of grief is individual, personal and unique. The presenter will discuss causes and common facts of grief and loss, identify symptoms and emotions that accompany grieving, and elaborate on family therapeutic approaches.

*Presenter: Mark Roth
 Staff Chaplain
 Mississippi Baptist Health Systems
 Master of Social Work Student
 Jackson State University*

**TWELFTH ANNUAL
MISSISSIPPI CHILD WELFARE INSTITUTE CONFERENCE**

***“Child Welfare: Building Multi-Generational Teams to Serve Families and
Communities”***

Thursday, February 13, 2014

11:30 a.m. – 1:00 p.m.

LUNCH (on your own)

PLENARY SESSION

1:00 p.m. – 2:00 p.m.

Location: Windsor III, IV, and V

Presider

Mario Johnson, MS
Director
Independent Living
Division of Family and Children’s Services

Introduction of Speaker

Olga Osby, PhD
Interim Director
SMHART Institute
School of Social Work
College of Public Service
Jackson State University

***Family Matters: The Role of Mental Health Stigma
and Social Support on Depressive Symptoms and
Subsequent Help Seeking Among African American
Boys***

Speaker
Diversity

Michael A. Lindsey, PhD, MSW, MPH
Associate Professor
Silver School of Social Work
New York University

Remarks

Mario Johnson

Presentation

Susie A. Spence, PhD
Director, PhD Program
School of Social Work
Jackson State University

**TWELFTH ANNUAL
MISSISSIPPI CHILD WELFARE INSTITUTE CONFERENCE**

***“Child Welfare: Building Multi-Generational Teams to Serve Families and
Communities”***

Thursday, February 13, 2014

2:05 p.m. – 3:05 p.m.

CONCURRENT SESSIONS

Session VII *Stewards of Children: An Effective Child Prevention Workshop? (Part I)*

Room: Churchill I

Participants will gain increased awareness of the prevalence, consequences and circumstances of child sexual abuse; gain new skills to prevent, recognize and react responsibly to child sexual abuse; and be provided information to develop an individual commitment to action via a personal prevention plan.

*Presenter: Jeanette Ramirez
 Bachelor of Social Work Student
 College of Mount St. Joseph
 Cincinnati, OH*

*Moderator: Alex Blanche
 Bachelor of Social Work Student
 Jackson State University*

Session VIII *Healing the Broken Heart*

Room: Winston

Participants will receive valuable information to understand the nature and effects of heartbreak and learn techniques to intervene in cases involving heartbreak.

*Presenter: Leon W. Chestang, PhD
 Executive Director and Professor
 School of Social Work
 Jackson State University*

*Moderator: Michael LaBorde
 Bachelor of Social Work Student
 Jackson State University*

**TWELFTH ANNUAL
MISSISSIPPI CHILD WELFARE INSTITUTE CONFERENCE**

***“Child Welfare: Building Multi-Generational Teams to Serve Families and
Communities”***

Thursday, February 13, 2014

2:05 p.m. – 3:05 p.m.

CONCURRENT SESSIONS

Session IX **Board of Examiners’ Update: News You Can Use!**

Room: Churchill II

Participants will become familiar with board members tasks, and understand BOE rules, regulations, and current changes. In addition, presenters will discuss the need for regulatory measures, learn the complaint process, and give examples of ethics and moral cases.

*Presenters: Billy Dilworth, Executive Director
Mississippi Board of Examiners for Social Workers and Marriage and
Family Therapists
Jackson, MS*

*Gloria Green, Special Assistant to Attorney General/Board Attorney
Mississippi Board of Examiners for Social Workers and Marriage and
Family Therapists*

*Moderator: Jaworski Davenport, LMSW
CQI Data Analyst
and Social Work Doctoral Student
Jackson State University*

Session X **Crisis Prevention Resource Project: Suicide Prevention Question, Persuade, Refer**

Room: Newbury

The presenter discusses a partnership that provided training to identify and refer students who are at high risk for suicide. Participants will be able to recognize individuals who are at risk, receive information on intervention skills, and be provided with referral resources.

*Presenter: Melinda Todd, MPH, MCHES, CPM, ICPS
Program Coordinator
Crisis Prevention Resource Suicide Prevention Project
and Doctoral Student in Public Health
Jackson State University*

*Moderator: Regenia Johnson
Master of Social Work Student
Jackson State University*

**TWELFTH ANNUAL
MISSISSIPPI CHILD WELFARE INSTITUTE CONFERENCE**

***“Child Welfare: Building Multi-Generational Teams to Serve Families and
Communities”***

Thursday, February 13, 2014

2:05 p.m. – 3:05 p.m.

CONCURRENT SESSIONS

**Session XI **Asset-Based Implementation to Address Disparities and Disproportionalities in
Diversity Services and Behavioral Health Care****

Room: Surrey

Presenters will discuss how to create a Behavioral Health Disparities Impact Statement (a new federal requirement for grantees of the Substance Abuse and Mental Health Services Administration -SAMHSA) and use it as a service planning tool. Participants will gain practical examples of structural changes and ways for systems of care to integrate services to address the needs of their populations.

*Presenters: Peter Gamache, Ph.D., MBA, MLA, MPH, RN
Program Evaluator and Grant Writer
System of Care and Wraparound Initiatives
New Orleans, LA*

*Sandra Parks, MCP, CMHT
Director, Division of Children and Youth Services
NFusion Mississippi Transitional Outreach Program
Mississippi Department of Mental Health
Jackson, MS*

*Jackie Chatmon, MA, CMHT, CACD II
Program Director
NFusion Mississippi Transitional Outreach Program
Mississippi Department of Mental Health*

*Moderator: Shantá Webb
Bachelor of Social Work Student
Jackson State University*

3:05 p.m. – 3:20 p.m.

BREAK

**TWELFTH ANNUAL
MISSISSIPPI CHILD WELFARE INSTITUTE CONFERENCE**

***“Child Welfare: Building Multi-Generational Teams to Serve Families and
Communities”***

Thursday, February 13, 2014

PLENARY SESSION

3:20 p.m. – 4:20 p.m.

Location: Windsor III, IV, V

Presider	Tasha Smith, MA Mississippi Department of Human Services Prevention Unit Social Work Doctoral Student Jackson State University
Introduction of Speaker	Gwendolyn Spencer Prater, PhD, MSW, LCSW
	Now is the Time: Supporting Resilient Children, Strong Families, and Healthy Communities
Speaker	Paolo del Vecchio, MSW Director, Substance Abuse and Mental Health Services Administration’s (SAMHSA) Center for Mental Health Services (CMHS) U.S. Department of Health and Human Services
Remarks	Albertstein Johnson-Pickett, M.Ed. Mississippi Department of Mental Health
Presentation	Theresa Johnson-Ratliff, PhD, MSW, LCSW
4:30 p.m. – 5:30 p.m.	CONCURRENT SESSIONS

**TWELFTH ANNUAL
MISSISSIPPI CHILD WELFARE INSTITUTE CONFERENCE**

***“Child Welfare: Building Multi-Generational Teams to Serve Families and
Communities”***

Thursday, February 13, 2014

4:30 p.m. – 5:30 p.m.

CONCURRENT SESSIONS

Session XII **Stewards of Children: An Effective Child Prevention Workshop? (Part II)**

Room: Churchill I

Participants will gain increased awareness of the prevalence, consequences and circumstances of child sexual abuse; gain new skills to prevent, recognize and react responsibly to child sexual abuse; and be provided information to develop an individual commitment to action via a personal prevention plan.

*Presenter: Jeanette Ramirez
 Bachelor of Social Work Student
 College of Mount St. Joseph
 Cincinnati, OH*

*Moderator: Racquel Barrett
 Master of Social Work Student
 Jackson State University*

Session XIII **The Importance of Collaboration in a Trauma Informed System of Care**

Room: Winston

It is imperative that service providers coordinate efforts to meet the needs of our children and families and provide trauma informed approaches. The presenter will provide an overview of the importance of collaboration between agencies to integrate services to address the needs of their populations and reduce critical gaps between and within practice/service settings.

*Presenter: Jackie Chatmon, M.A., CMHT, CADC II
 Program Administrator IV and Project Director
 System of Care Initiatives, Mississippi Transitional Outreach Project
 Mississippi Department of Mental Health
 Jackson, MS*

*Moderator: Stephanie Magee
 Master of Social Work Student
 Jackson State University*

**TWELFTH ANNUAL
MISSISSIPPI CHILD WELFARE INSTITUTE CONFERENCE**

***“Child Welfare: Building Multi-Generational Teams to Serve Families and
Communities”***

Thursday, February 13, 2014

4:30 p.m. – 5:30 p.m.

CONCURRENT SESSIONS

**Session XIV Disability Etiquette in a Modern World
Diversity**

Room: Manchester

Current disability etiquette best practices will be reviewed. The presenter will provide interactive disability skits with individuals with and without disabilities and share personal stories of the nonuse of disability etiquette exhibited by professionals.

*Presenters: Jerry Alliston, Ph.D., MSW
Coordinator, Community Inclusion and Volunteer Service and Employment
Institute for Disability Studies
University of Southern Mississippi
Hattiesburg, MS*

*Jacqueline Washington
Parent/Family Liaison for Mississippi Family Voices
Family-to-Family Health and Information Center
Institute for Disability Studies
University of Southern Mississippi*

*Moderator: Valerie Carson, LMSW
Social Work Doctoral Student
Jackson State University*

Session XV Brain, Trauma and Behavior

Room: Surrey

Trauma affects the brain and has a profound impact on the function of an individual. Through discussion, participants will gain a greater understanding of the connection between trauma and behavior as well as be able to identify components of the cognitive triangle and how they influence each other.

*Presenter: Willie Garrison, MS
Clinical Coordinator/Training and Technical Assistant
Mississippi Transitional Outreach Project and NFusion
Mississippi Department of Mental Health
Jackson, MS*

*Moderator: Amber Blackshear
Master of Social Work Student
Jackson State University*

**TWELFTH ANNUAL
MISSISSIPPI CHILD WELFARE INSTITUTE CONFERENCE**

***“Child Welfare: Building Multi-Generational Teams to Serve Families and
Communities”***

Thursday, February 13, 2014

4:30 p.m. – 5:30 p.m.

CONCURRENT SESSIONS

Session XVI **The Art of “Caring for others” while “Caring for self”**

Room: Canterbury

The presenters discuss elements that erode healthy boundaries in family and close relationships, ways to develop limits when dealing with family/kinship relationships, and strategies that promote protection of the self when involved in a “caring for” relationship.

*Presenters: Mary Langford-Hall, PhD, CCC-SLP
Assistant Professor
Communicative Disorders
College of Public Service
Jackson State University*

*Betty Sutton, EdD, CCC-SLP
Assistant Professor
Communicative Disorders
Jackson State University*

*Moderator: Phyllis Southern
Master of Social Work Student
Jackson State University*

**TWELFTH ANNUAL
MISSISSIPPI CHILD WELFARE INSTITUTE CONFERENCE**

***“Child Welfare: Building Multi-Generational Teams to Serve Families and
Communities”***

Thursday, February 13, 2014

Field Education Symposium

**4:30 p.m. – 5:30 p.m. Multi-Generational Relationships: Helping to Develop Future Social
Work Leaders**

Room: *Newbury*

Social work encompasses a variety of leadership opportunity relationships including community development, family connections, social issues, and policy perspectives. This workshop focuses on how multiple-generational guidance can help students and young social workers develop new and innovative practice skills. The objectives of this workshop are to help participants understand the role of leadership in social work, to identify five components of helping social work student interns and young social workers reach their highest potential, and to provide six tools that assist in producing new social work leaders.

*Presenter: Rita Range, MSW, LCSW
Social Work Supervisor and Field Coordinator
Veterans Administration Medical Center
Memphis, TN*

*Moderator: Jessie Chiplin Wright
Private Practitioner
Jackson, MS*

**TWELFTH ANNUAL
MISSISSIPPI CHILD WELFARE INSTITUTE CONFERENCE**

*“Child Welfare: Building Multi-Generational Teams to Serve Families and
Communities”*

Thursday, February 13, 2014

Sponsor and Networking Reception

6:00 P.M. - 8:00 P.M.
Windsor I and II

Greetings	Anna Marshall, PhD, MSW, LCSW
Welcome	Theresa Johnson-Ratliff, PhD
Recognition of Guests	Gwendolyn Spencer Prater, PhD
Invocation	Leon W. Chestang, PhD
Remarks	Ricardo A. Brown, PhD Dean College of Public Service

**TWELFTH ANNUAL
MISSISSIPPI CHILD WELFARE INSTITUTE CONFERENCE**

***“Child Welfare: Building Multi-Generational Teams to Serve Families and
Communities”***

Friday, February 14, 2014

PLENARY SESSION

8:20 a.m. – 9:15 a.m.

Location: Windsor III, IV, and V

Presider

Leon W. Chestang, PhD
Executive Director and Professor
School of Social Work
College of Public Service
Jackson State University

Introduction of Guest Speaker

Gwendolyn Spencer Prater, PhD
Dean Emerita and Consultant
School of Social Work
College of Public Service
Jackson State University

Nurturing Healing Love

Speaker

Scarlett Lewis
Author and Founder
Jesse Lewis Choose Love Foundation
Sandy Hook, Connecticut

Presentation

Leon W. Chestang, PhD

Theresia Johnson-Ratliff, PhD, MSW, LCSW

**TWELFTH ANNUAL
MISSISSIPPI CHILD WELFARE INSTITUTE CONFERENCE**

***“Child Welfare: Building Multi-Generational Teams to Serve Families and
Communities”***

Friday, February 14, 2014

9:20 a.m. – 10:20 a.m.

CONCURRENT SESSIONS

**Session XVII Cultural Competency: Involving Families and Youth in Embedding Cultural and Linguistic
Diversity Practices in Program**

Room: Surrey

The nation’s demographics are changing and programs must reflect the cultural and linguistic needs of the population that require services. The presenters offer a snapshot of cultural competence from a practitioner’s standpoint and provide information on evaluation of services by youth and families driving the program to implement culturally and linguistically appropriate services and supports.

*Presenters: Albertstein Johnson-Pickett, M.Ed.
 Division Director II/Cultural and Linguistic Competence Coordinator
 Mississippi Department of Mental Health
 Jackson, MS*

*Alandre Jones
NFusion 7 Youth and
President of Cultural and Linguistic Competence Subcommittee
Mississippi Department of Mental Health*

*Moderator: Tracye Ballard, LMSW
 Social Work Doctoral Student
 Jackson State University*

**Session XVIII Reality Therapy: Influencing Healthy Behaviors in Children
Ethics**

Room: Briarwood

The presenter offers suggestions from a practitioner’s perspective of how reality therapy can be used to combat psychological problems. Participants will gain knowledge on creating a quality life based on healthy behavior, ethical practice, how to make a plan, and integration of the plan that will assist children in moving toward healthy behaviors.

*Presenter: Bernice McKenny, LMSW
 Director
 Mississippi Counseling Center
 Jackson, MS*

*Moderator: Karla Banks
 Bachelor of Social Work Student
 Jackson State University*

**TWELFTH ANNUAL
MISSISSIPPI CHILD WELFARE INSTITUTE CONFERENCE**

***“Child Welfare: Building Multi-Generational Teams to Serve Families and
Communities”***

Friday, February 14, 2014

9:20 a.m. – 10:20 a.m.

CONCURRENT SESSIONS

Session XIX **Eldercare for Rural African Americans: A Conceptual Framework for Exploring Factors Influencing Family Support**

Room: Newbury

This paper provides an overview of the literature regarding eldercare and presents a proposed conceptual framework for exploring factors influencing family support for rural elderly African Americans. The implications of employing the framework will also be discussed.

Presenters: *Susie A. Spence, PhD*
Director, PhD Program
School of Social Work
Jackson State University

Corvell Coburn
Social Work Doctoral Student
Jackson State University

Moderator: *Demarius Tolliver*
Bachelor of Social Work Student
Jackson State University

Session XX **The Role of Social Workers in Work with Dysfunctional Families**

Room: Canterbury

The presentation will consist of discussions of likely reasons for dysfunction in families, critically analyze the reasons for dysfunction, and provide information on how social workers may assist families in developing more effective methods of shared leadership.

Presenter: *Maritza Johnson*
Bachelor of Social Work Student
Mississippi Valley State University
Itta Bena, MS

Moderator: *Joshua Alexander*
Bachelor of Social Work Student
Jackson State University

**TWELFTH ANNUAL
MISSISSIPPI CHILD WELFARE INSTITUTE CONFERENCE**

***“Child Welfare: Building Multi-Generational Teams to Serve Families and
Communities”***

Friday, February 14, 2014

9:20 a.m. – 10:20 a.m.

CONCURRENT SESSIONS

Session XXI **Licensed Certified Social Workers’ Supervisory Update (Part I – session open only to
Supervision LCSWs)**

Room: Surrey

The presenter will incorporate updates, proposed changes, and the intent of the Mississippi Board of Examiners Rules and Regulations. Ethical principles set forth in the NASW Code of Ethics will be discussed. Resources in the form of technological and published information to enhance and support the supervisory experience will also be shared.

*Presenter: Virginia Adolph, MSW, LCSW
 Special Education Social Worker
 Harrison County School System
 Gulfport, MS*

*Moderator: Eva Bowie Ellis, MSW, LCSW
 Social Work Consultant
 Jackson, MS*

Session XXII **Intergenerational Finances: Protecting our Children and Families**

Room: Windsor II

This presentation will inform participants about legal and financial concerns often voiced by older adults and their families. It will also equip participants to address basic legal asset protection and incapacity planning concerns for older adults and their caregivers, including Medicaid.

*Presenter: Richard A. Courtney, Esq.
 Courtney Elder Law Associates
 Jackson, MS*

*Moderator: Laura Brown, Esq.
 Master of Social Work Student
 Jackson State University*

10:25 a.m. – 10:40 a.m.

BREAK

**TWELFTH ANNUAL
MISSISSIPPI CHILD WELFARE INSTITUTE CONFERENCE**

***“Child Welfare: Building Multi-Generational Teams to Serve Families and
Communities”***

Friday, February 14, 2014

10:45 a.m. – 12:00 noon

CONCURRENT SESSIONS

Session XXIII **Licensed Certified Social Workers’ Supervisory Update (Part II – session open only to LCSWs
Supervision who attended Part I)**

Room: Surrey

The presenter will incorporate updates, proposed changes, and the intent of the Mississippi Board of Examiners Rules and Regulations. Ethical principles set forth in the NASW Code of Ethics will be discussed. Resources in the form of technological and published information to enhance and support the supervisory experience will also be shared.

*Presenter: Virginia Adolph, MSW, LCSW
Special Education Social Worker
Harrison County School System
Gulfport, MS*

*Moderator: Eva Bowie Ellis, MSW, LCSW
Social Work Consultant
Jackson, MS*

Session XXIV **Cultural Competency and Diversity in the Delivery of Child Welfare Services
Diversity**

Room: Briarwood

The presenters will present a historical overview of child welfare services, examine a cultural competency model that can be considered in the delivery of services, and discuss case studies that will demonstrate the need for culturally competent workers.

*Presenters: Rejoice Addae, PhD, LMSW
Assistant Professor
Department of Social Work
Arkansas State University - Jonesboro*

*Patricia Walls, PhD, LMSW
Assistant Professor
Department of Social Work
Arkansas State University - Jonesboro*

*Moderator: Tamara Pace
Social Work Doctoral Student
Jackson State University*

**TWELFTH ANNUAL
MISSISSIPPI CHILD WELFARE INSTITUTE CONFERENCE**

***“Child Welfare: Building Multi-Generational Teams to Serve Families and
Communities”***

Friday, February 14, 2014

10:45 a.m. – 12:00 noon

CONCURRENT SESSIONS

Session XXV **The Influence of Child Deaths on Child Welfare Policy in the U.S. and the U.K.**

Room: Manchester

A tragic murder of a child by her mother in the mid 1980s helped social workers in Mississippi to finally succeed in the passage of a social work licensure law. The presentation will include a video-taped documentary on child deaths followed by a discussion on political motivations and concern for the safety of children. Policies that may develop after the murder of children by parents or caregivers are also discussed.

*Presenter: Vincent Venturini, PhD, MSW, LCSW
Retired Faculty
Mississippi Valley State University
Itta Bena, MS*

*Moderator: TL Chandler
Social Work Doctoral Student
Jackson State University*

Session XXVI **A Fair Chance to Parent
Diversity**

Room: Newbury

The presenters will discuss current information and trends in the area of neurodevelopmental disabilities specifically when working with parents. The application of federal disability laws, adapted learning styles, and community and state resources and creative techniques will also be discussed.

*Presenters: Ashley Annstedt, LCSW
Clinical Social Worker
University of Tennessee Boling Center for Developmental Disabilities
Memphis, TN*

*Malissa Duckworth, LCSW
Clinical Social Worker
University of Tennessee Boling Center for Developmental Disabilities*

*Moderator: Linda Pendleton
Social Work Doctoral Student
Jackson State University*

**TWELFTH ANNUAL
MISSISSIPPI CHILD WELFARE INSTITUTE CONFERENCE**

***“Child Welfare: Building Multi-Generational Teams to Serve Families and
Communities”***

Friday, February 14, 2014

10:45 a.m. – 12:00 noon

CONCURRENT SESSIONS

Session XXVII Understanding Trauma: Utilizing a Trauma Informed Approach to Serve Families

Room: Winston

Trauma may cause a number of feelings which can have immediate and long-term physical and psychological health risks. The presentation will include a discussion on the different types of trauma; information on how to understand the relationship between a child’s lifetime trauma history and behaviors, and an overview of the elements of a trauma-informed child welfare system.

*Presenter: Benetra Mangum
Project Coordinator
Tennessee Network for Trauma-Informed and Evidence-Based Systems
University of Tennessee – Center of Excellence for Children in State Custody
Social Work Doctoral Student
Jackson State University*

Ethics

Are There Generational Differences on Attitudes Toward Adoption?

The presenter discusses findings of a paper that examined whether there are differences in adoption attitudes between two generations among graduate social work students and ethical implications.

*Presenter: Jaegoo Lee, PhD
Assistant Professor
School of Social Work
Jackson State University*

*Moderator: Jerrionna Doss
Master of Social Work Student
Jackson State University*

**TWELFTH ANNUAL
MISSISSIPPI CHILD WELFARE INSTITUTE CONFERENCE**

***“Child Welfare: Building Multi-Generational Teams to Serve Families and
Communities”***

Friday, February 14, 2014

10:45 a.m. – 12:00 noon

CONCURRENT SESSIONS

Session XXVIII **Mitigating Juvenile Capital Murder Cases**

Ethics

Room: Canterbury

The presenters discuss the history of mitigation, culpability of juvenile defendants, the difference between juvenile life without parole (JLWOP) and death mitigation investigations, and the manner to properly conduct an ethical JLWOP mitigation investigation.

*Presenters: Regina Curry, MSW, LMSW
Mitigation Specialist
Office of the Capital Defense
Jackson, MS*

*Marlena Lehew, MSW, LMSW
Mitigation Specialist
Office of the Capital Defense
Jackson, MS*

*Moderator: Andrew Campbell
Master of Social Work Student
Jackson State University*

**TWELFTH ANNUAL
MISSISSIPPI CHILD WELFARE INSTITUTE CONFERENCE**

***“Child Welfare: Building Multi-Generational Teams to Serve Families and
Communities”***

Friday, February 14, 2014

CLOSING LUNCHEON

Location: Windsor I & II

12:15 p.m. – 1:45 p.m.

Presider	Leon W. Chestang, PhD Executive Director School of Social Work College of Public Service Jackson State University
Greetings	James C. Renick, PhD Provost and Vice President for Academic Affairs
Invocation	Reverend Mark Williamson Winona Baptist Church Winona, MS
Introduction of Speaker	Fredrick Burns Undergraduate Student Computer Engineering College of Science, Engineering, and Technology Jackson State University Former Foster Youth
Speaker Diversity	Journey from West Virginia to West Africa Sarah Culberson Co-Founder and President Kposowa Foundation and Director, Service Learning Oakwood School Los Angeles, CA
Presentation of Awards	Leon W. Chestang, PhD Tasha Smith, MA Charles Araujo, MSW, LCSW
Closing Remarks	Gwendolyn Spencer Prater, PhD

**TWELFTH ANNUAL
MISSISSIPPI CHILD WELFARE INSTITUTE CONFERENCE**

***“Child Welfare: Building Multi-Generational Teams to Serve Families and
Communities”***

Exhibitors

George Miller, II (Child Advocacy Artist)

Harmony Court Assisted Living

**Jackson State University
*College of Public Service***

**Jackson State University
*School of Social Work***

**Mississippi Department of Health
*Early Intervention Program***

Mississippi Youth Challenge

Neighborhood Insurance

Southern Christian Services

Turnaround Achievement Network

Youth Villages

**TWELFTH ANNUAL
MISSISSIPPI CHILD WELFARE INSTITUTE CONFERENCE**

***“Child Welfare: Building Multi-Generational Teams to Serve Families and
Communities”***

Program Planning Committee

Dr. Leon W. Chestang – Ex-Officio – Jackson State University
Dr. Gwendolyn Spencer Prater – Dean Emerita- Jackson State University
Dr. Theresia Johnson-Ratliff – Jackson State University
Dr. Eunice M. Harris – Jackson State University
Dr. Anna Marshall – Jackson State University
Ms. Eugenia Cook – Jackson State University
Ms. Betty Reed – Jackson State University
Ms. Eunetta Hart – Jackson State University
Ms. Tasha Smith - Mississippi Department of Human Services
Division of Family and Children’s Services, Social Work Doctoral Student
Mr. Mario Johnson – Mississippi Department of Human Services
Division of Family and Children’s Services
Ms. Temcula Robinson - Mississippi Department of Human Services
Division of Family and Children’s Services
Ms. Albertstein Johnson-Pickett
Mississippi Department of Mental Health
Ms. Bernice McKenny – Mississippi Counseling Center
Ms. Velma Hankins – Social Work Consultant
Ms. Eva Bowie Ellis – Social Work Consultant
Mr. Charles Araujo – Social Work Consultant
Ms. Jessie Chiplin Wright – Private Practitioner
Ms. Candice Washington – Our Family Home Hospice
Dr. Jaegoo Lee – Jackson State University
Ms. Melinda Todd – Jackson State University
Ms. Lissette Riley – Jackson State University

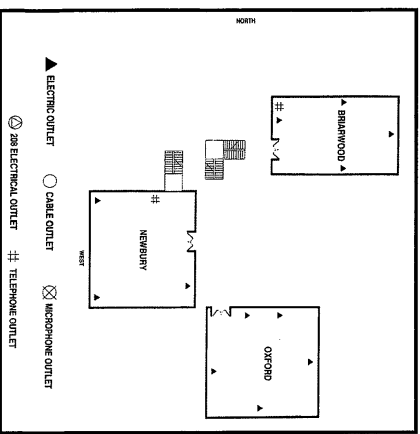
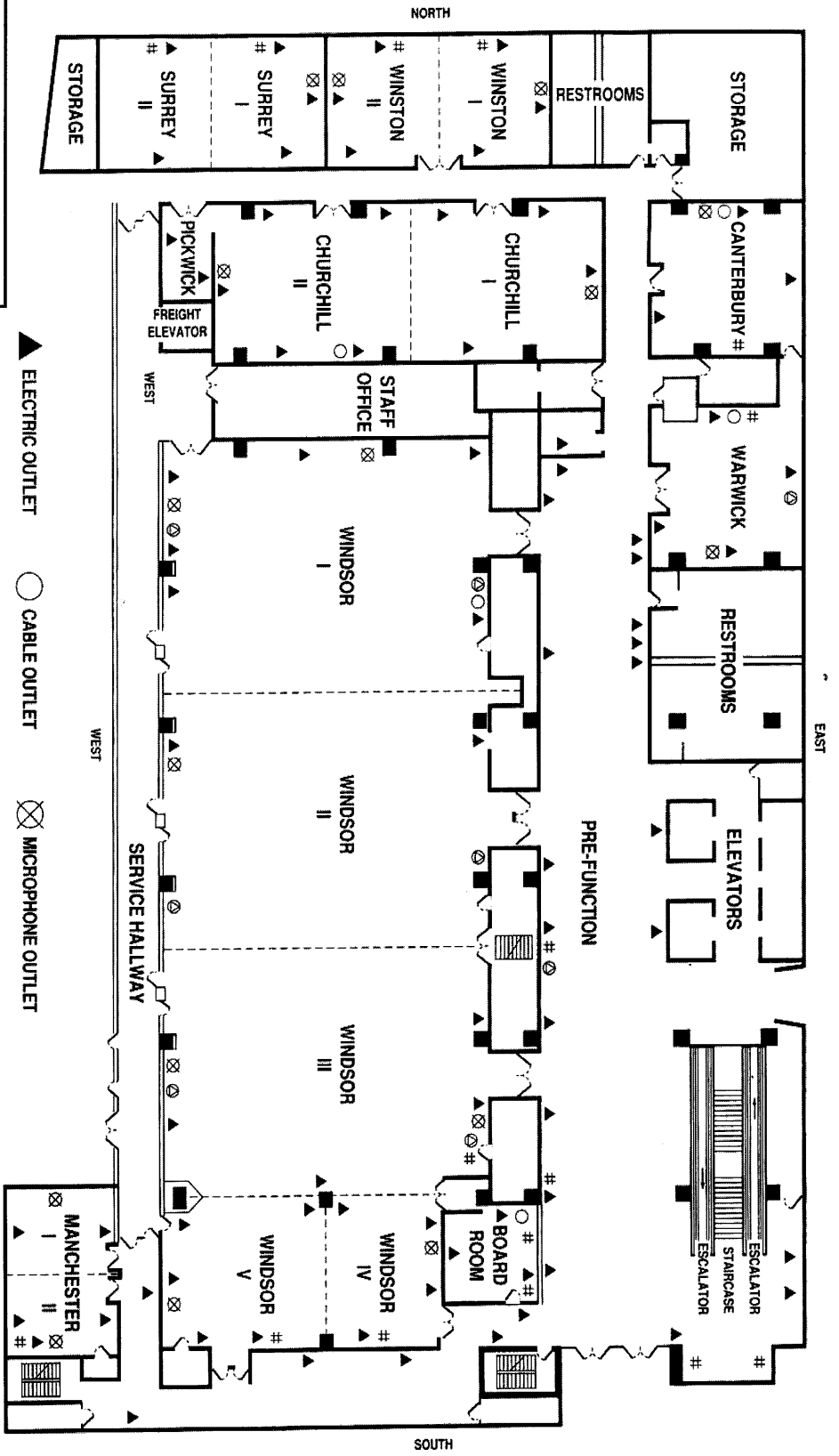

- ▲ ELECTRIC OUTLET
- CABLE OUTLET
- ⊗ MICROPHONE OUTLET
- ⊙ 208 ELECTRICAL OUTLET
- ⊞ TELEPHONE OUTLET

Marriott
JACKSON

200 E. Amite Street
 Jackson, MS 39201
 601-969-5100
www.marriott.com/janmc

Congratulations
to the
Mississippi Child Welfare Institute - School of Social Work
on its
TWELFTH ANNUAL CONFERENCE
“Child Welfare: Building Multi-Generational Teams to Serve Families and Communities”

College of Public Service

(601) 979.8836

www.cps.jsums.edu

Dr. Ricardo A. Brown, Dean

Mississippi Child Welfare Institute

(601) 979.1123

www.jsums.edu/mcwi

School of Health Sciences

(601) 979.8806

www.cps.jsums.edu

Communicative Disorders (601) 432.6717 – B.S. and M.S. Degrees

Epidemiology and Biostatistics (601) 979.8789 – M.P.H. & Dr.P.H. Degrees

Health Policy and Management (601) 979.8826 – M.P.H. & Dr.P.H. Degrees

and Health Care Administration – B.S. Degree

Behavioral and Environmental Health (601) 979.1143 – M.P.H. & Dr.P.H. Degrees

School of Policy and Planning

(601) 432.6865

www.cps.jsums.edu

Urban and Regional Planning (601) 432.6865 – M.A. & Ph.D. Degrees

Urban Studies (601) 432.6865 – B.A. Degree

Public Policy & Administration (601) 432.6368 – M.P.P.A. & Ph.D. Degrees

School of Social Work

(601) 432.6828

www.cps.jsums.edu

Social Work (601) 432.6811 – Ph.D. Degree

Social Work (601) 432.6819 – M.S.W. Degree

Social Work (601) 979.2631 – B.S.W. Degree

MARK YOUR CALENDAR



**Mississippi Child Welfare Institute
Conference**

February 18-20, 2015

**MARRIOTT HOTEL
JACKSON, MS**